

## ***APPENDIX G***

### ***Accident History Diagrams***

The following diagrams illustrate the accident history of the North College Avenue, Jefferson Street/Riverside Avenue and Mulberry Street corridors. The accident history represents information compiled from three sources: The City of Fort Collins, the Colorado Department of Transportation and the Colorado State Patrol for a 2-½ year period, January 1996 through July 1998.

I:\98092\Acad\Accident\88092900.dwg MON JAN 24 09:43:25 2000 MICHELLE HANSEN

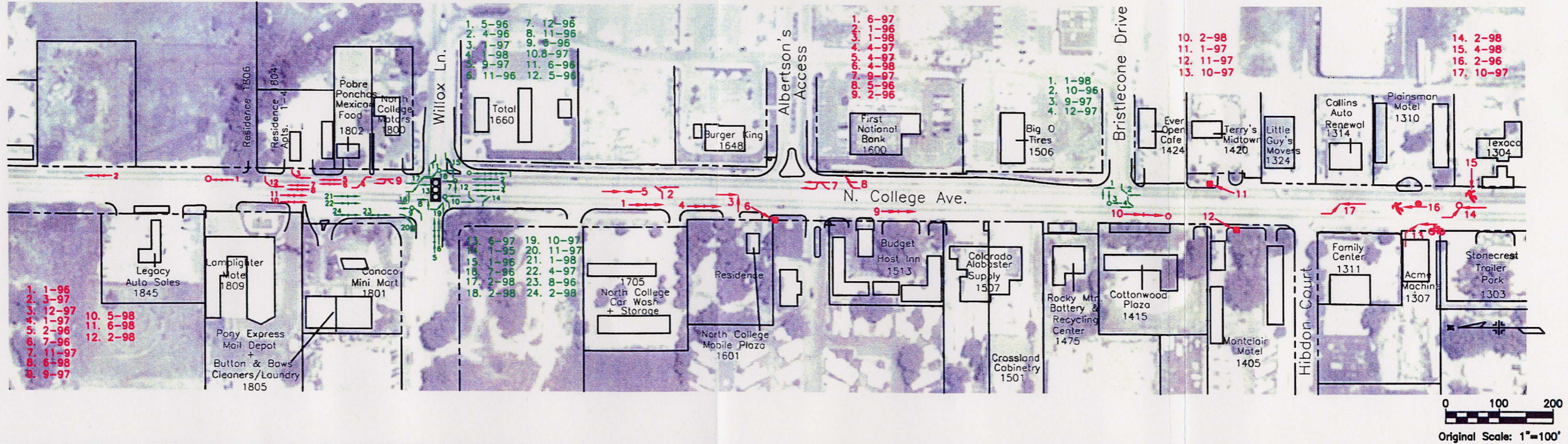
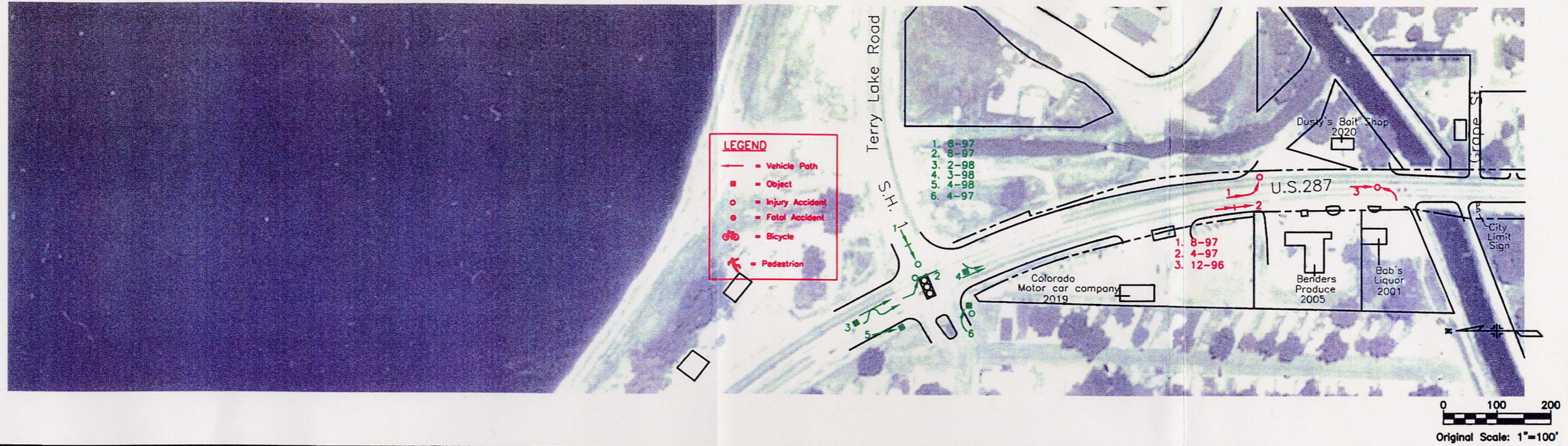

Computer File Information	
Creation Date:	10/23/98 Initials: SCD
Last Modification Date:	03/23/99 Initials: ZV
Full Path:	I:\98092\Acad\
Drawing File Name:	88092900.dwg
Acad Ver.	R14 Scale: 1"=100' Units: English

Index of Revisions	



As Constructed	ACCESS MANAGEMENT PLAN NORTH COLLEGE AVENUE	
No Revisions:	Designer:	Structure Numbers
Revised:	Detailer:	SCD
Void:	Sheet Subset:	Subset Sheets: C1 of 2

Project No./Code
X
X
Sheet Number

L:\B8092\ACAD\ACCIDENT\B8092901.DWG MON JAN 24 09:44:21 2000 MICHELLE DANIEL

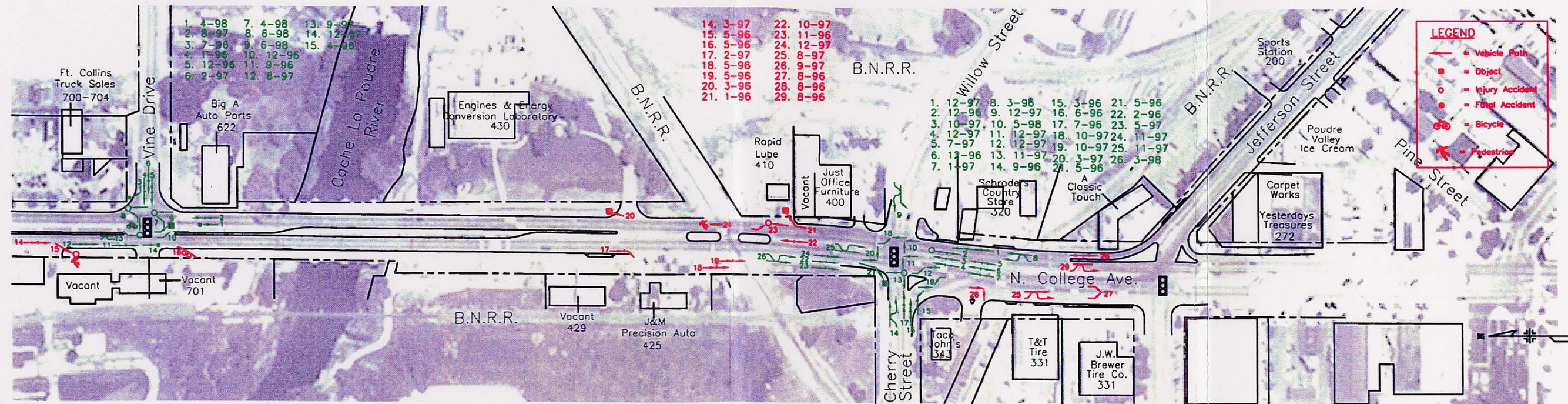
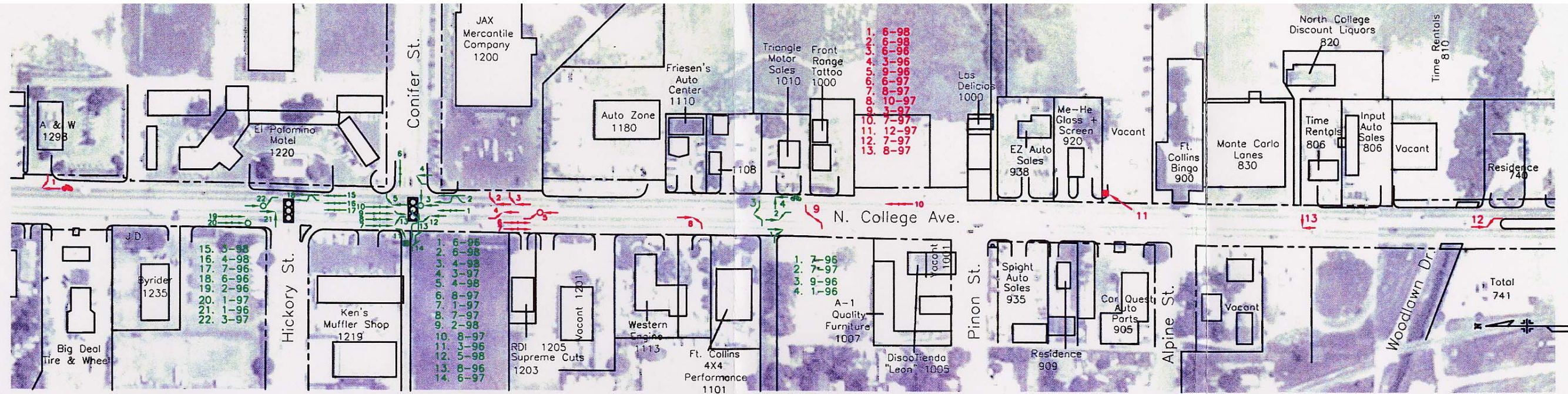

Computer File Information	
Creation Date:	10/23/98 Initials: SCD
Last Modification Date:	03/23/99 Initials: ZV
Full Path:	I:\98092\Acad\
Drawing File Name:	B8092901.dwg
Acad Ver.	R14 Scale: 1"=100' Units: English

Index of Revisions	

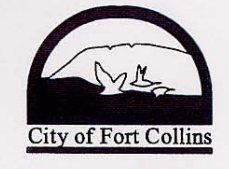

As Constructed		ACCESS MANAGEMENT PLAN NORTH COLLEGE AVENUE	
No Revisions:		Designer:	
Revised:		Detailer:	SCD
Void:		Sheet Subet:	
		Subet Sheets:	C2 of 2

Project No./Code
X
X
Sheet Number