

# Southeast Community Park

# Fort Collins Community Parks

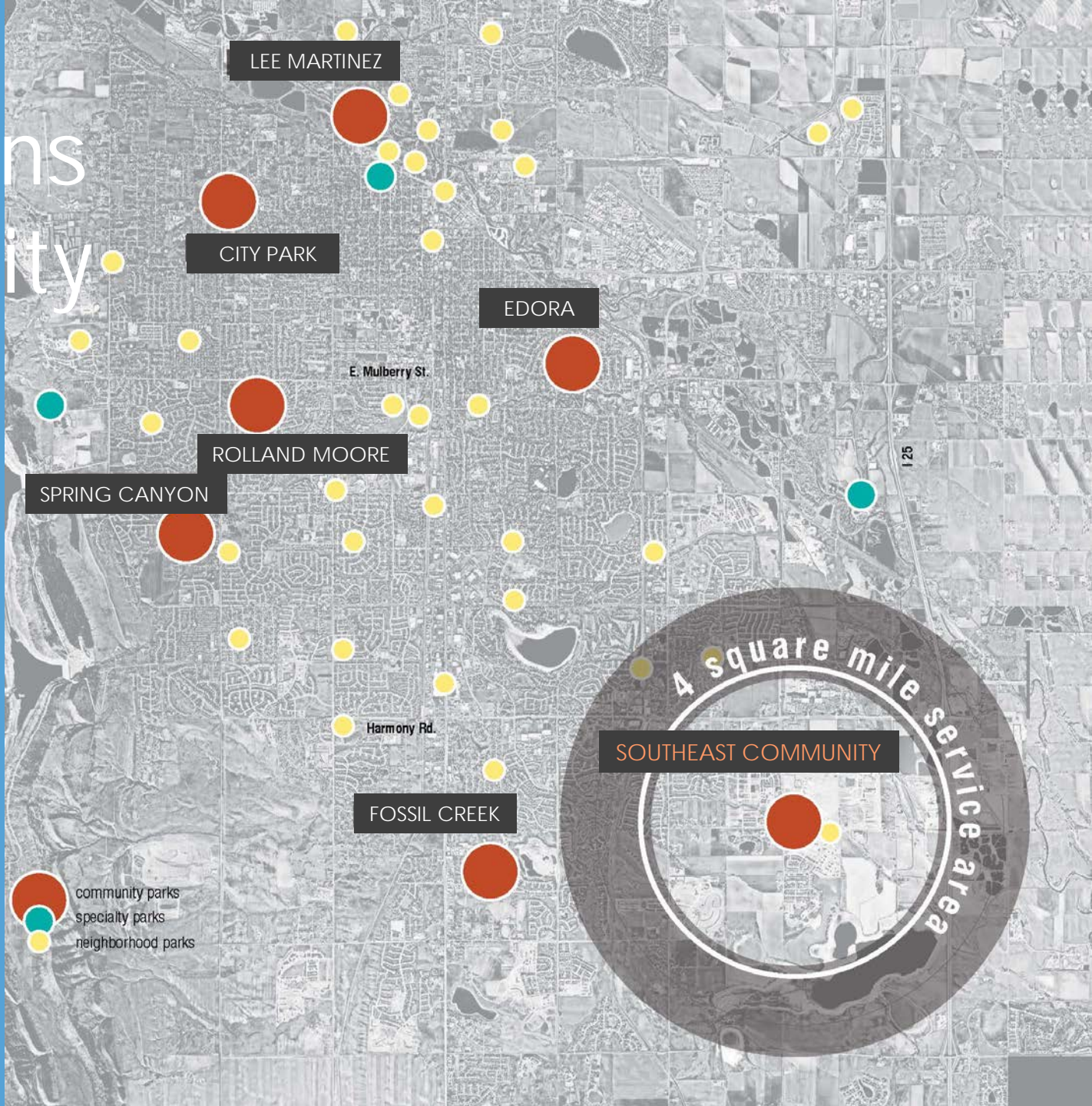



## southeast community park

**50 acres**

- approximately 20 acres is made up of a riparian creek corridor
- approximately 30 acres for development



## spring canyon park

**100 acres**

- Tennis Courts - lighted
- Four Shelters
- Inspiration Playground
- Ball Fields - not lighted
- Sports Fields
- Basketball Courts
- Horseshoe pit
- Bike Course
- Volley Ball Courts
- Skate Park/Hockey Rink
- Interactive Water Feature
- Dog Park
- Easy access to the Spring Creek Trail



## fossil creek park

**99.5 acres**

- Fossil Creek Lake
- Tennis Courts - lighted
- Two Restrooms
- Both Shelters are reservable
- call 970-221-6660 for more info.
- Playground
- Ball Fields - lighted
- Sports Fields
- Basketball Courts
- Horseshoe Pits
- Bike Course
- Skate Park/Hockey Rink
- Dog Park
- Interactive Water Feature

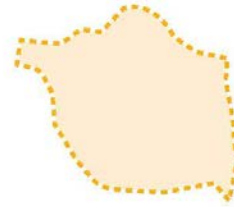

## city park

**86 acres**

- City Park Lake (Sheldon Lake)
- Tennis Courts - lighted
- Seven Shelters
- Shelter #7 is a reservable shelter
- call 970-221-6660 for more info.
- Playground
- Ball Fields - lighted
- Sports Fields
- Basketball Courts
- Horseshoe pit
- Fitness Course
- Replica of the Statue of Liberty
- Arboretum - self-guided tree tour available

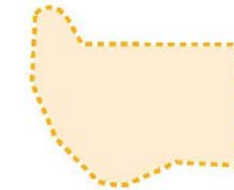

# Community Parks

Size Comparison



Natural Play



Baseball



Water Play



Climbing Wall

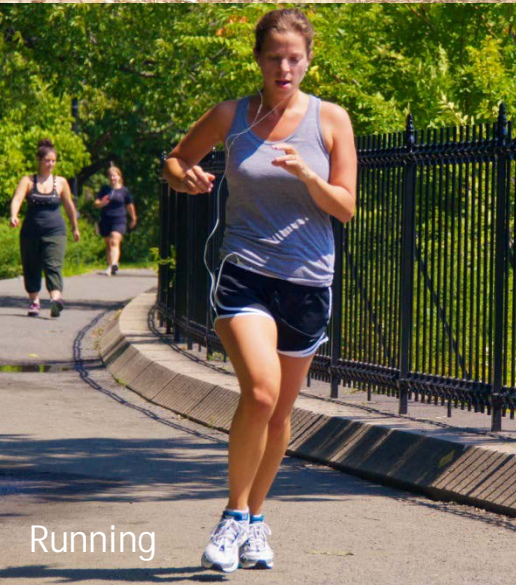

Running



Ropes Course



Soccer



BMX

# What We Heard

Recreation

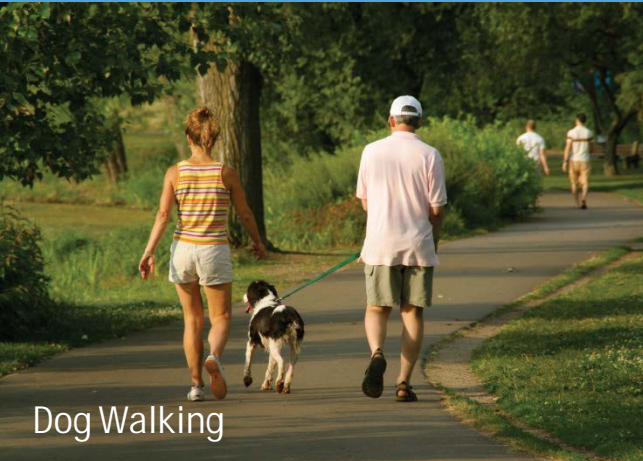

Dog Walking



Gardening



Trails



Wildlife Viewing



Picnicking



Orchard

# What We Heard

Recreation

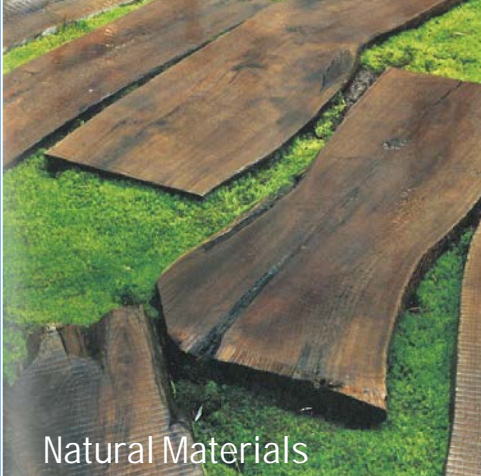

Natural Materials



Creative Play



Playful



Natural Water

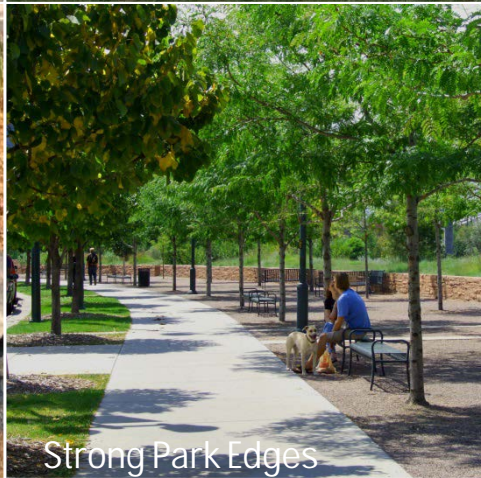

Strong Park Edges

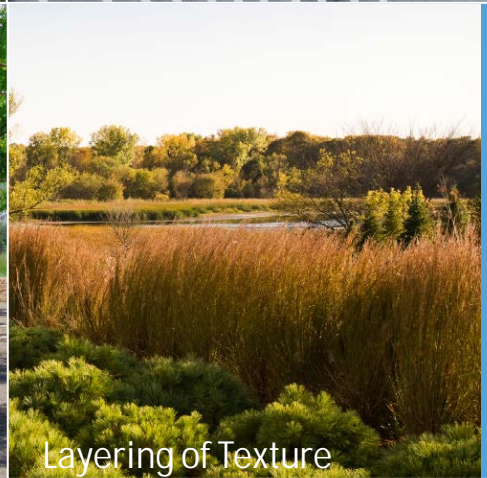

Layering of Texture



Perennial Color

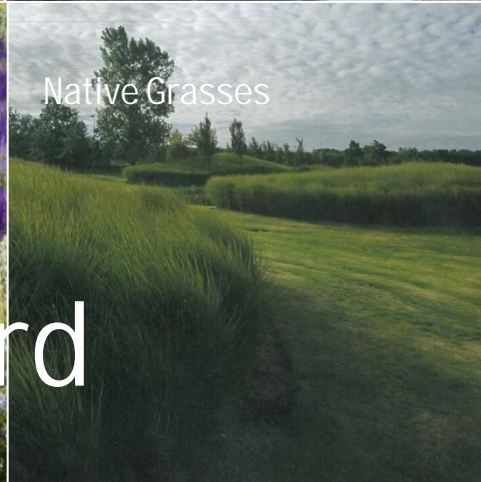

Native Grasses

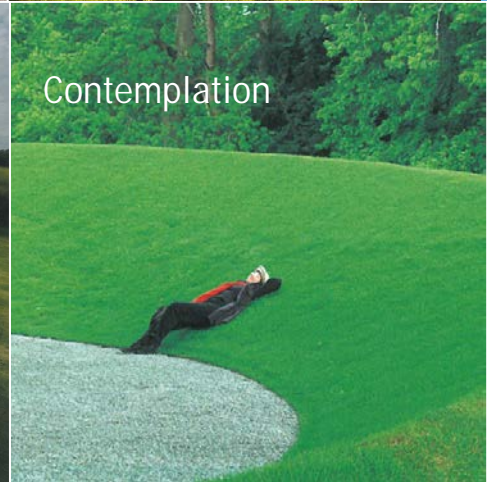

Contemplation

# What We Heard

Design Ideas

# Community Meeting 3



# Neighborhood Concerns

- All parking located on south side of park
- Parking not distributed around the park
- Traffic concerns with park entrances on Kechter Road
- Preference for park entrance off of Ziegler Road
- Lighted ball and turf fields
- Playground too close to Kechter Road
- Unsightly BMX course highly visible from Ziegler Road



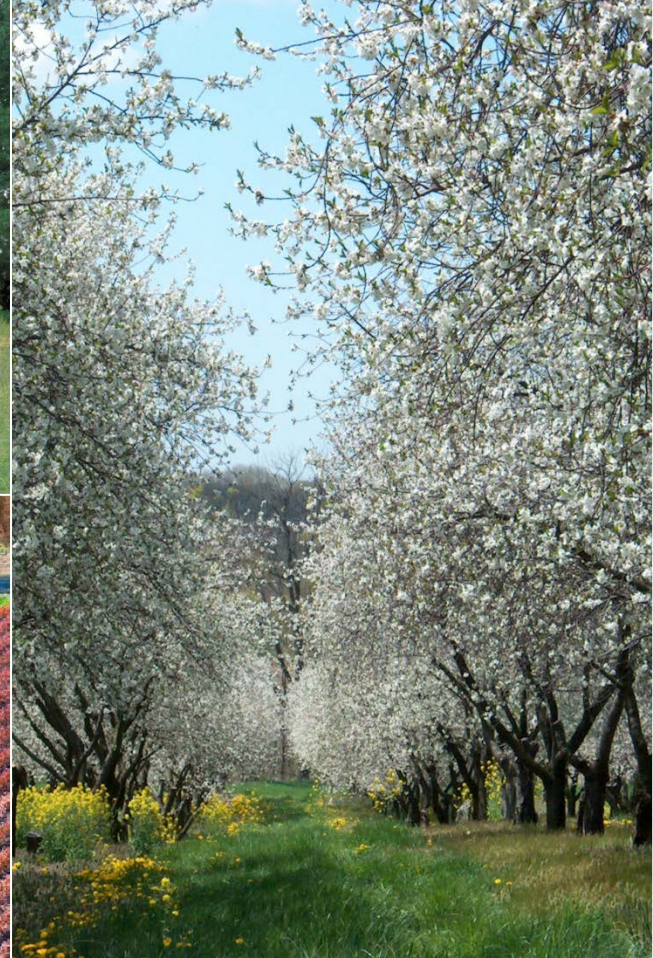







# Farm Experiences

- Driving down a long narrow driveway
- Exploring a windbreak
- Exploring multiple buildings on a homestead
- Relaxing on a porch
- Playing in a barn
- Playing in the creek
- Picking fruit from an orchard
- Keeping a garden
- Enjoying views across an open field





# The Homestead



# The Homestead

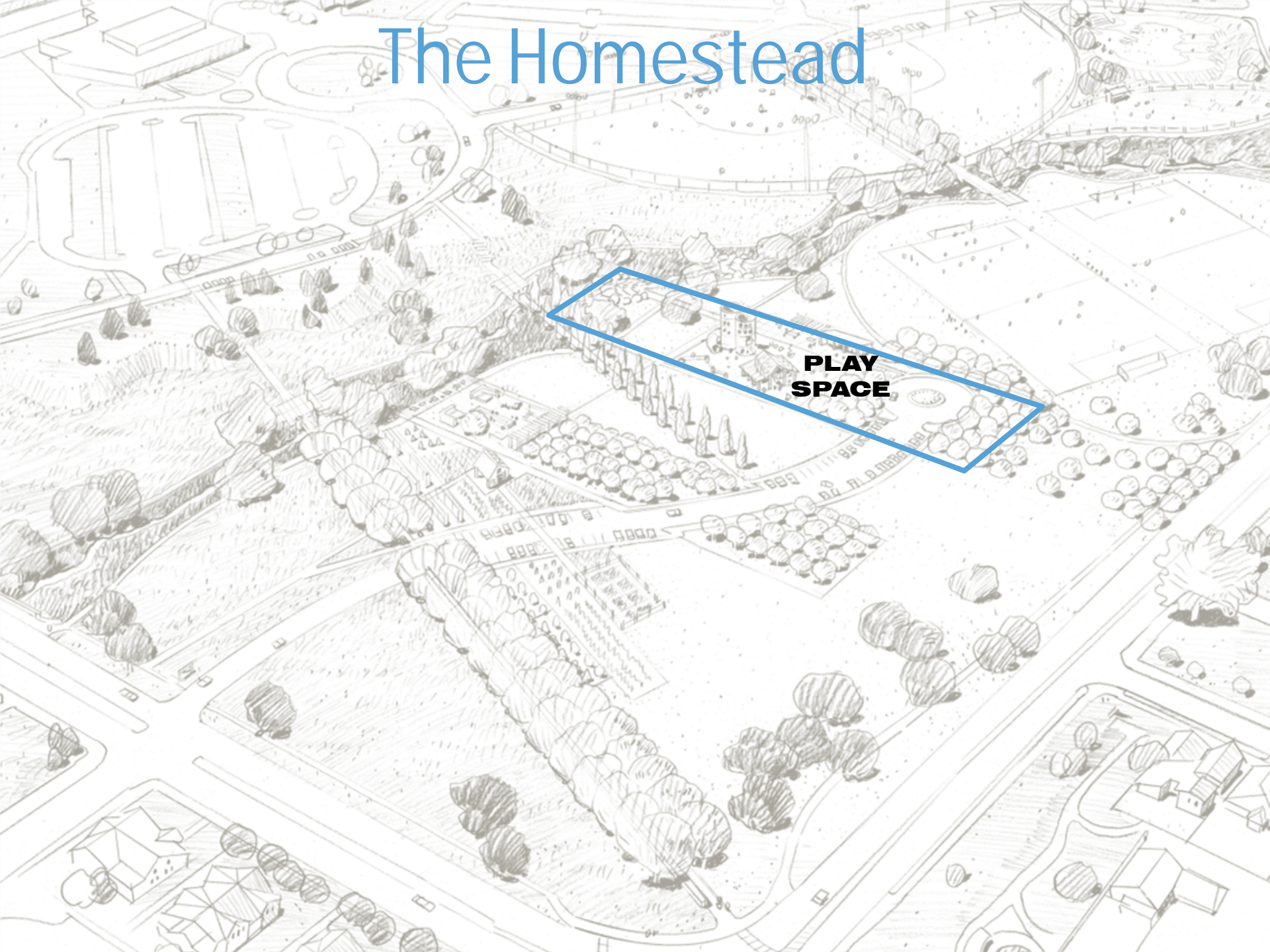

**PLAY  
SPACE**



# The Homestead

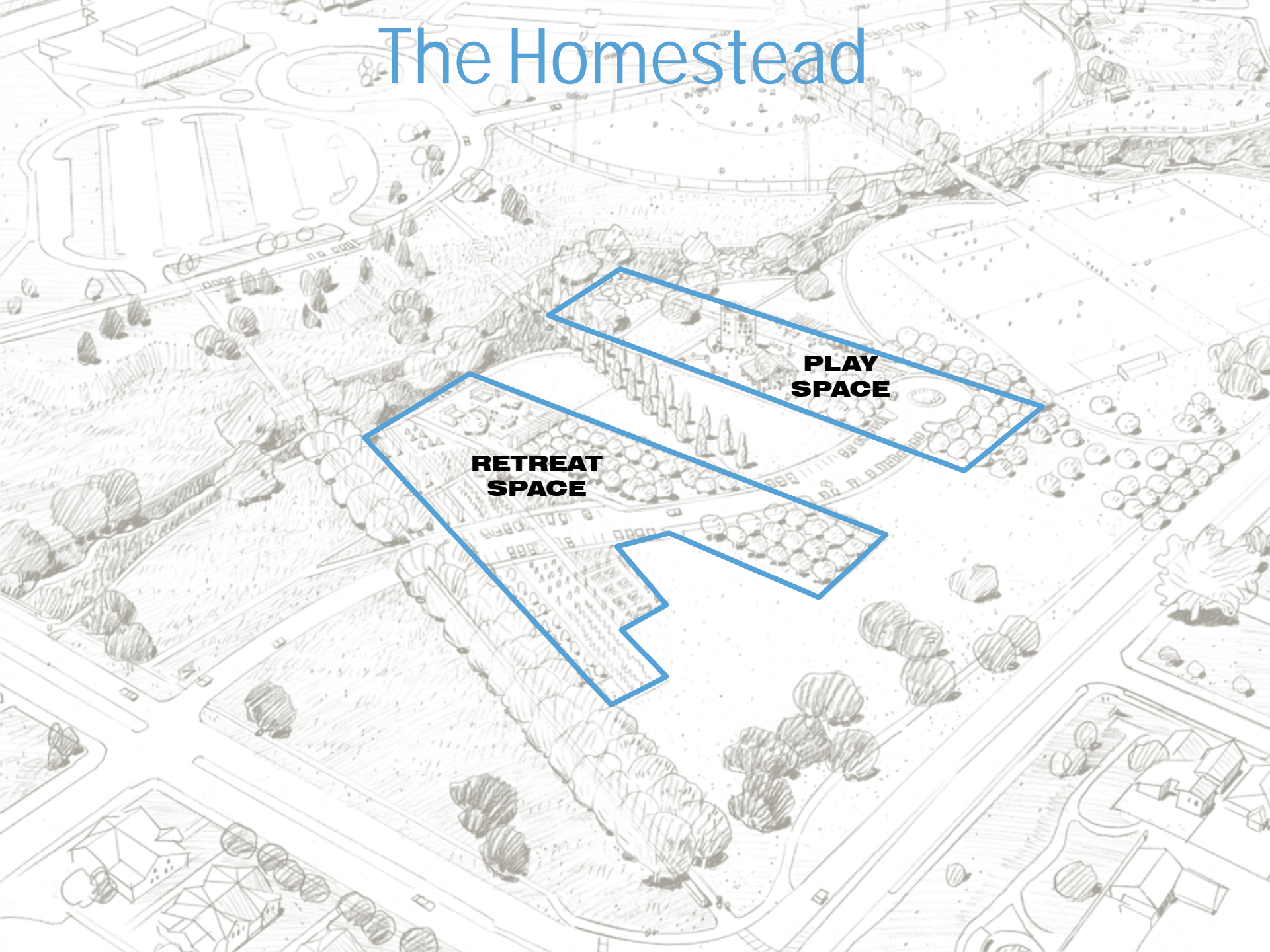

**PLAY  
SPACE**

**RETREAT  
SPACE**

# The Homestead

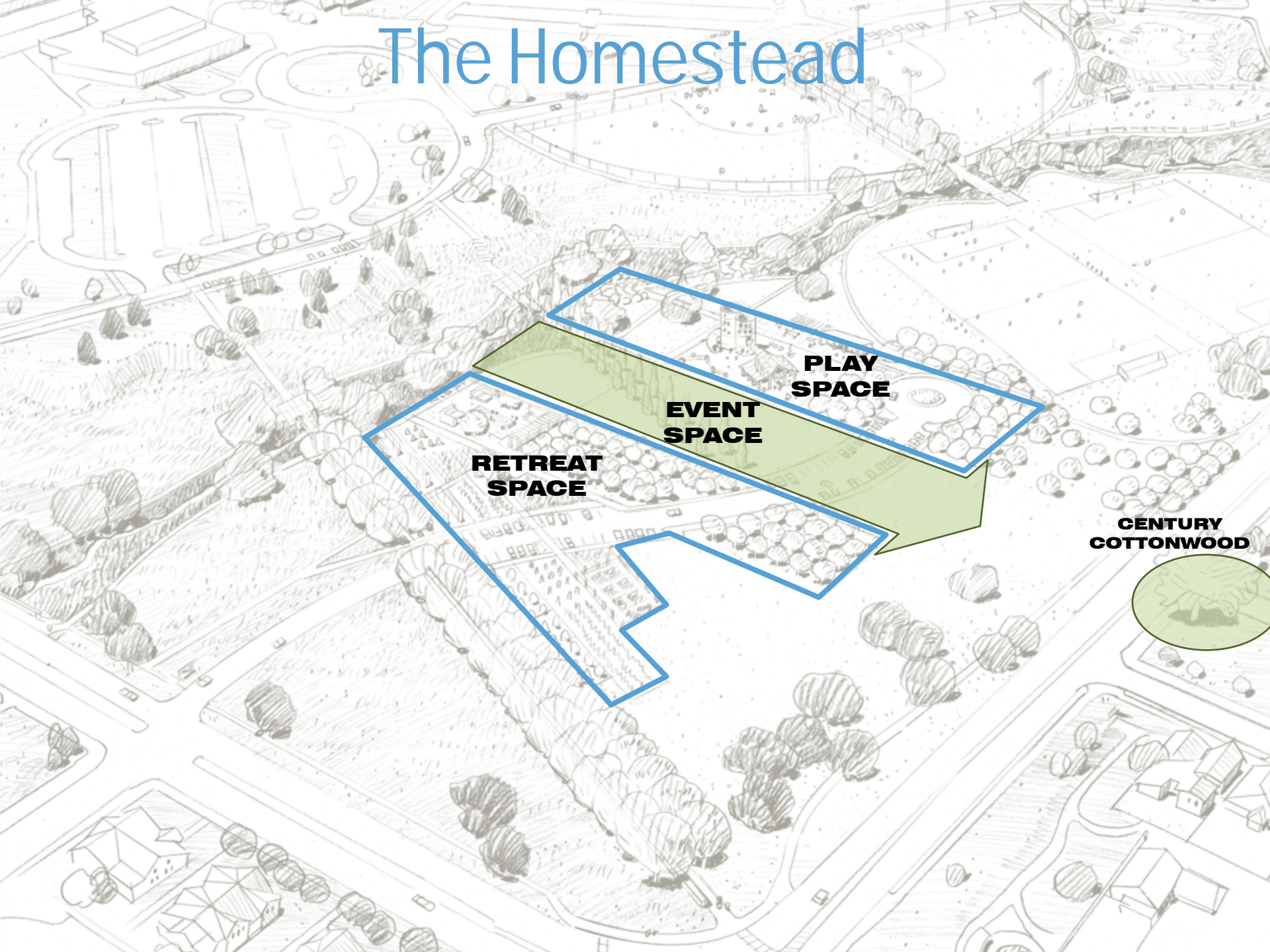

**PLAY  
SPACE**

**EVENT  
SPACE**

**RETREAT  
SPACE**

**CENTURY  
COTTONWOOD**

# The Homestead

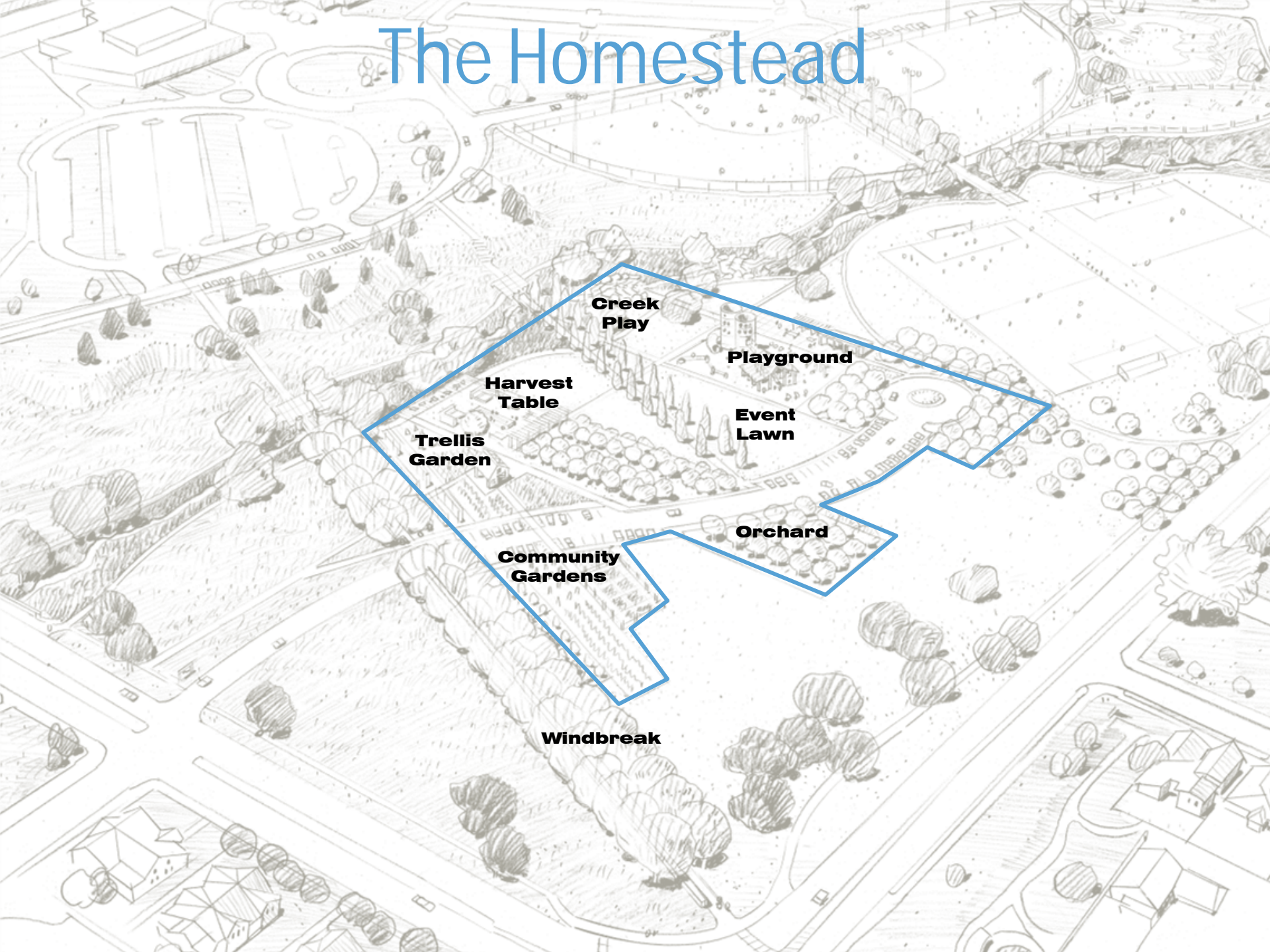

**Creek  
Play**

**Playground**

**Harvest  
Table**

**Event  
Lawn**

**Trellis  
Garden**

**Orchard**

**Community  
Gardens**

**Windbreak**

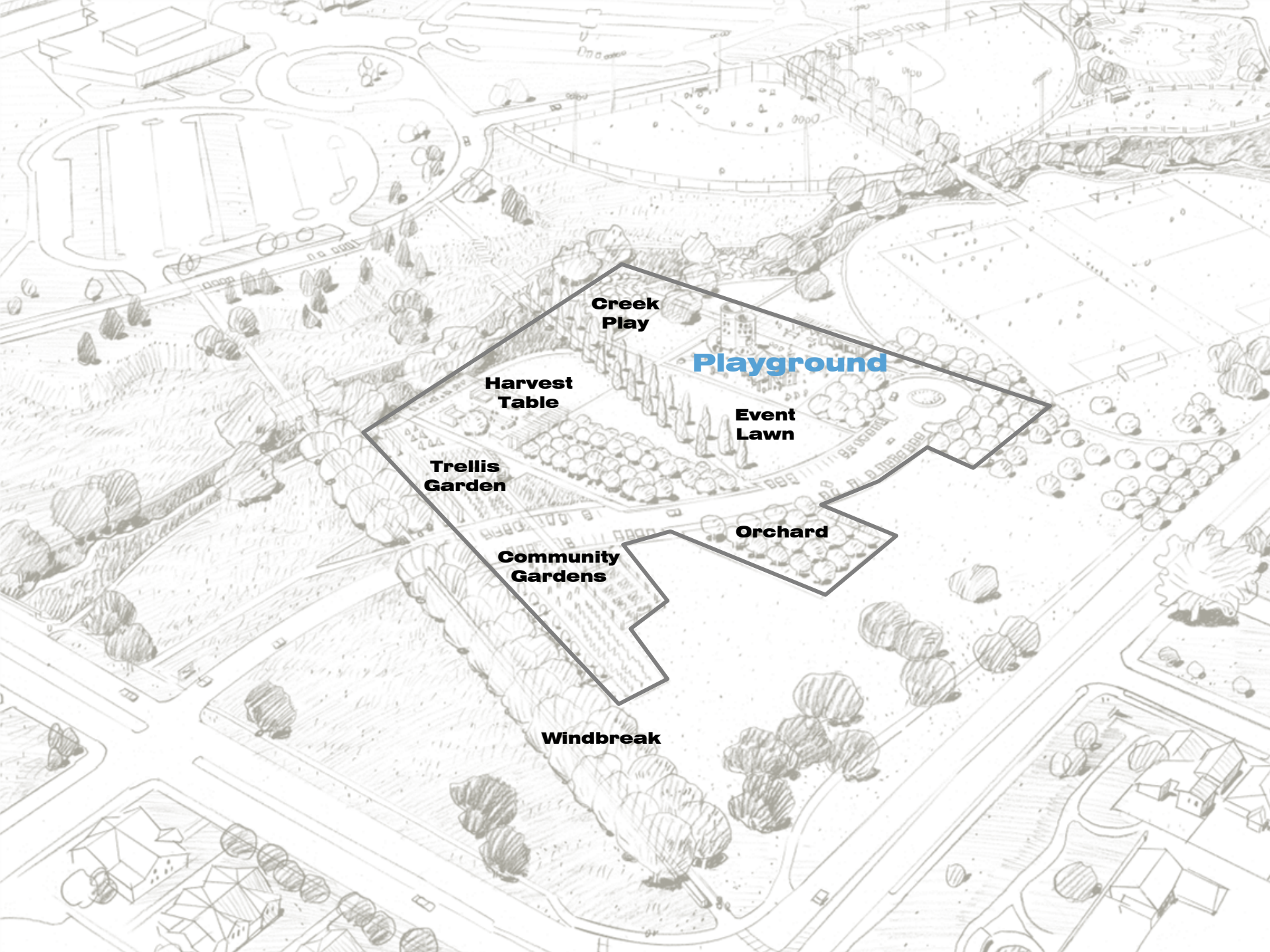

**Creek  
Play**

**Playground**

**Harvest  
Table**

**Event  
Lawn**

**Trellis  
Garden**

**Orchard**

**Community  
Gardens**

**Windbreak**

# Silos Timberline & Prospect



# Playground



# Playground



# Playground





# Playground



# Playground

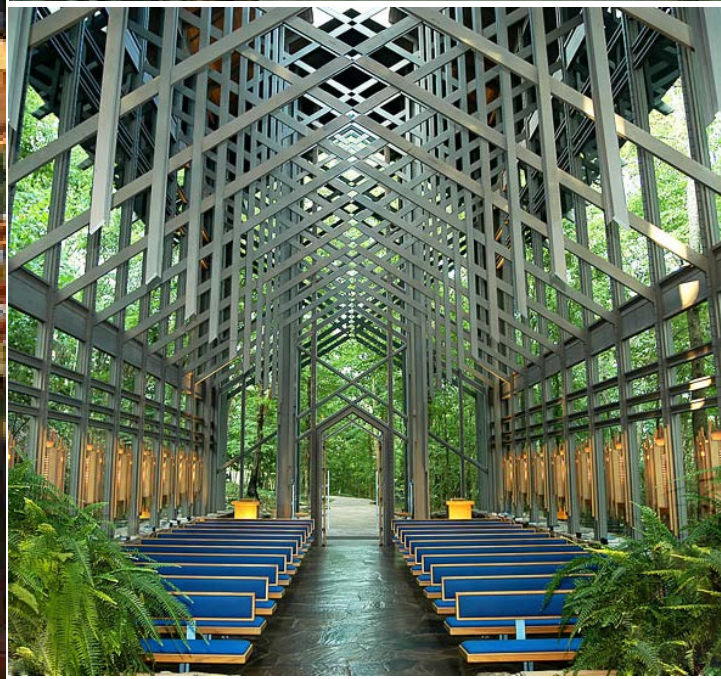

# Playground

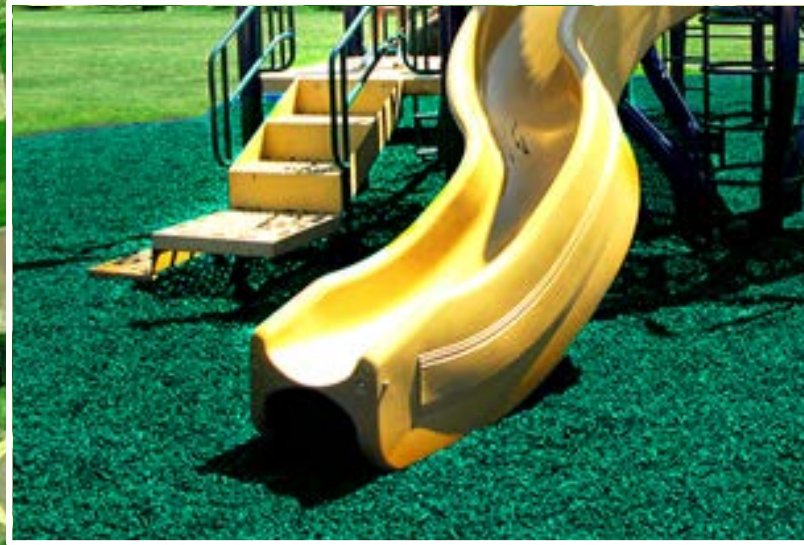

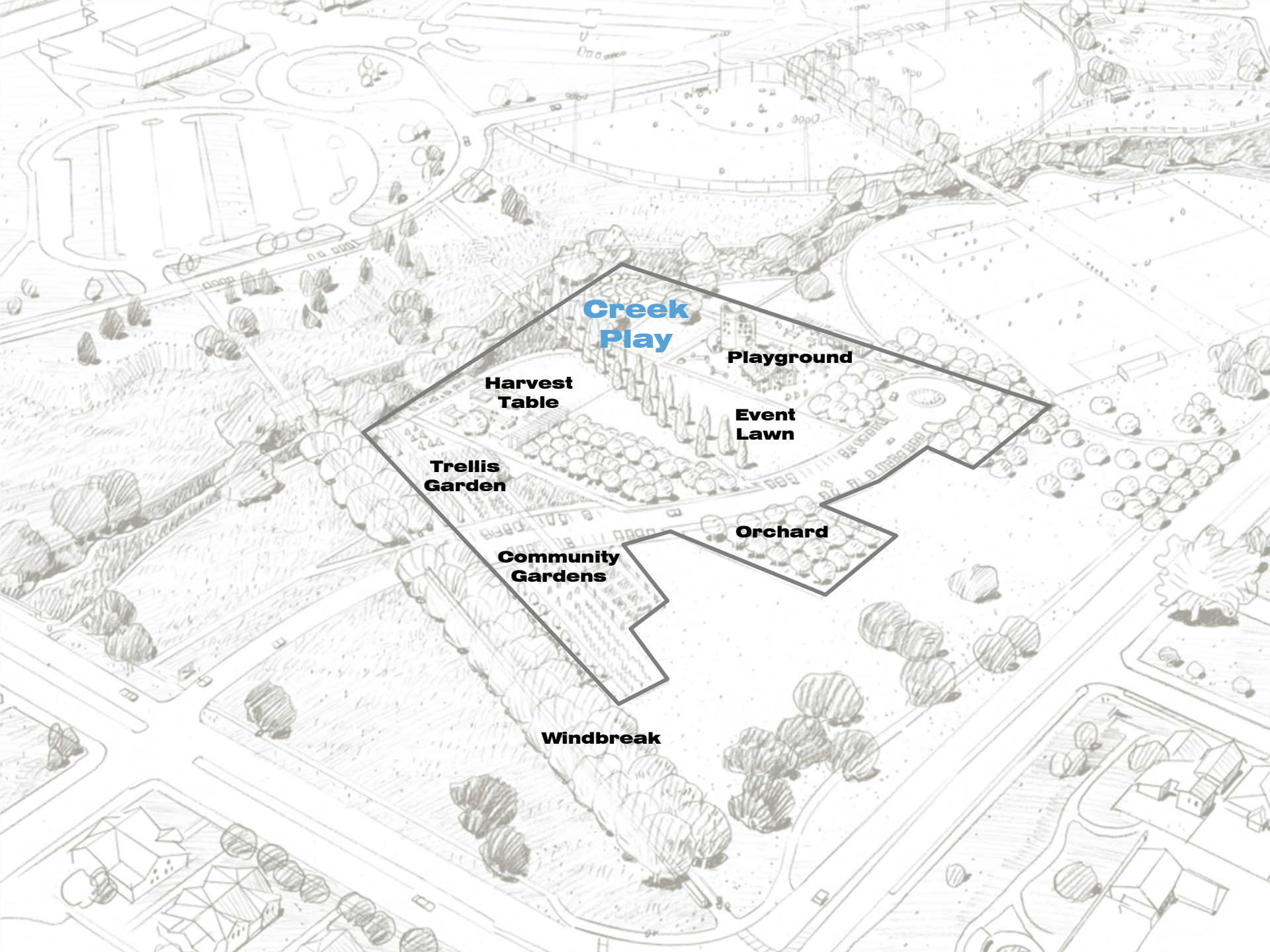

**Creek  
Play**

**Playground**

**Harvest  
Table**

**Event  
Lawn**

**Trellis  
Garden**

**Orchard**

**Community  
Gardens**

**Windbreak**

# Creek Play



# Creek Play



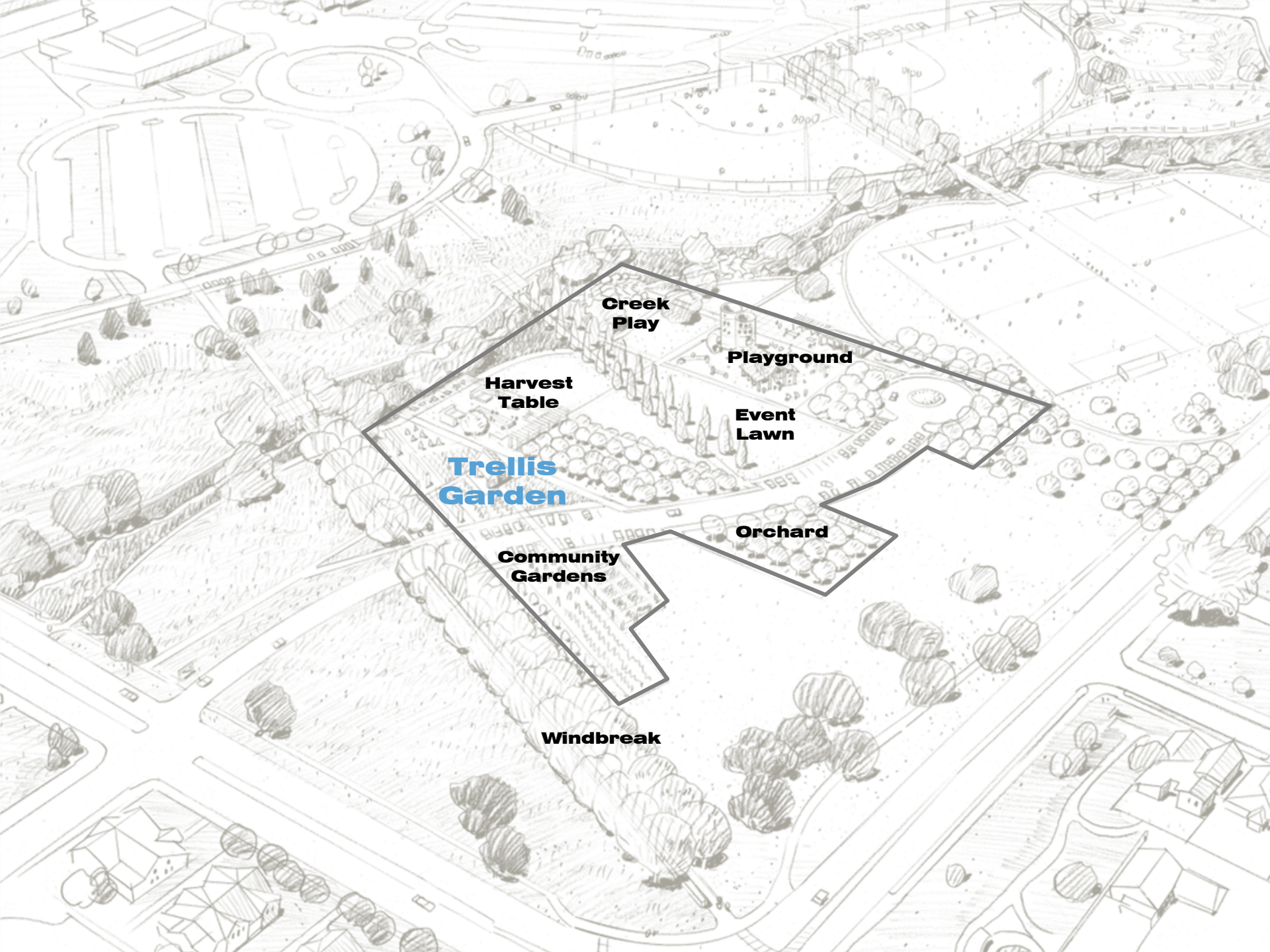

**Creek  
Play**

**Playground**

**Harvest  
Table**

**Event  
Lawn**

**Trellis  
Garden**

**Orchard**

**Community  
Gardens**

**Windbreak**

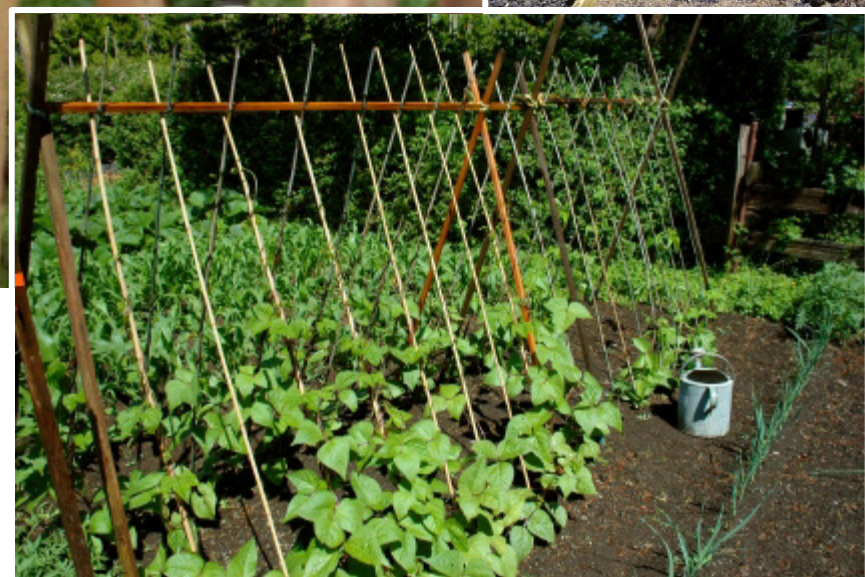

Trellis Garden



# Trellis Garden



# Trellis Garden



# Trellis Garden



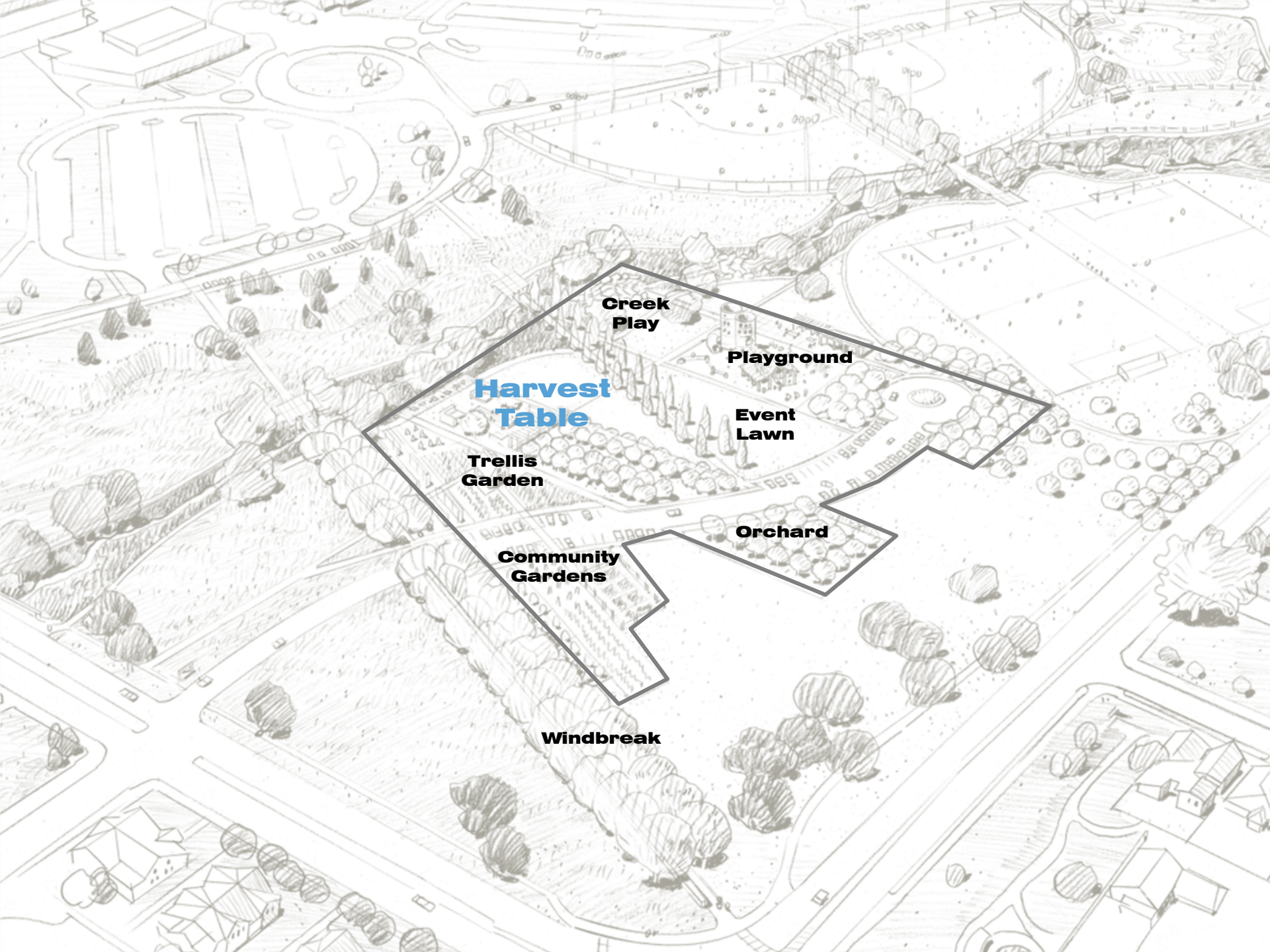

**Creek  
Play**

**Playground**

**Harvest  
Table**

**Event  
Lawn**

**Trellis  
Garden**

**Orchard**

**Community  
Gardens**

**Windbreak**

# Harvest Table



**Creek**

**Back Porch**

**Harvest Table**

**Trellis**

**Event Lawn**

**Orchard**

**Vertical Gardens**

**Trellis Garden**

**Stone Wall**

**Farm House Picnic Shelter**

# Harvest Table/Water Feature



# Vertical Gardens





# Architecture





# Orchard





# Stone Walls



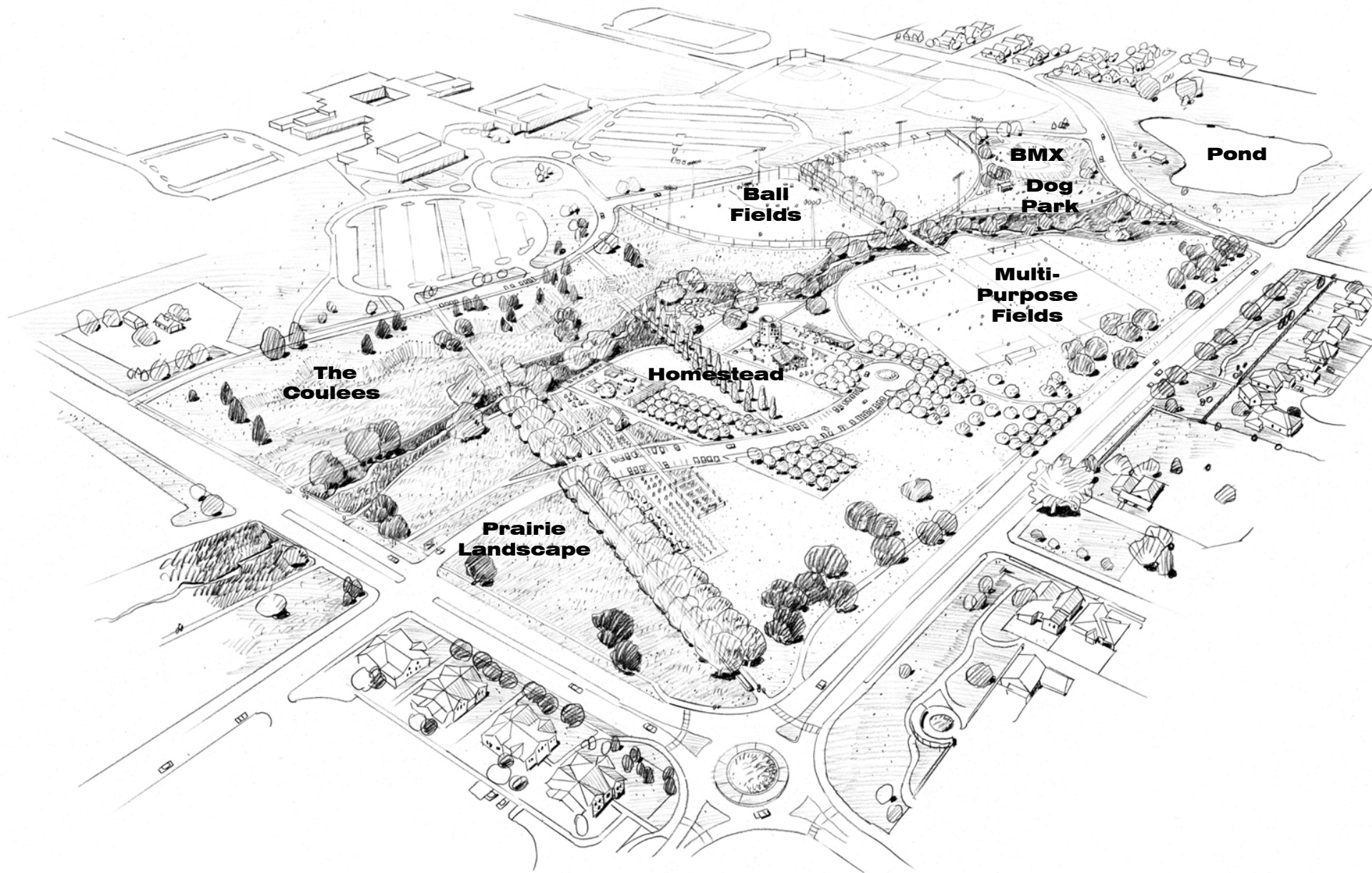

**The Coulees**

**Prairie Landscape**

**Homestead**

**Ball Fields**

**BMX Dog Park**

**Multi-Purpose Fields**

**Pond**

# Prairie Landscape



# Coulees



# Neighborhood Concerns Addressed

- Parking is distributed around the park
- Primary park entrance off Ziegler instead of Kechter
- Multi-purpose fields are not lighted, ball fields are lighted
- Playground is a safe distance from major roads
- BMX course is not in a prominent location



# Schedule

- **Design** January - September 2015
- **Construction** January 2016 – April 2017
- **Grand Opening** Spring-Summer 2017