

UNITED STATES DEPARTMENT OF THE INTERIOR
NATIONAL PARK SERVICE

FOR NPS USE ONLY

RECEIVED JAN 29 1980

DATE ENTERED

OCT 3 1980

NATIONAL REGISTER OF HISTORIC PLACES
INVENTORY -- NOMINATION FORMSEE INSTRUCTIONS IN *HOW TO COMPLETE NATIONAL REGISTER FORMS*
TYPE ALL ENTRIES -- COMPLETE APPLICABLE SECTIONS**1 NAME**

HISTORIC

Laurel School Historic District

AND/OR COMMON

Midtown Historic District, Midtown, Laurel School

2 LOCATION

STREET & NUMBER

Off U.S. 287

CITY, TOWN

Fort Collins

VICINITY OF

NOT FOR PUBLICATION

CONGRESSIONAL DISTRICT

4

STATE

Colorado

CODE

08

COUNTY

Larimer

CODE

069

3 CLASSIFICATION

CATEGORY

☒ DISTRICT☐ BUILDING(S)☐ STRUCTURE☐ SITE☐ OBJECT

OWNERSHIP

☒ PUBLIC☒ PRIVATE☐ BOTH

PUBLIC ACQUISITION

☐ IN PROCESS☐ BEING CONSIDERED

STATUS

☒ OCCUPIED☐ UNOCCUPIED☐ WORK IN PROGRESS

ACCESSIBLE

☐ YES: RESTRICTED☒ YES: UNRESTRICTED☐ NO

PRESENT USE

☐ AGRICULTURE☐ MUSEUM☒ COMMERCIAL☐ PARK☐ EDUCATIONAL☒ PRIVATE RESIDENCE☐ ENTERTAINMENT☐ RELIGIOUS☐ GOVERNMENT☐ SCIENTIFIC☐ INDUSTRIAL☐ TRANSPORTATION☐ MILITARY☐ OTHER:**4 OWNER OF PROPERTY**

NAME

See Continuation Sheets

STREET & NUMBER

CITY, TOWN

STATE

VICINITY OF

5 LOCATION OF LEGAL DESCRIPTION

COURTHOUSE,

REGISTRY OF DEEDS, ETC.

Larimer County Courthouse

STREET & NUMBER

200 Block, West Oak

CITY, TOWN

Fort Collins

STATE

Colorado

6 REPRESENTATION IN EXISTING SURVEYS

TITLE

Colorado Inventory of Historic Sites (35/07/000/06)

DATE

Ongoing

☐ FEDERAL ☒ STATE ☐ COUNTY ☐ LOCALDEPOSITORY FOR
SURVEY RECORDS

Colorado Historical Society, 1300 Broadway

CITY, TOWN

Denver

STATE

Colorado 80203

7 DESCRIPTION

CONDITION

☐ EXCELLENT
☒ GOOD
☐ FAIR

☐ DETERIORATED
☐ RUINS
☐ UNEXPOSED

CHECK ONE

☐ UNALTERED
☒ ALTERED

CHECK ONE

☒ ORIGINAL SITE
☐ MOVED DATE _____

DESCRIBE THE PRESENT AND ORIGINAL (IF KNOWN) PHYSICAL APPEARANCE

Located in Fort Collins, Colorado, the Midtown Historic District is a residential area that reflects the characteristic features of a middle-class farming community that developed in the late nineteenth and early twentieth centuries. The District includes 665 properties. Of these 549 contribute to the historic and architectural fabric that gives the District its integrity; another seventy-two are more modern buildings that are nonetheless compatible with the older structures; and another forty-four are intrusions that detract from the fabric of the area.

Although the boundary of the District is irregular, it is essentially rectangular in shape and may be readily justified. The northern boundary, the most highly irregular, is the line which delineates those blocks which have a high degree of integrity from those blocks which have a high degree of new commercial buildings, parking lots, and irreversibly altered historic structures. On the west the alleyway between Remington Street and College Avenue delineates the long row of homes that face Remington from the long row of commercial structures that face College. The southern boundary is marked off by Fort Collins High School, and the eastern boundary by the alleyway that runs east of Whedbee Street; to the south and east of these lines are homes that were built largely in the 1930s and after.

The Midtown Historic District developed over a sixty-year period, but throughout that time it retained a certain uniformity. A vast number of the structures are small, one-story brick or frame cottages rectangular in shape. They have few decorative elements, but are unmistakably late Victorian. On Remington Street, however, are a number of larger, more elaborate brick houses designed by local architects. These buildings clearly represent the Italianate, Queen Anne, Eastlake and other thrusts of Victorian architecture, as well they might, for they were constructed for the wealthier, more prominent people in the city. And finally, scattered through the District are schools, churches, and other buildings that characterize a residential neighborhood.

UNITED STATES DEPARTMENT OF THE INTERIOR
NATIONAL PARK SERVICE

**NATIONAL REGISTER OF HISTORIC PLACES
INVENTORY -- NOMINATION FORM**

FOR NPS USE ONLY

RECEIVED JAN 29 1980

DATE ENTERED

CONTINUATION SHEET	Owners of Property	ITEM NUMBER	PAGE
#1 Faith Tabernacle 328 Remington Fort Collins, CO 80521	#9 Alan R. Porter Post Office Box 544 Fort Collins, CO 80521	4	2
#2 Loretta Caprucci % Realty Brokers Exchange 220 West Prospect Fort Collins, CO 80521	#10 Willard & Gladys Eddy 509 Remington Fort Collins, CO 80521		
#3 Maude C. & Walter H. Wyss 408 Remington Fort Collins, CO 80521	#11 Alan R. Porter Post Office Box 544 Fort Collins, CO 80521		
#4 William P. Trewartha & Lynn W. Farrell 412 Remington Fort Collins, CO 80521	#12 Carl E. Patton III 515 Remington Fort Collins, CO 80521		
#5 Treava G. Hess 416 Remington Fort Collins, CO 80521	#13 Alan R. Porter Post Office Box 544 Fort Collins, CO 80521		
#6 A. Bernice Jones Letha Mae Wise Patricia A. Norton 1020 Patton Fort Collins, CO 80521	#14 O. E. Bever 523 Remington Fort Collins, CO 80521		
#7 Arlen L. & Susie Chenot 842 East Stuart Fort Collins, CO 80521	#15 Alan R. Porter Post Office Box 544 Fort Collins, CO 80521		
#8 Deon F. Gadbury 1416 Pikes Peak Drive Fort Collins, CO 80521	#16 Olin & Eva Sidebottom 527 Remington Fort Collins, CO 80521		
	#17 Steven Hubert 531 Remington Fort Collins, CO 80521		
	#18 Hal-Mor Enterprises 604 Remington, Apt. #1 Fort Collins, CO 80521		
	#19 Alan R. Porter Post Office Box 544 Fort Collins, CO 80521		
	#20 Michael & Barbara Petit 3635 Goodell Lane Fort Collins, CO 80521		
	#21 Richard & Shirley Sinclair 2107 Essex Court Fort Collins, CO 80521		
	#22 Choko N. Oshima 1612 West Stuart Fort Collins, CO 80521		
	#23 Richard & Shirley Sinclair 2107 Essex Court Fort Collins, CO 80521		
	#24 Choko Oshima 1612 West Stuart Fort Collins, CO 80521		

UNITED STATES DEPARTMENT OF THE INTERIOR
NATIONAL PARK SERVICE

NATIONAL REGISTER OF HISTORIC PLACES
INVENTORY -- NOMINATION FORM

FOR NPS USE ONLY

RECEIVED JAN 29 1980

DATE ENTERED

CONTINUATION SHEET	Owners of Property	ITEM NUMBER	PAGE
#25 Mary Harnett 622 Remington Fort Collins, CO 80521	#33 Reuben & Beverly Miller Charles & Alice Adler 1380 South Harlan Street Lakewood, CO 80226	4	3
#26 George & Sherry Hartman 704 University Avenue Boulder, CO 80302	#34 Evan & Kathleen Gil- Martin 638 West Prospect Fort Collins, CO 80521		
#27 Donald Reed Mitchell & Margaret May Hopkins 626 Remington Fort Collins, CO 80521	#35 Kensington Properties, Inc. % Stanley Black Post Office Box 1345 Boulder, CO 80302		
#28 Robert C. Wolff % Orr Goodson Jr. 630 Remington Fort Collins, CO 80521	#36 Richard & Martha Bartlett % M. P. Breth 1625 West Elizabeth Fort Collins, CO 80521		
#29 Dean Rud & Roy Olivia 633 Remington Fort Collins, CO 80521	#37 Lyal & Clovis Nelson 6312 East Harmony Road Fort Collins, CO 80521		
#30 Robert C. Wolff % Orr Goodson Jr. 634 Remington Fort Collins, CO 80521	#38 Richard & Martha Barlett Post Office Box 2381 Fort Collins, CO 80521		
#31 K. D. Borrett & Alan R. Porter 1841 Ramsgate Fort Collins, CO 80521	#39 Robert & Katherine Bridwell H. I & L. J. Holtzinger 350 Circle Drive Fort Collins, CO 80521		
#32 B. R. & E. Laine Sabey 640 Remington Fort Collins, CO 80521	#40 Housing Authority City of Fort Collins 1715 West Mountain Fort Collins, CO 80521		
	#41 Barbara Bejmur Post Office Box 1613 Fort Collins, CO 80521		
	#42 Richard & Martha Bartlett Post Office Box 2381 Fort Collins, CO 80521		
	#43 Roger & Theresa Nilsson 718 Remington Fort Collins, CO 80521		
	#44 Michael & Barbara Petit 3635 Goodell Lane Fort Collins, CO 80521		
	#45 Orville V. & Margaret R. Eckman 1408 Emigh Street Fort Collins, CO 80521		
	#46 Shirley Kidd 815 Peterson Fort Collins, CO 80521		
	#47 E. Gertrude 828 West Olive Fort Collins, CO 80521		
	#48 Bernard & Robin Marzonie, Et. Al. 326 Garfield Fort Collins, CO 80521		

UNITED STATES DEPARTMENT OF THE INTERIOR
NATIONAL PARK SERVICE

**NATIONAL REGISTER OF HISTORIC PLACES
INVENTORY -- NOMINATION FORM**

FOR NPS USE ONLY

RECEIVED JAN 29 1980

DATE ENTERED

CONTINUATION SHEET	Owners of Property	ITEM NUMBER	PAGE
#49 Paul Harder 704 Garfield Fort Collins, CO 80521	#57 Maurice & Evelyn Nelson 301 East Prospect Fort Collins, CO 80521	4	4
#50 Amanda & Elizabeth Aldrich 809 Remington Fort Collins, CO 80521	#58 Maurice & Evelyn Nelson 301 East Prospect Fort Collins, CO 80521		
#51 Morrison & Associates, Investments 417 Howes Fort Collins, CO 80521	#59 Lucille Fitzgerald 828 Remington Fort Collins, CO 80521		
#52 Josephine McDowell 320 Locust Fort Collins, CO 80521	#60 J. D. Power, Sr. % 129 Investment Group 914 South College Avenue Fort Collins, CO 80521		
#53 Lydia Dody 1110 West Elizabeth Fort Collins, CO 80521	#61 James Hatfield 904 Remington Fort Collins, CO 80521		
#54 Delbert & Virginia McGuire 160 Yale Fort Collins, CO 80521	#62 Myrtle John 908 Remington Fort Collins, CO 80521		
#55 Brian & Sonja Soukup Roger & Susie Sample 624 Morseman Fort Collins, CO 80521	#63 Victoria Limited 202 Remington Fort Collins, CO 80521		
#56 Oguz Nayman 1601 Germantown Court Fort Collins, CO 80521	#64 Maxine Schaefer 931 Remington Fort Collins, CO 80521		
	#65 L. W. & Nana Durrell 1003 Remington Fort Collins, CO 80521		
	#66 E. W. Hoffman 622 South Whitcomb Fort Collins, CO 80521		
	#67 R. W. Esther Moore 1011 Remington Fort Collins, CO 80521		
	#68 Ida Lane 1016 Remington Fort Collins, CO 80521		
	#69 Mark & Alice Warner 1019 Remington Fort Collins, CO 80521		
	#70 Charles & Barbara Pope 1123 Parkwood Fort Collins, CO 80521		
	#71 Kermit & Mary Knuckles 1110 Remington Fort Collins, CO 80521		
	#72 David & Nellie McGill 1111 Remington Fort Collins, CO 80521		

UNITED STATES DEPARTMENT OF THE INTERIOR
NATIONAL PARK SERVICE

NATIONAL REGISTER OF HISTORIC PLACES
INVENTORY -- NOMINATION FORM

FOR NPS USE ONLY

RECEIVED JAN 29 1980

DATE ENTERED

CONTINUATION SHEET	Owners of Property	ITEM NUMBER	4	PAGE	5
#73 Marcia Osborn 1112 Remington Fort Collins, CO 80521	#81 Anne Hennigh 1209 Remington Fort Collins, CO 80521				#89 Bruce & Darcy McDaniel 401 Mathews Fort Collins, CO 80521
#74 Warren & Doris White 16 Sedgwich Drive Englewood, CO 80110	#82 Joseph & Judith Lavaux 2753 Alexander Court Fort Collins, CO 80521				#90 Eugene & Lulu Vaughn % Paul & Lucille Miller 405 Mathews Fort Collins, CO 80521
#75 William & Alyce Young 1016 Remington Fort Collins, CO 80521	#83 Theresa Schindel 1214 Remington Fort Collins, CO 80524				#91 Paige & Delores Lunberry 1024 East Lake Fort Collins, CO 80521
#76 Ellen Stewart 1121 Remington Fort Collins, CO 80521	#84 Harry & Ingrid Rennat 1215 Remington Fort Collins, CO 80521				#92 Dorothy Wombacher 415 Mathews Fort Collins, CO 80521
#77 Mary Lechleitner 1202 Remington Fort Collins, CO 80521	#85 Ray, Russell & Floyd Maxwell 1218 Remington Fort Collins, CO 80521				#93 T-J Investments/ George Scavo 419 Mathews Fort Collins, CO 80521
#78 James Bachmann & Michaela Rosita 1324 Teakwood Fort Collins, CO 80525	#86 Frank & Virginia Bond 128 Third Street Kersey, CO 80644				#94 George Scavo 220 East Mulberry Fort Collins, CO 80521
#79 James & Priscilla Weddell 904 Pitkin Fort Collins, CO 80521	#87 Harry & Ingrid Rennat 1215 Remington Fort Collins, CO 80521				#95 T-J Investments 220 East Mulberry Fort Collins, CO 80521
#80 William & Lillian Clark 1525 Whedbee Fort Collins, CO 80521	#88				#96 E. P. Smith 4816 Deertrail Court Fort Collins, CO 80521

UNITED STATES DEPARTMENT OF THE INTERIOR
NATIONAL PARK SERVICE

**NATIONAL REGISTER OF HISTORIC PLACES
INVENTORY -- NOMINATION FORM**

FOR NPS USE ONLY

RECEIVED JAN 29 1980

DATE ENTERED

CONTINUATION SHEET	Owners of Property	ITEM NUMBER	PAGE
		4	6
#97 Mary Moore, et. al. Post Office Box 277 Fort Collins, CO 80521	#105 Maynard & Kerrine Thomson 401 Bradley Fort Collins, CO 80521	#113 Gary & Nancy Crowder 633 Mathews Fort Collins, CO 80521	
#98 Donald & Dorothy Maxwell 511 Mathews Fort Collins, CO 80521	#106 Martin Falk & Jerry Brumit 619 South College Avenue Fort Collins, CO 80521	#114 David & Eleanor Lowsley % D. G. Calvin 1229 Harris Drive Fort Collins, CO 80521	
#99 Mona Nickerson 505 Mathews Fort Collins, CO 80521	#107 George & Jule Laughlin 2626 Terry Lake Road Fort Collins, CO 80521	#115 Collins Investments 1501 Lemay, #102 Fort Collins, CO 80521	
#100 Arlington Percy 3732 Crescent Drive Fort Collins, CO 80521	#108 Oguz Nayman 617 Mathews Fort Collins, CO 80521	#116 Christopher Munford Post Office Box 1342 Fort Collins, CO 80521	
#101 John & Jan Bowser 521 Mathews Fort Collins, CO 80521	#109 A. Dolores Pemberton Route 3 Calhan, CO 80800	#117 Elizabeth Johnson % Martin Falk 619 South College Fort Collins, CO 80521	
#102 George & Deborah Nelson 527 Mathews Fort Collins, CO 80521	#110 Leonard & Jeri Zane 915 West Mountain Fort Collins, CO 80521	#118 Dean & Phyliss Wolfe 704 Mathews Fort Collins, CO 80521	
#103 Lucile Foltz 600 Mathews Fort Collins, CO 80521	#111 Samuel T. Combs 417 East Mulberry Street Fort Collins, CO 80524	#119 David E. Yeane 705 Mathews Fort Collins, CO 80521	
#104 Maynard & Kerrine Thomson 401 Bradley Fort Collins, CO 80521	#112 James & Penny Bittle 629 Mathews Fort Collins, CO 80521	#120 Edmund & Violet Schulz 710 Mathews Fort Collins, CO 80521	

UNITED STATES DEPARTMENT OF THE INTERIOR
NATIONAL PARK SERVICE

**NATIONAL REGISTER OF HISTORIC PLACES
INVENTORY -- NOMINATION FORM**

FOR NPS USE ONLY

RECEIVED JAN 29 1980

DATE ENTERED

CONTINUATION SHEET	Owners of Property	ITEM NUMBER	PAGE
		4	7
#121 Robert & Katherine Schafer 711 Mathews Fort Collins, CO 80521	#129 Robert & Kathleen Theodoratus 726 Mathews Fort Collins, CO 80521	#137 James Arvidson 201 Annabell Fort Collins, CO 80521	
#122 Lyal Nelson 6312 East Harmony Road Fort Collins, CO 80521	#130 William & Gertrude Sackschewsky 828 West Olive Fort Collins, CO 80521	#138 Gene Watkinson 821 Mathews Fort Collins, CO 80521	
#123 Chester & Lucille Evans 714 Mathews Fort Collins, CO 80521	#131 Beverly Denna 2 Otter Lane North Oaks, Minnesota 55110	#139 James Arvidson 201 Annabell Fort Collins, CO 80521	
#124 Frank Crist, Jr. 717 Mathews Fort Collins, CO 80521	#132 Otto Christman Post Office Box 1808 Fort Collins, CO 80522	#140 Norvin & Carolyn Frerichs 1235 Blake Wray, CO 80758	
#125 Thomas & Claudine McMillan 718 Mathews Fort Collins, CO 80521	#133 Dean & Olivia Rud 307 East Plum Fort Collins, CO 80521	#141 J. R. Green 830 Mathews Fort Collins, CO 80521	
#126 R. A. Longenbaugh 721 Mathews Fort Collins, CO 80521	#134 James & Eula Call 817 Mathews Fort Collins, CO 80521	#142 David & Barbra Hawes 5430 Fossil Creek Drive Fort Collins, CO 80521	
#127 Glen & Torchie Dille 614 North University Peoria, Illinois 61606	#135 Bruce Jones 5115 Williams Fork Trail, Apartment 108 Boulder, CO 80302	#143 Dale Eggleston 1213 Teakwood Drive Fort Collins, CO 80521	
#128 Ricky Knoll Investments, 828 Olive Fort Collins, CO 80521	#136 John Hickman 819 Mathews Fort Collins, CO 80521	#144 Barbra Wetzel 903 Mathews Fort Collins, CO 80521	

UNITED STATES DEPARTMENT OF THE INTERIOR
NATIONAL PARK SERVICE

**NATIONAL REGISTER OF HISTORIC PLACES
INVENTORY -- NOMINATION FORM**

FOR NPS USE ONLY

RECEIVED JAN 29 1980

DATE ENTERED

CONTINUATION SHEET	Owners of Property	ITEM NUMBER	4	PAGE	8
#145 Dale & Mary Eggleston 1213 Teakwood Drive Fort Collins, CO 80521	#153 Gladys Mackenzie 1370 East Third Street Delta, California 81416			#161 Mildred Coutts 515 West Oak Fort Collins, CO 80521	
#146 William Thomas 1630 South College Fort Collins, CO 80521	#154 Robert MacGregor & Eliabeth Spangler 1117 Mathews Fort Collins, CO 80521			#162 Thomas & Shirley Kidd 815 Peterson Fort Collins, CO 80521	
#147 Dale & Mary Eggleston 1213 Teakwood Drive Fort Collins, CO 80521	#155 James & Janetha Boswell 1213 Mathews Fort Collins, CO 80521			#163 Keith Johnston 2602 31st Street Lubbock, Texas 79610	
#148 Mollie Kuemmerlin 220 Garfield Fort Collins, CO 80521	#156 Charles & Hattie Griffith 1219 Mathews Fort Collins, CO 80521			#164 W. D. & Jennie Holley Route #1 Livermore, CO 80536	
#149 O. H. & Helen Nieder 1106 Mathews Fort Collins, CO 80521	#157 William Thomas 1630 South College Avenue Fort Collins, CO 80521			#165 Roderick Smith 3501 Winslow Drive Fort Collins, CO 80521	
#150 James & Lenie Henderson 1109 Mathews Fort Collins, CO 80521	#158 Reinhold Winter, et. al. 104 Peterson Fort Collins, CO 80521			#166 Thomas & Lillian Heiland 208 Peterson Fort Collins, CO 80521	
#151 Dwight & Rae Larve 1110 Mathews Fort Collins, CO 80521	#159 Scott Billington & Francis 4630 Venturi Lane Furney Fort Collins, CO 80521			#167 Thomas & Lillian Heiland 208 Peterson Fort Collins, CO 80521	
#152 Albert & Barbra Young 1112 Mathews Fort Collins, CO 80521	#160 John C. Davis 107 Peterson Fort Collins, CO 80521			#168 Richard & Mary Lou Martin 218 Peterson Fort Collins, CO 80521	

UNITED STATES DEPARTMENT OF THE INTERIOR
NATIONAL PARK SERVICE

NATIONAL REGISTER OF HISTORIC PLACES
INVENTORY -- NOMINATION FORM

FOR NPS USE ONLY

RECEIVED JAN 29 1980

DATE ENTERED

CONTINUATION SHEET	Owners of Property	ITEM NUMBER	PAGE
#169 Ellen Scheidt 226 Peterson Fort Collins, CO 80521	#177 Jozef & Anna Bielanski 326 Peterson Fort Collins, CO 80521	4	9
#170 David L. Parker c/o General Delivery Timmath, CO 80547	#178 Kenneth & Harriet Doty 330 Peterson Fort Collins, CO 80521		
#171 Paige & Delores Lunberry 1024 E. Lake Fort Collins, CO 80521	#179 Edwina Streit 400 Peterson Fort Collins, CO 80521		
#172 Paige & Delores Lunberry 1024 E. Lake Fort Collins, CO 80521	#180 Sheri & Erick Weiss 406 Peterson Fort Collins, CO 80521		
#173 Hillard & Vianna Beuhler c/o Victor & Roberta Brown 318 Peterson Fort Collins, CO 80521	#181 Sheri & Erick Weiss 410 Peterson Fort Collins, CO 80521		
#174 Robert & Maria Brown 318 Peterson Fort Collins, CO 80521	#182 William & Luella Albrecht 412 Peterson Fort Collins, CO 80521		
#175 Robert Brown 318 Peterson Fort Collins, CO 80521	#183 Wilber D. Waite 10220 W. 23rd Ave. Lakewood, CO 80215		
#176 Beryl & Irilla Calkins 322 Peterson Fort Collins, CO 80524	#184 Matt & Christine Giro 416 Peterson Fort Collins, CO 80521		
	#185 Brian & Joyce Hahn 422 Peterson Fort Collins, CO 80521		
	#186 William & Sadie Hand 426 Peterson Fort Collins, CO 80521		
	#187 William J. Bertschy 430 Peterson Fort Collins, CO 80521		
	#188 Kenneth & Norma Hilmes 1611 Mathews Fort Collins, CO 80521		
	#189 Alfred & Fannie Coolidge 506 Peterson Fort Collins, CO 80521		
	#190 Harold & Orphea Mummert 508 Peterson Fort Collins, CO 80521		
	#191 Pamela Heldt 512 Peterson Fort Collins, CO 80521		
	#192 Elizabeth Hoffman 518 Peterson Fort Collins, CO 80521		

UNITED STATES DEPARTMENT OF THE INTERIOR
NATIONAL PARK SERVICE

**NATIONAL REGISTER OF HISTORIC PLACES
INVENTORY -- NOMINATION FORM**

FOR NPS USE ONLY

RECEIVED **JAN 29 1980**

DATE ENTERED

CONTINUATION SHEET Owners of Property ITEM NUMBER 4 PAGE 10

#193
Samuel & May Combs
326 E. Myrtle
Fort Collins, CO 80521

#201
Anna Weitzel
603 Peterson
Fort Collins, CO 80521

#209
Donald & Charlene Wood
622 Peterson
Fort Collins, CO 80521

#194
Lloyd & Lillian Lair
524 Peterson
Fort Collins, CO 80521

#202
Edward & June Seitz
1617 Adriel Way
Fort Collins, CO 80521

#210
Everett & Ethel Goodner
625 Peterson
Fort Collins, CO 80521

#195
Isabel Whitlock
520 Peterson
Fort Collins, CO 80521

#203
Solomon & Lydia Deines
605 Peterson
Fort Collins, CO 80521

#211
Sandra Hazelton
628 Peterson
Fort Collins, CO 80521

#196
Helen Garfield
521 Peterson
Fort Collins, CO 80521

#204
United Bank of Fort Collins
c/o Trust Department
401 S. College
Fort Collins, CO 80521

#212
Robert & Barbra Liebler
817 Peterson
Fort Collins, CO 80521

#197
David Propst
523 Peterson
Fort Collins, CO 80521

#205
Helen Lanphere
412 S. Loomis
Fort Collins, CO 80521

#213
Evelyn Foster
631 Peterson
Fort Collins, CO 80521

#198
Lee Smith
525 Peterson
Fort Collins, CO 80521

#206
William Shields
611 Peterson
Fort Collins, CO 80521

#214
Dorothy Frenzel & Lucille
Raggs
632 Peterson
Fort Collins, CO 80521

#199
Irving & Patricia Cross
530 Peterson
Fort Collins, CO 80521

#207
Jack & Wilma Reichert
612 Peterson
Fort Collins, CO 80521

#215
Michael & Jean Charney
635 Peterson
Fort Collins, CO 80521

#200
Seitz Investments
1617 Adriel Way
Fort Collins, CO 80521

#208
Marguerite Vannorsdel, et al.
616 Peterson
Fort Collins, CO 80521

#216
Michael Ort
636 Peterson
Fort Collins, CO 80521

UNITED STATES DEPARTMENT OF THE INTERIOR
NATIONAL PARK SERVICE

NATIONAL REGISTER OF HISTORIC PLACES
INVENTORY -- NOMINATION FORM

FOR NPS USE ONLY

RECEIVED JAN 29 1980

DATE ENTERED

CONTINUATION SHEET	Owners of Property	ITEM NUMBER	PAGE
		4	11
#217 Jonathan Netter 1346 Pearl St. Boulder, CO 80302	#225 Philip & Carmen Martinez 121 E. Willox Lane Fort Collins, CO 80521	#233 Louise & Philemon Rodriquez 805 Peterson Fort Collins, CO 80521	
#218 Jack & Sandra Lundt 640 Peterson Fort Collins, CO 80521	#226 Harriet Sykes c/o General Delivery Oakes, Oklahoma 74359	#234 Harold & Eleanor Owen 806 Peterson Fort Collins, CO 80521	
#219 Maggie Warren 644 Peterson Fort Collins, CO 80521	#227 Joseph and Deland 717 Peterson Fort Collins, CO 80521	#235 Merlyn & Phoebe Paulson 811 Peterson Fort Collins, CO 80521	
#220 Paige Lunberry 1024 E. Lake Fort Collins, CO 80521	#228 Eric Dahlgren 720 Peterson Fort Collins, CO 80521	#236 Donald & Janet Banks 812 Peterson Fort Collins, CO 80521	
#221 Ronald & Susan Maulsby 708 Peterson Fort Collins, CO 80521	#229 Kirk & Mary Kay Herzman 721 Peterson Fort Collins, CO 80521	#237 Thomas & Shirley Kidd 815 Peterson Fort Collins, CO 80521	
#222 United Bank of Fort Collins National Association 401 S. College Ave. Fort Collins, CO 80521	#230 Charles & Angelo Moser 729 Peterson Fort Collins, CO 80521	#238 Ester Crews 816 Peterson Fort Collins, CO 80521	
#223 Peter & Roxanne Olson 711 Peterson Fort Collins, CO 80521	#231 Robert & Judith Mathes 1216 Robertson Fort Collins, CO 80521	#239 Robert & Barbra Liebler 817 Peterson Fort Collins, CO 80521	
#224 Fredrick Cannan 712 Peterson Fort Collins, CO 80521	#232 James Arvidson 1104 E. Bulkey NEDC Castlerock, CO 80104	#240 Thomas Johnston 818 Peterson Fort Collins, CO 80521	

UNITED STATES DEPARTMENT OF THE INTERIOR
NATIONAL PARK SERVICE

**NATIONAL REGISTER OF HISTORIC PLACES
INVENTORY -- NOMINATION FORM**

FOR NPS USE ONLY

RECEIVED JAN 29 1980

DATE ENTERED

CONTINUATION SHEET	Owners of Property	ITEM NUMBER	PAGE
		4	12
#241 Jack & Fae Gardner 820 Peterson Fort Collins, CO 80521	#249 Fort Collins Bible Chapel 201 Whedbee Fort Collins, CO 80521	#257 Paige Lunberry 1024 E. Lake Fort Collins, CO 80521	
#242 Evelyn Biederman 821 Peterson Fort Collins, CO 80521	#250 Robert E. Blake P. O. Box 6217 Port Isabel, Texas 78578	#258 Robert Siblingrud 1304 S. College Fort Collins, CO 80521	
#243 Billy & Laberta Townsend 1519 Remington Fort Collins, CO 80521	#251 Violet E. Thorpe 206 Whedbee Fort Collins, CO 80521	#259 Sharon Fish 1344 Homer Dr. Fort Collins, CO 80521	
#344 Robert Ort, et al. 825 Peterson Fort Collins, CO 80521	#252 Lester Kaplan 207 Whedbee Fort Collins, CO 80521	#260 Blue Moon Enterprises 800 Stover Fort Collins, CO 80521	
#245 Harry & Nora Hehn 828 Peterson Fort Collins, CO 80521	#253 Sidney and Agnes Frease 208 Whedbee Fort Collins, CO 80521	#261 Catherine Chismar 225 Whedbee Fort Collins, CO 80521	
#246 Henry Miles 829 Peterson Fort Collins, CO 80521	#254 Philip C. Dening, estate 211 Whedbee Fort Collins, CO 80521	#262 Tim Holbrook 226 Whedbee Fort Collins, CO 80521	
#247 Elizabeth Greelee 1002 Peterson Fort Collins, CO 80521	#255 Joe Glen Smith, Jr. 3704 N. Taft Hill Rd. Fort Collins, CO 80521	#263 Housing Authority City of Fort Collins 1715 W. Mountain Fort Collins, CO 80521	
#248 Helen James 731 N. Taft Hill Rd. Fort Collins, CO 80521	#256 Berta Berry 215 Whedbee Fort Collins, CO 80521	#264 Catherine Chismar 225 Whedbee Fort Collins, CO 80521	

UNITED STATES DEPARTMENT OF THE INTERIOR
NATIONAL PARK SERVICE

FOR NPS USE ONLY

RECEIVED JAN 29 1980

DATE ENTERED

**NATIONAL REGISTER OF HISTORIC PLACES
INVENTORY -- NOMINATION FORM**

CONTINUATION SHEET Owners of
Property ITEM NUMBER 4 PAGE 13

#265
Grace Bible Church
300 Whedbee
Fort Collins, CO 80521

#273
Alice Barry
318 Whedbee
Fort Collins, CO 80521

#281
Thomas Eaton
408 Whedbee
Fort Collins, CO 80521

#266
Ruth A. Bradley
301 Whedbee
Fort Collins, CO 80521

#274
William Bertschy
319 Whedbee
Fort Collins, CO 80521

#282
Arlington Pearcy
3732 Crescent
Fort Collins, CO 80521

#267
Marqueretta & Albert Hill
305 Whedbee
Fort Collins, CO 80521

#275
Frank & Mary Burke
12 Shogum Rd.
Randolph, New Jersey 07801

#283
Katherine Heckman and
Irene Colwell
414 Whedbee
Fort Collins, CO 80521

#268
Housing Authority
City of Fort Collins
1715 W. Mountain
Fort Collins, CO 80521

#276
June McKlosky
323 Whedbee
Fort Collins, CO 80521

#284
Joe Glen Smith
P. O. Box 2042
Fort Collins, CO 80521

#269
Robert Beckurth
310 Whedbee
Fort Collins, CO 80521

#277
David & Cheryl McCluggage
331 Whedbee
Fort Collins, CO 80521

#285
W. K. Barger
418 Whedbee
Fort Collins, CO 80521

#270
Maurice Somnese
1041 Ponderosa Dr.
P. O. Box 2343
Fort Collins, CO 80521

#278
Jim Norris
407 Gordon
Fort Collins, CO 80521

#286
John and Patricia
MacMillian
419 Whedbee
Fort Collins, CO 80521

#271
Mary Schild
314 Whedbee
Fort Collins, CO 80521

#279
Downtown Church of Christ
400 Whedbee
Fort Collins, CO 80521

#287
Gerald & Judith Frank
422 Whedbee
Fort Collins, CO 80521

#272
Philip Teeter
315 Whedbee
Fort Collins, CO 80521

#280
Mary Saxen
404 Whedbee
Fort Collins, CO 80521

#288
Virginia Beatty
423 Whedbee
Fort Collins, CO 80521

UNITED STATES DEPARTMENT OF THE INTERIOR
NATIONAL PARK SERVICE

FOR NPS USE ONLY

RECEIVED JAN 29 1980

DATE ENTERED

**NATIONAL REGISTER OF HISTORIC PLACES
INVENTORY -- NOMINATION FORM**

CONTINUATION SHEET Owners of
Property ITEM NUMBER 4 PAGE 14

#289
George Frank
637 Whedbee
Fort Collins, CO 80521

#297
Verna Harris
515 Whedbee
Fort Collins, CO 80521

#305
Floyd & Ethel Maxwell
601 Whedbee
Fort Collins, CO 80521

#290
Murray Nabors & Pamela
Collins
1102 Peterson
Fort Collins, CO 80521

#298
Louise Hosack
514 Whedbee
Fort Collins, CO 80521

#306
Jerry & Patricia Hafford
605 Whedbee
Fort Collins, CO 80521

#291
Elmer Wolters & Fred
Baumler
365 Titian Street
Aurora, CO 80011

#299
James Nash
519 N. Grant
Fort Collins, CO 80521

#307
Elmer & Florence Dykeman
608 Whedbee
Fort Collins, CO 80521

#292
Mary Michaud
503 Whedbee
Fort Collins, CO 80521

#300
Terry Endres
521 Whedbee
Fort Collins, CO 80521

#308
James Costello
609 Whedbee
Fort Collins, CO 80521

#293
Jose Trujillo
507 Whedbee
Fort Collins, CO 80521

#301
R. R. Baugh
522 Whedbee
Fort Collins, CO 80521

#309
Francis & Maude Simianer
610 Whedbee
Fort Collins, CO 80521

#294
Shirley Walters
1824 Busch Street
Fort Collins, CO 80521

#302
Editha Leonard
525 Whedbee
Fort Collins, CO 80521

#310
Geraldine Ragsdale
614 Whedbee
Fort Collins, CO 80521

#295
Mary Foehr
511 Whedbee
Fort Collins, CO 80521

#303
Dorothy Finley
528 Whedbee
Fort Collins, CO 80521

#311
Robert & Shirley Dykeman
618 Whedbee
Fort Collins, CO 80521

#296
Louise Hosack
514 Whedbee
Fort Collins, CO 80521

#304
Helen Guffey
600 Whedbee
Fort Collins, CO 80521

#312
Dale Linquist &
Jim Trombley
2620 Killdeer Dr.
Fort Collins, CO 80521

UNITED STATES DEPARTMENT OF THE INTERIOR
NATIONAL PARK SERVICE

FOR NPS USE ONLY

RECEIVED JAN 29 1980

DATE ENTERED

**NATIONAL REGISTER OF HISTORIC PLACES
INVENTORY -- NOMINATION FORM**

CONTINUATION SHEET Owners of
Property ITEM NUMBER 4 PAGE 15

#313
Paul & Theresa Foppe
622 Whedbee
Fort Collins, CO 80521

#321
Gary Lahman
638 Whedbee
Fort Collins, CO 80521

#329
Foursquare Gospel
717 Whedbee
Fort Collins, CO 80521

#314
Mary Marks
625 Whedbee
Fort Collins, CO 80521

#322
Fredrick & Janice Owen
641 Whedbee
Fort Collins, CO 80521

#330
Brent Hawley
720 Whedbee
Fort Collins, CO 80521

#315
Henry Haas, Jr.
626 Whedbee
Fort Collins, CO 80521

#323
Harry & Adeline Rosenberg
642 Whedbee
Fort Collins, CO 80521

#331
Eric & Constance Herman
722 Whedbee
Fort Collins, CO 80521

#316
David & Betty Brown
627 Whedbee
Fort Collins, CO 80521

#324
Wilbur & Sandra Huett
645 Whedbee
Fort Collins, CO 80521

#332
Paul Kelly
801 Whedbee
Fort Collins, CO 80521

#317
Edwin & Margret Frohberg
630 Whedbee
Fort Collins, CO 80521

#325
Louise Kempe
646 Whedbee
Fort Collins, CO 80521

#333
Frances & Ella Anderson
802 Whedbee
Fort Collins, CO 80521

#318
Scott & Erica Vanevery
631 Whedbee
Fort Collins, CO 80521

#326
Mark & Maurine Watson
651 Whedbee
Fort Collins, CO 80521

#334
John Vloyantes
807 Whedbee
Fort Collins, CO 80521

#319
Harold & Reta Brown
634 Whedbee
Fort Collins, CO 80521

#327
Larry Dixon
710 Whedbee
Fort Collins, CO 80521

#335
D & Nancy Plemmons
809 Whedbee
Fort Collins, CO 80521

#320
Martha & Alexander Frank
637 Whedbee
Fort Collins, CO 80521

#328
Charlene Tresner
525 Edwards
Fort Collins, CO 80521

#336
Melvin Nace
814 Whedbee
Fort Collins, CO 80521

UNITED STATES DEPARTMENT OF THE INTERIOR
NATIONAL PARK SERVICE

FOR NPS USE ONLY

RECEIVED JAN 29 1980

DATE ENTERED

NATIONAL REGISTER OF HISTORIC PLACES
INVENTORY -- NOMINATION FORM

CONTINUATION SHEET	Owners of Property	ITEM NUMBER	4	PAGE	16
#337	Mary Thompson 815 Whedbee Fort Collins, CO 80521	#345	Lloyd & Mercedes Garcia 115 Riverside Fort Collins, CO 80521	#353	W. D. & Jennie Holley 135 Circle Drive Fort Collins, CO 80521
#338	James & Leslie Hamilton 817 Whedbee Fort Collins, CO 80521	#346	Alan R. Porter P. O. Box 544 Fort Collins, CO 80521	#354	Merlin & Mary Marquart Rt. #2, Box 26 Brighton, CO 80601
#339	Mary Ann Gideon 821 Whedbee Fort Collins, CO 80521	#347	Guadalupe & Jennie Balderrama 1530 Whedbee Fort Collins, CO 80521	#355	Anna Cattleberry 404 E. Oak Fort Collins, CO 80521
#340	Clara Chaney 831 Whedbee Fort Collins, CO 80521	#348	Theadora Cox P. O. Box 2010 Fort Collins, CO 80521	#356	Dewey Wetzler, et al 622 E. Myrtle Fort Collins, CO 80521
#341	Joanne Clark 901 Whedbee Fort Collins, CO 80521	#349	Paul & Nancy Valentine 322 E. Oak Fort Collins, CO 80521	#357	Gordon & Wreath Lynch 411 E. Oak Fort Collins, CO 80521
#342	Angelo & Velma Moser 729 Peterson Fort Collins, CO 80521	#350	Don & Merleyn Calvin 4505 S. Yosemite #4 Denver, CO 80216	#358	Gregory & Charles Henrickson 415 E. Oak Fort Collins, CO 80521
#343	Bettie Hervey, et al 916 Pitkin Fort Collins, CO 80521	#351	Richard Anderson 401 East Prospect Fort Collins, CO 80521	#359	Tedd & Suzanne Gatteau 334 E. Mulberry Fort Collins, CO 80521
#344	Etta McFie 111 Riverside Fort Collins, CO 80521	#352	Harl Clark 334 East Oak Fort Collins, CO 80521	#360	Ed & Amelia Allen 418 E. Oak Fort Collins, CO 80521

UNITED STATES DEPARTMENT OF THE INTERIOR
NATIONAL PARK SERVICE

FOR NPS USE ONLY

RECEIVED JAN 29 1980

DATE ENTERED

**NATIONAL REGISTER OF HISTORIC PLACES
INVENTORY -- NOMINATION FORM**

CONTINUATION SHEET Owners of
Property ITEM NUMBER 4 PAGE 17

#361
Bill & Nancy Isernhagen
422 E. Oak
Fort Collins, CO 80521

#369
Thomas & Harry Tucker
2225 Charolais
Fort Collins, CO 80521

#377
Anne Gentry
1829 Elm Ct.
Fort Collins, CO 80521

#362
Milton, Hoffman & Lydia
Morrison
1821 W. Drake
Fort Collins, CO 80521

#370
Frank Terrel
1212 Green
Fort Collins, CO 80521

#378
Ponderosa Properties
c/o Paul Lindon
527 S. Whitcomb
Fort Collins, CO 80521

#363
Elmer Marquez
2613 Siver Creek
Fort Collins, CO 80521

#371
Steve Smith
1733 Miramont
Fort Collins, CO 80521

#379
Hearl & Eber Somsel
312 W. Magnolia
Fort Collins, CO 80521

#364
Jack & Marilyn Goodrich
301 E. Olive
Fort Collins, CO 80521

#372
Liston & Barbara Leydendecker
305 E. Magnolia
Fort Collins, CO 80521

#380
Roger & Sherry Malone
320 E. Magnolia
Fort Collins, CO 80521

#365
Hugh & Minne Lake
1041 N. Taft Hill Rd.
Fort Collins, CO 80521

#373
Leslie & Barbara Ball
306 E. Magnolia
Fort Collins, CO 80521

#381
Cora Albright
323 E. Magnolia
Fort Collins, CO 80521

#366
Philip Connolly
317 E. Olive
Fort Collins, CO 80521

#374
Leslie Ball
308 E. Magnolia
Fort Collins, CO 80521

#382
Kent Browning
324 E. Magnolia
Fort Collins, CO 80521

#367
Frank Crist, Jr. &
Frank Crist, II
550 Hamilton Ave.
Palo Alto, Calif 94301

#375
Lois McNees, et al
311 E. Magnolia
Fort Collins, CO 80521

#383
Neil Gabriel
1400 Laporte
Fort Collins, CO 80521

#368
Steve & Bruno Shukis
325 E. Olive
Fort Collins, CO 80521

#376
Hearl & Eber Somsel
312 E. Magnolia
Fort Collins, CO 80521

#384
John Trasher, et al
1000 Sunset
Fort Collins, CO 80521

UNITED STATES DEPARTMENT OF THE INTERIOR
NATIONAL PARK SERVICE

**NATIONAL REGISTER OF HISTORIC PLACES
INVENTORY -- NOMINATION FORM**

FOR NPS USE ONLY

RECEIVED JAN 29 1980

DATE ENTERED

CONTINUATION SHEET	Owners of Property	ITEM NUMBER	PAGE
		4	18
#385 Leador Corporation 622 E. Myrtle Fort Collins, CO 80521	#393 Norman & Gail Ginther Nadine & Robert Harrach 404 Rover Los Alamos, N. Mex. 87544	#401 Violet Poor 324 E. Mulberry Fort Collins, CO 80521	
#386 Don Bosturch 336 E. Magnolia Fort Collins, CO 80521	#394 First Church of God c/o Samuel Combs 326 E. Myrtle Fort Collins, CO 80521	#402 Vivion & Madeline Savage 622 E. Myrtle Fort Collins, CO 80521	
#387 Beverly Bowen 417 E. Magnolia Fort Collins, CO 80521	#395 Samuel & May Combs 326 E. Myrtle Fort Collins, CO 80521	#403 George & Miriam Beach 330 E. Mulberry Fort Collins, CO 80521	
#388 Carl & Eva Bath 1605 W. Mulberry Fort Collins, CO 80521	#396 William & Ann McClelland 616 W. Mulberry Fort Collins, CO 80521	#404 Tedd Gatteau & Kimrel Stuart 334 E. Mulberry Fort Collins, CO 80521	
#389 Charla Tate 425 E. Magnolia Fort Collins, CO 80521	#397 Albert Goodwin 314 E. Mulberry Fort Collins, CO 80521	#405 Arnie & Kathren Gunderson 7423 W. 6th Avenue Lakewood, CO 80215	
#390 Local #1340 of United Brother- hood of Carpenters & Joiners 429 E. Magnolia Fort Collins, CO 80521	#398 Samuel & May Combs 326 E. Myrtle Fort Collins, CO 80521	#406 Nick Lorusso 417 E. Mulberry Fort Collins, CO 80521	
#391 Jack Colwell 500 East Magnolia Fort Collins, CO 80521	#399 Ramona & Eugene Parker 320 E. Mulberry Fort Collins, CO 80521	#407 Russell Draves 503 East Mulberry Fort Collins, CO 80521	
#392 Walter & Arline Boyes Donald & Ruth Jackson 1345 W. Mountain Avenue Fort Collins, CO 80521	#400 Samuel & May Combs 326 E. Myrtle Fort Collins, CO 80521	#408 Norman Ginther & Nadine Harrach 214 E. Myrtle Fort Collins, CO 80521	

UNITED STATES DEPARTMENT OF THE INTERIOR
NATIONAL PARK SERVICE

FOR NPS USE ONLY

RECEIVED JAN 29 1980

DATE ENTERED

NATIONAL REGISTER OF HISTORIC PLACES
INVENTORY -- NOMINATION FORM

CONTINUATION SHEET	Owners of Property	ITEM NUMBER	4	PAGE	19
#409	Hossein Shokouh c/o Real Estate Management P. O. Box 1726 Fort Collins, CO 80521	#417	Samuel & May Combs 326 E. Myrtle Fort Collins, CO 80521	#425	Jane E. Kuhre 411 E. Laurel Fort Collins, CO 80521
#410	Arvin & Judith Lovaas 304 E. Myrtle Fort Collins, CO 80521	#418	Jeane McBride 1608 Sheely Dr. Fort Collins, CO 80521	#426	S. L. & Gladys Crawford 412 E. Laurel Fort Collins, CO 80521
#411	Helen Woodward 308 E. Myrtle Fort Collins, CO 80521	#419	Marco & Linda Ballarin 317 E. Laurel Fort Collins, CO 80521	#427	United Bank of Ft. Collins c/o Trust Department 401 S. College Avenue Fort Collins, CO 80521
#412	Douglas & Barbara Wree 312 E. Myrtle Fort Collins, CO 80521	#420	Paige Lunberry, et al 1024 E. Lake Fort Collins, CO 80521	#428	Paige Evans 419 E. Laurel Fort Collins, CO 80521
#413	Mattison & Grace Thornburg 318 E. Myrtle Fort Collins, CO 80521	#421	Beulah Burnett 325 E. Laurel Fort Collins, CO 80521	#429	Margaret Morgan, et al 421 E. Laurel Fort Collins, CO 80521
#414	Gary Ross 2100 Sherrel Drive Fort Collins, CO 80521	#422	School District #5 2701 Laporte Ave. Fort Collins, CO 80521	#430	Harvey & Viola Crockett 425 E. Laurel Fort Collins, CO 80521
#415	Samuel & May Combs 326 E. Myrtle Fort Collins, CO 80521	#423	George & Annie Romero 401 E. Laurel Fort Collins, CO 80521	#431	Foursquare Gospel 717 Whedbee Fort Collins, CO 80521
#416	Carl Skold & Ester Frazier 321 East Myrtle Fort Collins, CO 80521	#424	Paige Lunberry 419 E. Laurel Fort Collins, CO 80521	#432	Lois Dunigan 1301 West Mountain Fort Collins, CO 80521

UNITED STATES DEPARTMENT OF THE INTERIOR
NATIONAL PARK SERVICE

FOR NPS USE ONLY

RECEIVED JAN 29 1980

DATE ENTERED

NATIONAL REGISTER OF HISTORIC PLACES
INVENTORY -- NOMINATION FORM

CONTINUATION SHEET Owners of
Property ITEM NUMBER 4 PAGE 20

#433
Caroline Urvater
315 S. Loomis
Fort Collins, CO 80521

#441
Ted & Nancy Beers
311 E. Plum
Fort Collins, CO 80521

#449
Gordon Morthole
1200 Newsom
Fort Collins, CO 80521

#434
Paul F. Harder
704 Garfield
Fort Collins, CO 80521

#442
Jack D. Hutchison
315 E. Plum
Fort Collins, CO 80521

#450
Rosalind McWilliams
330 E. Plum
Fort Collins, CO 80521

#435
James & Olive Haning
205 E. Plum
Fort Collins, CO 80521

#443
Joyce Harper
316 E. Plum
Fort Collins, CO 80521

#451
Richard D. Acott
220 Smith
Fort Collins, CO 80521

#436
Jack and Jill Child Develop-
ment Center, Inc.
209 E. Plum
Fort Collins, CO 80521

#444
United Bank of Fort Collins
Trustee (Stallings)
P. O. Box 565
Fort Collins, CO 80521

#452
Housing Authority
City of Fort Collins
1715 W. Mountain
Fort Collins, CO 80521

#437
Claude & Katherine Hefline
219 E. Plum
Fort Collins, CO 80521

#445
Thomas L. Feeney, Jr.
1119 Pearl Street
Denver, CO 80203

#453
Gail, Frances & Linda
Washecka
412 E. Plum
Fort Collins, CO 80521

#438
Claude & Katherine Hefline
223 E. Plum
Fort Collins, CO 80521

#446
Bennett & Anne Manvel
323 E. Plum
Fort Collins, CO 80521

#454
Harold Busch
c/o Lena Busch
Fort Collins, CO 80521

#439
Otto Christman
P. O. Box 1808
Fort Collins, CO 80522

#447
Robert & Margaret Komives
324 E. Plum
Fort Collins, CO 80521

#455
Henrietta & Richard
Cullinane
416 E. Plum
Fort Collins, CO 80521

#440
Dean & Olivia Rud
307 E. Plum
Fort Collins, CO 80521

#448
Antonio & Dalores Lopez
326 E. Plum
Fort Collins, CO 80521

#456
Georgia Colter
1029 W. Oak
Fort Collins, CO 80521

UNITED STATES DEPARTMENT OF THE INTERIOR
NATIONAL PARK SERVICE

**NATIONAL REGISTER OF HISTORIC PLACES
INVENTORY -- NOMINATION FORM**

FOR NPS USE ONLY

RECEIVED JAN 29 1980

DATE ENTERED

CONTINUATION SHEET

Owners of
Property

ITEM NUMBER 4

PAGE 21

#457
Edward & Viola Miller
420 E. Plum
Fort Collins, CO 80521

#465
Henry Bronewoller
210 E. Elizabeth
Fort Collins, CO 80521

#473
Damien & Rosanne Koch
325 E. Elizabeth
Fort Collins, CO 80521

#458
William & Esther Schilling
423 E. Plum
Fort Collins, CO 80521

#466
Fredrick Eidsness
214 E. Elizabeth
Fort Collins, CO 80521

#474
Ruth Bates
11 Palomino Drive
Yerington, Nevada 89447

#459
Erma Davis
424 E. Plum
Fort Collins, CO 80521

#467
Beverly Denna
215 E. Elizabeth
Fort Collins, CO 80521

#475
Harold & Wilma Camden
339 E. Elizabeth
Fort Collins, CO 80521

#460
Walter & Jo Ann Hoerler
1516 Brentwood
Fort Collins, CO 80521

#468
Kathryn Elliott
219 E. Elizabeth
Fort Collins, CO 80521

#476
Gilbert & Jean Findlay
400 E. Elizabeth
Fort Collins, CO 80521

#461
Harry Kausalik
722 East Elizabeth
Fort Collins, CO 80521

#469
Ronald Heddles
220 E. Elizabeth
Fort Collins, CO 80521

#477
Suzanne Gatteau
408 E. Elizabeth
Fort Collins, CO 80521

#462
Robert Sides
257 Ocean Ave.
Marblehead, Mass. 01945

#470
Paul & Mary Bates
609 Duke Lane
Fort Collins, CO 80521

#478
Elizabeth Greenlee
1002 Peterson
Fort Collins, CO 80521

#463
Victoria, Ltd.
202 Remington
Fort Collins, CO 80521

#471
Windell Kilmer
300 E. Elizabeth
Fort Collins, CO 80521

#479
Bryan Siegrist
2206 Ouray Court
Fort Collins, CO 80521

#464
Esther Ardveser
206 E. Elizabeth
Fort Collins, CO 80521

#472
Victor & Margaret Santini
310 E. Elizabeth
Fort Collins, CO 80521

#480
Clifford & Pauline
Bymaster
P. O. Box 190
Wellington, CO 80549

UNITED STATES DEPARTMENT OF THE INTERIOR
NATIONAL PARK SERVICE

**NATIONAL REGISTER OF HISTORIC PLACES
INVENTORY -- NOMINATION FORM**

FOR NPS USE ONLY

RECEIVED JAN 29 1980

DATE ENTERED

CONTINUATION SHEET	Owners of Property	ITEM NUMBER	4	PAGE	22
#481 Estella McCutcheon 414 East Elizabeth Fort Collins, CO 80521	#489 Bernice & Elton Doughty 121 East Garfield Fort Collins, CO 80521	#497 Clara Anderson & Willa Swackhammer 316 East Garfield Fort Collins, CO 80521			
#482 Linda Brown 415 East Elizabeth Fort Collins, CO 80521	#490 Wayne & Elsie Anderson 206 East Garfield Fort Collins, CO 80521	#498 Lawrence & Jenny Tomek 321 East Garfield Fort Collins, CO 80521			
#483 Cora Warren Estate % Poudre Valley National Bank, Executor Post Office Box 565 Fort Collins, CO 80521	#491 Nick J. Lorusso 214 East Garfield Fort Collins, CO 80521	#499 United Bank of Fort Collins Trustee Della Baughman 401 South College Fort Collins, CO 80521			
#484 Robert & Mary Tapply Post Office Box 294 Fort Collins, CO 80522	#492 Gilbert Carbaval 3612 Richmond Fort Collins, CO 80521	#500 Paul Soraci 325 East Garfield Fort Collins, CO 80521			
#485 Eleanor Hoag Box 6528 Hampton Insti- tute Hampton, Virginia 23368	#493 Leslie & Anna Gibbons 304 East Garfield Fort Collins, CO 80521	#501 Bernard & Robin Marzonie 326 East Garfield Fort Collins, CO 80521			
#486 A. S. & Ann Turner 425 East Elizabeth Fort Collins, CO 80521	#494 St. John's Evangelical Lutheran Church of Fort Collins 305 East Elizabeth Fort Collins, CO 80521	#502 Donald Moore 327 Garfield Fort Collins, CO 80521			
#487 J. W. & Lillie Byers 428 East Elizabeth Fort Collins, CO 80521	#495 Dorothy McKean 312 East Garfield Fort Collins, CO 80521	#503 John Barlow 331 East Garfield Fort Collins, CO 80521			
#488 Insle & Ingrid Matzner 430 East Elizabeth Fort Collins, CO 80521	#496 Diane Lampers 26 East Street Hadley, Massachussetts 01035	#504 Larry Archer % Donald Crim 336 East Garfield Fort Collins, CO 80521			

UNITED STATES DEPARTMENT OF THE INTERIOR
NATIONAL PARK SERVICE

**NATIONAL REGISTER OF HISTORIC PLACES
INVENTORY -- NOMINATION FORM**

FOR NPS USE ONLY

RECEIVED JAN 21 1980

DATE ENTERED

CONTINUATION SHEET

Owners of
Property

ITEM NUMBER 4

PAGE 23

#505
Sybil Hendrick
406 East Garfield
Fort Collins, CO 80521

#513
Nannie Liggett &
Shirley Johnson
423 Garfield
Fort Collins, CO 80521

#521
Nona & Gordon Woelfle
300 Edwards
Fort Collins, CO 80521

#506
Leonard Moore
409 East Garfield
Fort Collins, CO 80521

#514
William Wilkinson
429 South Whitcomb
Fort Collins, CO 80521

#522
Noma Santacroce
1202 Mathews
Fort Collins, CO 80521

#507
Doris Ramsey

Zearing, Iowa 50278

#515
Joan Landy
701 Gregory Road
Fort Collins, CO 80521

#523
Scott Billington
4630 Venture Lane
Fort Collins, CO 80521

#508
Betty Asmus, et. al.
2229 Stanford Road
Fort Collins, CO 80521

#516
Ernest & Christine Giffen
430 East Garfield
Fort Collins, CO 80521

#524
Duane & Norma Iossi
310 East Edwards
Fort Collins, CO 80521

#509
Douglas & Mary DeMasters
2919 Rocky Mountain Court
Fort Collins, CO 80521

#517
John & Mary Miller
215 East Edwards
Fort Collins, CO 80521

#525
Charles & Lurline Dolezal
6740 South Foresthill St.
Littleton, CO 80120

#510
Carl & Frances Petersen
620 Verde Avenue
Fort Collins, CO 80521

#518
Herbert W. Martens
Post Office Box 605
Laughlin, Nevada 89046

#526
Robert Butler
313 East Edwards
Fort Collins, CO 80521

#511
Wayne Ganer
1317 East Mulberry
Fort Collins, CO 80521

#519
Theodore Baratt, et. al.
221 East Edwards
Fort Collins, CO 80521

#527
Timothy, Melvin & Darleen
Conine
314 East Edwards
Fort Collins, CO 80521

#512
Robert & Sharon Shilling
420 Garfield
Fort Collins, CO 80521

#520
Hilda Wunsch
225 East Edwards
Fort Collins, CO 80521

#528
Charles Cole &
Brenda Ross
3312 Shore Road
Fort Collins, CO 80521

UNITED STATES DEPARTMENT OF THE INTERIOR
NATIONAL PARK SERVICE

**NATIONAL REGISTER OF HISTORIC PLACES
INVENTORY -- NOMINATION FORM**

FOR NPS USE ONLY

RECEIVED **JAN 29 1980**

DATE ENTERED

CONTINUATION SHEET

Owners of
Property

ITEM NUMBER 4 PAGE 24

#529 Jake Wunch, et. al. 615 West Mountain Avenue Fort Collins, CO 80521	#537 Robert & Page Smith 1184 Teakwood Drive Fort Collins, CO 80521	#545 Wilma Robinson, et. al. 338 East Pitkin Fort Collins, CO 80521
#530 Thomas & Prudence Whitaker 321 East Edwards Fort Collins, CO 80521	#538 Edward Williams 300 East Pitkin Fort Collins, CO 80521	#546 City of Fort Collins 300 Laporte Fort Collins, CO 80521
#531 Ralph Mills & Terry Tucker 1025 Maple Fort Collins, CO 80521	#539 James & Lavonne Gardener 601 Fossil Creek Drive Fort Collins, CO 80521	#547 City of Fort Collins 300 Laporte Fort Collins, CO 80521
#532 Donna Hughes & Marie 326 East Edwards /Schrader Fort Collins, CO 80521	#540 Harold & Lila Kuemmerlin 5819 East Highway, #14 Fort Collins, CO 80521	#548 City of Fort Collins 300 Laporte Fort Collins, CO 80521
#533 Anita Wright 332 East Edwards Fort Collins, CO 80521	#541 William Budge 312 East Pitkin Fort Collins, CO 80521	#549 City of Fort Collins 300 Laporte Fort Collins, CO 80521
#534 S. J. & Iva Shoffner 335 East Edwards Fort Collins, CO 80521	#542 William Budge 312 East Pitkin Fort Collins, CO 80521	#550 Georgia A. Kochendecker 1107 Mathews Fort Collins, CO 80521
#535 Steven Pickelner, et. al. 736 Stuart Street Fort Collins, CO 80521	#543 Robert Hoel 2712 Parklane Drive Fort Collins, CO 80521	#551 Mona Santacroce 1202 Mathews Fort Collins, CO 80521
#536 Frederic Eidsness 214 East Elizabeth Fort Collins, CO 80521	#544 Patrick & Sean Sullivan 322 East Pitkin Fort Collins, CO 80521	#552 Donald & Patricia Wunsch 1209 Mathews Fort Collins, CO 80521

UNITED STATES DEPARTMENT OF THE INTERIOR
NATIONAL PARK SERVICE

NATIONAL REGISTER OF HISTORIC PLACES
INVENTORY -- NOMINATION FORM

FOR NPS USE ONLY

RECEIVED JAN 29 1980

DATE ENTERED

CONTINUATION SHEET	Owners of Property	ITEM NUMBER	4	PAGE 25
#553 Marilyn Fender 528 Taft Hill Road Fort Collins, CO 80521	#561 Fredrick Taylor 820 Whedbee Fort Collins, CO 80521	#569 Fanny Smith 220 East Myrtle Fort Collins, CO 80521		
#554 Jane Goodwin, et. al. 314 East Mulberry Fort Collins, CO 80521	#562 Vivian Ray 415 South Whitcomb Fort Collins, CO 80521	#570 Albert Dumler 322 East Myrtle Fort Collins, CO 80521		
#555 Anna Flessner 405 Peterson Fort Collins, CO 80521	#563 James Banghart, et. al. Post Office Box 582 Fort Collins, CO 80522	#571 Katie Heinrich 132 First Street Fort Collins, CO 80521		
#556 Ada Siedow 725 Peterson Fort Collins, CO 80521	#564 A. C. & Eva Weismiller 411 East Olive Fort Collins, CO 80521	#572 David & Barbara Hawes 5430 Fossil Creek Drive Fort Collins, CO 80521		
#557 Murray Nabors et. al. 1102 Peterson Fort Collins, CO 80521	#565 Freda Darras 412 East Olive Fort Collins, CO 80521	#573 Clarence Junge 232 Fish Back Fort Collins, CO 80521		
#558 Josie Scrivner 524 Whedbee Fort Collins, CO 80521	#566 Ruth Bradley 301 Whedbee Fort Collins, CO 80521	#574 Donald Schoonover 910 Mathews Fort Collins, CO 80521		
#559 Leona Kunkler 613 Whedbee Fort Collins, CO 80521	#567 Leo & Anne Lane 416 East Magnolia Fort Collins, CO 80521	#575 Robert Ochletree 312 East Locust Fort Collins, CO 80521		
#560 Robert Decarous 812 Whedbee Fort Collins, CO 80521	#568 John Fugitt & Stephanie Brown 420 East Magnolia Fort Collins, CO 80521	#576 Donald Schoonover Suite 301 First National Bank Bldg. Fort Collins, CO 80521		

UNITED STATES DEPARTMENT OF THE INTERIOR
NATIONAL PARK SERVICE

NATIONAL REGISTER OF HISTORIC PLACES
INVENTORY -- NOMINATION FORM

FOR NPS USE ONLY

RECEIVED JAN 29 1980

DATE ENTERED

CONTINUATION SHEET	Owners of Property	ITEM NUMBER	PAGE
		4	26
#577 J. A. McDowell 320 East Locust Fort Collins, CO 80521	#585 Mabel Hixson 416 East Locust Fort Collins, CO 80521	#593 James & Susan Rhoades 1700 North Overland Trail Fort Collins, CO 80521	
#578 Donald Schoonover Suite 301 First National Bank Bldg. Fort Collins, CO 80521	#586 Arva Gether 416 East Locust Fort Collins, CO 80521	#594 George Lambert 320 Elizabeth Fort Collins, CO 80521	
#579 J. A. McDowell 320 East Locust Fort Collins, CO 80521	#587 Michale Te Maat 501 East Locust Fort Collins, CO 80521	#595 T and T Rentals 924 Sailors Reef Fort Collins, CO 80521	
#580 Elvin Hibbert Box 1942 Steamboat Springs, CO 80477	#588 Martin Falk Post Office Box 330 Fort Collins, CO 80522	#596 Dixie Spicer 330 East Elizabeth Fort Collins, CO 80521	
#581 L. L. & Leone Doss 325 East Locust Fort Collins, CO 80521	#589 A. M. Oscamp, Jr. % Triangle Fraternity of C.S.U. 406 West Laurel Fort Collins, CO 80521	#597 Paige & Delores Lunberry 1024 East Lake Fort Collins, CO 80521	
#582 Stanley Sepulbeda 329 East Locust Fort Collins, CO 80521	#590 Orville Eckman 1408 Emigh Fort Collins, CO 80521	#598 United Bank of Fort Collins 401 South College Fort Collins, CO 80521	
#583 Windell & Rosemary Kilmer 331 East Locust Fort Collins, CO 80521	#591 Kenneth & Susan Hilt 2240 North Taft Hill Road Fort Collins, CO 80521	#599 Laura Price & Jean King 500 South College Fort Collins, CO 80521	
#584 Alice Feit, et. al. 335 East Locust Fort Collins, CO 80521	#592 Pearl Ericson 1002 Akin Street Fort Collins, CO 80521	#600 Susan Blehm Route #1, Box 150 Windsor, CO 80550	

UNITED STATES DEPARTMENT OF THE INTERIOR
NATIONAL PARK SERVICE

FOR NPS USE ONLY

RECEIVED JAN 29 1980

DATE ENTERED

**NATIONAL REGISTER OF HISTORIC PLACES
INVENTORY -- NOMINATION FORM**

CONTINUATION SHEET	Owners of Property	ITEM NUMBER	4	PAGE	27
#601 Michael & Susan Josephs 411 Elizabeth Fort Collins, CO 80521	#609 St. John's Church 305 East Elizabeth Fort Collins, CO 80521	#617 Nabi & Suzanne Jaskin 214 Pitkin Fort Collins, CO 80521			
#602 Stanley & Reva Jarman 419 East Elizabeth Fort Collins, CO 80521	#610 Jean Marsh 309 East Garfield Fort Collins, CO 80521	#618 Larry Abrahamson 3118 Meadowlark Drive Fort Collins, CO 80521			
#603 Bryce & Irene Tracy 427 East Elizabeth Fort Collins, CO 80521	#611 Mary Williams 319 Garfield Fort Collins, CO 80521	#619 William Raddatz 104 Columbia Road Fort Collins, CO 80521			
#604 Elizabeth Cross 502 East Elizabeth Fort Collins, CO 80521	#612 Artie Colvin 323 Garfield Fort Collins, CO 80521	#620 William Ferguson 414 East Lake Fort Collins, CO 80521			
#605 Robert Snedeker 140 8 Pikes Peak Drive Fort Collins, CO 80521	#613 Robert Browning 10205 Ski Drive Oklahoma City, OK 73125	#621 First National Bank, Fort Collins, Trustee Willia Cameron 205 West Oak Fort Collins, CO 80521			
#606 Edward Hamil 204 East Garfield Fort Collins, CO 80521	#614 Nannie & Orville Liggett 423 Garfield Fort Collins, CO 80521	#622 One-Twenty-Nine Investment Group 914 East College Fort Collins, CO 80521			
#607 Kermit Nuckles 1110 Remington Street Fort Collins, CO 80521	#615 Katherine Marquardt 329 East Edwards Fort Collins, CO 80521	#623 Chauncey Yancey % Nick Perna 1513 Teakwood Court Fort Collins, CO 80521			
#608 Harold Aldredge 301 Garfield Fort Collins, CO 80521	#616 Joy Weeks % Larimer County Realty Post Office Box 214 Fort Collins, CO 80521	#624 SCT Investments 3820 South County Road #4 Fort Collins, CO 80521			

UNITED STATES DEPARTMENT OF THE INTERIOR
NATIONAL PARK SERVICE

FOR NPS USE ONLY

RECEIVED JAN 29 1980

DATE ENTERED

**NATIONAL REGISTER OF HISTORIC PLACES
INVENTORY -- NOMINATION FORM**

CONTINUATION SHEET	Owners of Property	ITEM NUMBER	4	PAGE 28
#625	Alan Porter Post Office Box 544 Fort Collins, CO 80521	#633 Hossein Shokah % Real Estate Management Suite 990 Savings Building Fort Collins, CO 80521	#641 Clifford Hohn 2211 West Mulberry Fort Collins, CO 80521	
#626	Hal-Mor Engerprises 604 Remington Fort Collins, CO 80521	#634 Larimer County Youth Homes 614 Mathews Fort Collins, CO 80521	#642 Salvation Army 900 Peterson Fort Collins, CO 80521	
#627	Alan R. Porter 608 Heather Court Fort Collins, CO 80521	#635 Cottonwoods, Co. 620 Mathews Fort Collins, CO 80521	#643 Steven Pickelner & Terry Haas 736 Stuart Street Fort Collins, CO 80521	
#628	Richard Bartlett Post Office Box 2381 Fort Collins, CO 80521	#636 Claude & Alma Wuther 3425 Terry Ridge Road Fort Collins, CO 80521	#644 Peter Sewald 621 Whedbee Fort Collins, CO 80521	
#629	Arnold Sanderson 2224 Purdue Road Fort Collins, CO 80521	#637 Poudre R-1 School District 2701 LaPorte Avenue Fort Collins, CO 80521	#645 Douglas Vost 806 Whedbee Fort Collins, CO 80521	
#630	Kermit & Mary Knuckles 1110 Remington Fort Collins, CO 80521	#638 George & Helen Stovall 2909 West Mulberry Fort Collins, CO 80521	#646 Francis Richard 1001 Whedbee Fort Collins, CO 80521	
#631	Sherrie Rawer 416 Mathews Fort Collins, CO 80521	#639 Robert Conger % F. C. Investment Company 301 Peterson #211 Fort Collins, CO 80521	#647 Guy Gebron 7102 North 23rd Way Phoenix, AZ 85020	
#632	First Church of God 500 Mathews Fort Collins, CO 80521	#640 John Hill 2324 Tanglewood Fort Collins, CO 80521	#648 Frank Terrel 1212 Green Fort Collins, CO 80521	

UNITED STATES DEPARTMENT OF THE INTERIOR
NATIONAL PARK SERVICE

**NATIONAL REGISTER OF HISTORIC PLACES
INVENTORY -- NOMINATION FORM**

FOR NPS USE ONLY

RECEIVED JAN 29 1980

DATE ENTERED

CONTINUATION SHEET	Owners of Property	ITEM NUMBER 4	PAGE 29
#649 SCT Investments 3820 South Country Road #11 Fort Collins, CO 80521	#654-4 Mary Hampton Estate % Lloyd Hampton Box 145 Walden, CO 80480		#658 Long Apartments, Limited % R. L. Anderson & H. O. Nornes 315 West Oak, #102 Fort Collins, CO 80521
#650 T-J Investments 220 East Mulberry Fort Collins, CO 80521	#654-5 Virginia Norton Apartment 5 200 East Myrtle Fort Collins, CO 80521		#659 Daniel Scariano 111 East Plum Fort Collins, CO 80521
#651 Carl Backes, Jr. 2201 Hiawatha Court Fort Collins, CO 80521	#654-6 Edith Cuffman Apartment 6 200 East Myrtle Fort Collins, CO 80521		#660 St. John's Church 305 East Elizabeth Fort Collins, CO 80521
#652 Robert Hoel 2712 Parklane Drive Fort Collins, CO 80521	#654-7 Adline Rabbe & C. A. Hershner Apartment 7 200 East Myrtle Fort Collins, CO 80521		#661 Jeanne Sprague % 202 East Edwards Fort Collins, CO 80521
#653 NO OWNER	#654-8 Walter & Jean Gilmore Apartment 8 200 East Myrtle Fort Collins, CO 80521		#662 Michael Barlage 320 Edwards Fort Collins, CO 80521
#654-1 Helen B. McIver Apartment 1 200 East Myrtle Fort Collins, CO 80521	#655 Florence Moore 1519 Peterson Fort Collins, CO 80521		#663 Thomas Whittaker 321 Edwards Fort Collins, CO 80521
#654-2 Cloyd Huston Apartment 2 200 East Myrtle Fort Collins, CO 80521	#656 Monna Ross & Margret Sherman 309 East Myrtle Fort Collins, CO 80521		#664 City of Fort Collins 300 LaPorte Fort Collins, CO 80521
#654-3 % Ermell Hilliard Apartment 3 200 East Myrtle Fort Collins, CO 80521	#657 Kensington Properties Limited % Stanley Black Post Office Box 1345 Boulder, CO 80302		#665 City of Fort Collins 300 LaPorte Fort Collins, CO 80521

UNITED STATES DEPARTMENT OF THE INTERIOR
NATIONAL PARK SERVICE

NATIONAL REGISTER OF HISTORIC PLACES
INVENTORY -- NOMINATION FORM

FOR NPS USE ONLY

JUN 30 1980

RECEIVED

DATE ENTERED

CONTINUATION SHEET	Owners of Property	ITEM NUMBER	PAGE
#20	Douglas M., Molly, and Todd D. Murray 505 E. Laurel Fort Collins, CO 80524	#68	Ida M. Lane 1016 Remington Fort Collins, CO 80521
#23	Richard & Shirley Sinclair 2107 Essex Court Fort Collins, CO 80521	#104	Terry R. Johnson 7698 Lincoln Way Denver, CO 80221
#27	Donald R. Mitchell Margaret M. Hopkinson 604 Garfield St. Fort Collins, CO 80521	#105	Jo Ellen Metz Bald Mountain Road P.O. Box 208; RD #6 Troy, N.Y. 12180
#28	Alan R. Porter 608 Heather Court Fort Collins, CO 80525	#110	Leonard P. & Jeri P. Zane 915 W. Mountain Fort Collins, CO 80521
#32	B. R. Sabey Elaine B. Sabey 640 Remington St. Fort Collins, CO 80521	#111	Samuel T. Combs 326 E. Myrtle St. Fort Collins, CO 80524
#36	Richard & Martha Bartlett c/o M.P. Breth 1625 W. Elizabeth Fort Collins, CO 80521	#112	James M. Bittle & Penny Bittle P.O. Box 1519 Fort Collins, CO 80522
#56	Oguz Nayman 1601 Germantown Court Fort Collins, CO 80521	#115	Collins Investments 1501 Lemay #102 Fort Collins, CO 80521
#61	James Hatfield 904 Remington Fort Collins, CO 80521	#116	Christopher Munford P.O. Box 1342 Fort Collins, CO 80521
		#124	Eric & Marlene Will 717 Mathews Fort Collins, CO 80524
		#133	Dean M. Rud C. Olivia Rud Roy A. Rud 307 E. Plum Fort Collins, CO 80521
		#182	William & Luella Albrecht 412 Peterson Fort Collins, CO 80521
		#164	W.D. & Jean Faye Holley Rt. #1 Livermore, CO 80536
		#196	Judith Lynn Perdue Walter A. Perdue Lillian B. Anderson 4700 Player Drive Fort Collins, CO 80521
		#197	James R. & Alene E. Starkey 404 Flicker Drive Fort Collins, CO 80526
		#211	Sandra D. Hazelton 628 Peterson Fort Collins, CO 80521
		#218	Jack W. & Sandra L. Lundt 640 Peterson Fort Collins, CO 80524

UNITED STATES DEPARTMENT OF THE INTERIOR
NATIONAL PARK SERVICE

NATIONAL REGISTER OF HISTORIC PLACES
INVENTORY -- NOMINATION FORM

FOR NPS USE ONLY

JUN 30 1980

RECEIVED

DATE ENTERED

CONTINUATION SHEET Owners of Property ITEM NUMBER PAGE 2

#226
Harriet A. Sykes
716 Peterson St.
Fort Collins, CO 80524

#228
Thomas Collup
2857 Waterdale Rd.
Loveland, CO 80537

#252
Lester M. Kaplan
812 E. Elizabeth
Fort Collins, CO 80524

#255
Leo Carroll &
Michele McLaughlin
212 Whedbee
Fort Collins, CO 80524

#285
W. K. Barger
418 Whedbee
Fort Collins, CO 80521

#293
Jose Trujillo
1917 Mohawk
Fort Collins, CO 80521

#296
Louise Hosack
514 Whedbee
Fort Collins, CO 80521

#299
Jare H. Jensen
519 Whedbee Street
Fort Collins, CO 80521

#298
Louise Hosack
514 Whedbee Street
Fort Collins, CO 80521

#316
David S. Brown
Betty L. Brown
2237 Apache Court
Fort Collins, CO 80525

#327
Larry/Lyla Dixon
c/o Herb Carlson
P.O. Box 1184
Fort Collins, CO 80522

#354
Merlin & Mary Marquart
Rt. #2, Box 26
Brighton, CO 80601

#385
Leador Corporation
622 E. Myrtle
Fort Collins, CO 80521

#386
Richard A. Simonds
Nadine P. Simonds
Frederic W. Simonds
336 E. Magnolia
Fort Collins, CO 80521

#389
Charla H. Tate
425 E. Magnolia
Fort Collins, CO 80521

#402
Vivion & Madeline Savage
622 E. Myrtle
Fort Collins, CO 80521

#408
Norman Ginther
Nadine Harrach
404 Rover
Los Alamos, NM 87544

#432
Lois P. & William C. Dunigan
1831 E. Yale Drive
Tempe, AZ 85283

#442
Jack D. Hutchison
315 E. Plum
Fort Collins, CO 80524

#454
Karl F. Wombacher
Margerat A. Wombacher
415 Plum
Fort Collins, CO 80521

#456
Georgia M. Colter
1029 W. Oak
Fort Collins, CO 80521

#460
Walter & JoAnn Hoerler
209 Camino Real
Fort Collins, CO 80524

#465
Henry Bronewoller
210 E. Elizabeth
Fort Collins, CO 80521

#466
Frederick Eidsness
214 E. Elizabeth
Fort Collins, CO 80521

UNITED STATES DEPARTMENT OF THE INTERIOR
NATIONAL PARK SERVICE

NATIONAL REGISTER OF HISTORIC PLACES
INVENTORY -- NOMINATION FORM

FOR NPS USE ONLY

RECEIVED

JUN 30 1980

DATE ENTERED

CONTINUATION SHEET	Owners of Property	ITEM NUMBER	PAGE 3
#467	Beverly Jean Denna 2 Otter Lane North Oaks, MN 55110	#508 Lawrence M. Kendall Patricia A. Kendall 807 Warren Landing Fort Collins, CO 80525	#589 A.M. Oscamp, Jr. 1519 W. Mulberry Street Fort Collins, CO 80521
#469	Ronald Heddles 220 E. Elizabeth Fort Collins, CO 80521	#511 Wayne W. Ganek 1317 E. Mulberry Fort Collins, CO 80524	#591 Kenneth C. Hilt Susan J. Hilt 2240 N. Taft Hill Road Fort Collins, CO 80521
#473	Damien & Rosanne Koch 325 E. Elizabeth Fort Collins, CO 80524	#527 Timothy, Melvin, & Darleen Conine 314 Edwards Fort Collins, CO 80521	#583 Windell & Rosemary Kilmer 331 Locust Fort Collins, CO 80524
#482	Jean Lawrence 518 S. Cataline #G Redondo Beach, CA 90278	#530 Thomas & Prudence Whittaker 420 Apple Blossom Lane Fort Collins, CO 80526	#593 James & Susan Rhoades 1700 N. Overland Tr. Fort Collins, CO 80521
#485	Eleanor Hoag 424 E. Elizabeth St. Fort Collins, CO 80524	#536 Frederic Eidsness 214 S. Elizabeth Fort Collins, CO 80525	#600 Ronald E. Blehm Route #1; Box 150 Windsor, CO 80550
#492	Gilbert Carbajal 650 Mathews St. Fort Collins, CO 80521	#544 Carol J. Sullivan 322 Pitkin Street Fort Collins, CO 80524	#618 Jimmy Allen 220 E. Pitkin Street Fort Collins, CO 80524
#498	Lawrence & Jenny Tomek 321 Garfield Fort Collins, CO 80521	#574 Dale Eggleston 1213 Teakwood Drive Fort Collins, CO 80525	#626 Hal-Mor Enterprises 604 Remington #1 Fort Collins, CO 80521
#504	Donald & Patricia Crim Rt. #1 Ault, CO 80610	#576 Dale K. & Mary F. Eggleston 1213 Teakwood Drive Fort Collins, CO 80525	#631 Donald Eugene White c/o Winnie Ulrich 6809 E. County Road Wellington, CO 80549
#505	Mel Burnett & Kathleen Parker 406 Garfield St. Fort Collins, CO 80524	#578 Dale Eggleston 1213 Teakwood Dr. Fort Collins, CO 80525	#639 F.C. Investment Co. P.O. Box 7 Fort Collins, CO 80522

UNITED STATES DEPARTMENT OF THE INTERIOR
NATIONAL PARK SERVICE

**NATIONAL REGISTER OF HISTORIC PLACES
INVENTORY -- NOMINATION FORM**

FOR NPS USE ONLY

JUN 30 1980

RECEIVED

DATE ENTERED

CONTINUATION SHEET	Owners of Property	ITEM NUMBER	PAGE 4
--------------------	-----------------------	-------------	--------

#654-6
Edith Cuffman
Apt. 6
200 E. Myrtle
Fort Collins, CO 80524

#655
Richard Vondreskt
Richard White
711 Gregory Rd.
Fort Collins, CO 80524

#658
Long Apartments, Ltd.
c/o R.L. Anderson
202 Remington #1
Fort Collins, CO 80524

#659
Daniel N. Scariano
c/o Scot Billington
4630 Venturi Lane
Fort Collins, CO 80525

#662
Michael Barlage
Shirley S. Barlage
320 Edwards
Fort Collins, CO 80521

#663
Thomas Whittaker
420 Apple Blossom Lane
Fort Collins, CO 80526

UNITED STATES DEPARTMENT OF THE INTERIOR
NATIONAL PARK SERVICE

FOR NPS USE ONLY

RECEIVED JAN 29 1980

OCT 3 1980

DATE ENTERED

**NATIONAL REGISTER OF HISTORIC PLACES
INVENTORY -- NOMINATION FORM**

CONTINUATION SHEET Description ITEM NUMBER 7 PAGE 2

Buildings Contributing to the Character of the District:

1. Faith Tabernacle (328 Remington): 1903, Butler and McDaniels-builders, single, detached, three stories, L-shaped, rough cut sandstone, high hipped, eaves do not project over the walls.
2. Loomis House (405 Remington): c. 1880, single, detached, two and a half stories, irregular plan, stucco, truncated hipped with projecting gable, boxed cornice with supporting brackets, four bays.
3. Kissock House (408 Remington): 1892, Montezuma Fuller-architect, single, detached, two story, rectangular, clapboard, medium hipped, boxed cornice with decorated frieze, three bays.
4. St. Clair House (412 Remington): c. 1900, single, detached, one story, L-shaped, brick, high gabled, plain, boxed cornice, three bays.
5. Russell House (416 Remington): c. 1872, single, detached, one and a half stories, rectangular, stuccoed, medium gabled, plain, boxed cornice, three bays.
6. Brinker House (418 Remington): c. 1911, single detached, two story, rectangular, clapboard, bellcast hipped with a bellcast dormer, plain, boxed cornice, two bays.
7. Bennett House (420 Remington): c. 1900, single, detached, two story, rectangular, clapboard, bellcast hipped with bellcast hipped dormers, plain, boxed cornice, two bays.
8. William Stover House I (503 Remington): 1887, single, detached, two story, rectangular with projecting wings, brick, truncated hipped with cast iron cresting, plain, boxed cornice, three bays.
9. Walker House (508 Remington): c. 1889, single, detached, two stories, brick, high gabled, plain, boxed cornice, two bays. Distinctive radiating corbled arch over semi-circular main window.
10. Fred Stover House (509 Remington): 1904, Pierce and Loveland-builders, single, detached, two story, rectangular, brick, low hipped with hipped dormer, boxed cornice with supporting brackets, three bays.
11. W. C. Dilts (514 Remington): c. 1889, single, detached, two story, rectangular, brick, mansard, plain, boxed cornices, two bays. The only remaining example of this style in Fort Collins.

UNITED STATES DEPARTMENT OF THE INTERIOR
NATIONAL PARK SERVICE

FOR NPS USE ONLY

RECEIVED JAN 29 1980

DATE ENTERED OCT 3 1980

**NATIONAL REGISTER OF HISTORIC PLACES
INVENTORY -- NOMINATION FORM**

CONTINUATION SHEET Description ITEM NUMBER 7 PAGE 3

12. William Stover House II (515 Remington): 1904, Love and Bain builders, single, detached, one and a half stories, rectangular, brick, high gabled, plain, boxed cornice with returns on the raking trim, three bays.
13. Strom House (522 Remington): c. 1900, single, detached, two story, rectangular, clapboard, medium gabled, plain, boxed cornice with returns on the raking trim, three bays.
14. F.N.B. Scott House (523 Remington): c. 1921, single, detached, one story, rectangle, brick, medium gabled, projecting eaves with exposed rafters, three bays.
15. Calloway House (526 Remington): 1901, J. C. Davis-builder, single, detached, one story, irregular plan, stucco, medium hipped with hipped dormer, plain boxed cornice, two bays.
16. Laidlaw House (527 Remington): 1908, single, detached, two stories, rectangular, brick, medium hipped with hipped dormer, projecting eaves and exposed rafters, three bays.
17. Turk House (531 Remington): c. 1900, single, detached, one and a half stories, irregular plan, brick, truncated high hipped with projecting gables, plain, boxed cornice.
18. Rhodes/Evans House (604 Remington): c. 1889, single, detached, two and a half story, irregular plan, brick, irregular roof line, five bays.
19. Glessner House (605 Remington): c. 1911, single, detached, two stories, rectangular, brick/stucco, high gable with shed dormers, projecting eaves with exposed rafters, six bays.
20. Weuve House (608 Remington): 1900, H. W. Schroeder-builder, single, detached, two stories, irregular plan, brick, high gabled with gabled dormers, plain, boxed cornices, five bays.
21. Horn House (614 Remington): single, detached, one story, rectangular, brick, truncated high hipped with a triangular dormer, plain, boxed cornice, three bays.
22. Toomey House (615 Remington): c. 1904, double, semi-detached, nonrelated, two stories, square, brick, bellcast roof, boxed cornice with supporting consoles, four bays.
23. Murray House (618 Remington): c. 1884, with 1901 addition, single, detached, one story, irregular plan, brick, truncated low hipped, plain, boxed cornice, three bays.

UNITED STATES DEPARTMENT OF THE INTERIOR
NATIONAL PARK SERVICE

FOR NPS USE ONLY

RECEIVED JAN 29 1980

DATE ENTERED

OCT 3 1980

**NATIONAL REGISTER OF HISTORIC PLACES
INVENTORY -- NOMINATION FORM**

CONTINUATION SHEET Description ITEM NUMBER 7 PAGE 4

24. E. Bowles House (621 Remington): c. 1905, single, detached two story, square, brick, truncated, bellcast hipped, plain, boxed cornice with supporting brackets, four bays.
25. C. M. Smith House (622 Remington): c. 1899, single, detached, one story, irregular plan, brick, high hipped with projecting gables, plain, boxed cornice, two bays.
26. Fothergill House II (625 Remington): 1921, single, detached, two story, rectangular, clapboard, high gable, plain, boxed cornice, three bays.
27. Monroe House (626 Remington): c. 1890, single, detached, two story rectangle, stucco, high gable, projecting eaves with exposed rafters, three bays.
28. Devers House (630 Remington): c. 1899, single, detached, two story, square, composition board covering clapboard, irregular roofline, plain with sloping soffit, two bays.
29. Morrill House (633 Remington): c. 1920, single, detached, two story rectangular, brick, bellcast gable, plain, boxed cornice, three bays.
30. Metcalfe House (634 Remington): 1900, William Metcalfe-builder, single detached, one story, rectangular, alternating courses of tooled and rough cut sandstone, high gable with medium hipped in rear, plain, boxed cornice, raking trim-plain parapet, three bays.
31. L. B. Crosby House (637 Remington): c. 1918, single, detached, two story, stucco, medium gable, plain, boxed cornice, three bays.
32. S. A. Earl House (640 Remington): c. 1906, single, detached, two stories, square, brick, bellcast hipped with bellcast hipped dormer, plain, boxed cornice, three bays.
33. Ralph House (641 Remington): c. 1911, single, detached, two story, rectangular, stucco, medium hipped roof with shed dormer, projecting eaves with exposed rafters, seven bays.
34. Sandsten House (643-645 Remington): c. 1906, double, semi-detached, related, two story, rectangular, brick with tan, tooled stone quoins, bellcast hipped with bellcast hipped dormer, projecting eaves with exposed rafters, six bays.
35. Gage House (644 Remington): 1903, single, detached, one story, brick, high hipped with projecting gable, plain, boxed cornice, three days.

UNITED STATES DEPARTMENT OF THE INTERIOR
NATIONAL PARK SERVICE

FOR NPS USE ONLY

RECEIVED JAN 29 1980

DATE ENTERED

001 3

NATIONAL REGISTER OF HISTORIC PLACES
INVENTORY -- NOMINATION FORM

CONTINUATION SHEET

Description

ITEM NUMBER

7

PAGE

5

36. Golding-Dwyre House (649 Remington): c. 1899, single, detached, two stories, irregular plan, brick, low hipped roof, boxed cornice with consoles, two bays.
37. M. J. Nelson House (700 Remington): 1905, C. A. Button-builder, single, detached, two story, rectangular, clapboard, cross gambreled, plain, boxed cornice, three bays.
38. Schroeder House (701 Remington): 1902, single, detached, two stories, square, clapboard, bellcast hipped with bellcast hipped dormer, boxed cornice with decorated frieze and supporting brackets, three bays.
39. John Nelson Sr. House (704 Remington): 1905, John Nelson Jr.- builder, single, detached, two story, square, clapboard, bellcast hipped with bellcast hipped dormer, three bays.
40. Sherman House (708 Remington): c. 1921, single, detached, one and a half story, square, clapboard, medium gable with gable dormer, plain, boxed cornice, four bays.
41. Sigma Nu House (710 Remington): c. 1905, single, detached, two and a half stories, rectangular, bellcast hipped with bellcast hipped dormers, projecting eaves with exposed rafters, three bays.
42. Button House (711 Remington): c. 1897, single, detached, one story, irregular plan, sandstone and stucco, high hipped with bellcast hipped dormer, plain, boxed cornices, three bays.
43. Hahn House (718 Remington): c. 1900, single, detached, one and a half stories, irregular plan, clapboard, high hipped, plain, boxed cornice, two bays.
44. B. O. Longyear (719 Remington): 1904, A. F. Huleatt-builder, single, detached, one and a half stories, rectangular, aluminum siding, high gabled with bellcast hipped dormer, plain, boxed cornice, three bays.
45. Huleatt House (721 Remington): 1904, A. F. Huleatt-builder, single, detached, two story, rectangular, clapboard, irregular roofline, plain, boxed cornice with decorative bargeboard at the raking trim, two bays.
46. Mary Davis House (722 Remington): 1904, R. B. Leonard-builder, single, detached, two and a half stories, brick, medium gable with shed dormers, plain, boxed cornice, returns on raking trim form a pediment, three bays.

UNITED STATES DEPARTMENT OF THE INTERIOR
NATIONAL PARK SERVICE

**NATIONAL REGISTER OF HISTORIC PLACES
INVENTORY -- NOMINATION FORM**

FOR NPS USE ONLY

RECEIVED JAN 29 1980

DATE ENTERED OCT 3

CONTINUATION SHEET Description ITEM NUMBER 7 PAGE 6

47. S. H. Clammer House (729 Remington): c. 1900, single, detached, two stories, irregular plan, brick, intersecting medium gables, projecting eaves, two bays.
48. F. R. Slockett House (805 Remington): c. 1905, single, detached, two story, rectangular, clapboard, gambreled with gambreled dormers, plain, boxed cornice, two bays.
49. W. W. Gibb House (808 Remington): 1907, single, detached, one and a half stories, rectangular, high gable roof, plain, boxed cornice one bay.
50. E. C. Ellis House (809 Remington): c. 1905, single, detached, one story, rectangular, clapboard, bellcast hipped with hipped dormer, plain, boxed cornice, two bays.
51. J. N. Sapp House (813 Remington): c. 1905, single, detached, one story, irregular, clapboard, truncated hipped with projecting gable, plain, boxed cornice with returns on raking trim of gable, four bays.
52. A. W. Boyd House (814-816 Remington): 1907, single, detached, one story, rectangular, clapboard, medium hipped with triangular dormer, plain, boxed cornice, five bays.
53. M. F. Stoddard House (817 Remington): c. 1900, single, detached, one story, rectangular, clapboard, high gable with offset right projecting gable, plain, boxed cornice with returns, two bays.
54. Bragg House (818 Remington): 1904, Conley and Boyd-builders, single, detached, one story, rectangular, composition board siding over clapboard, medium hipped with triangular dormer, plain, boxed cornice, three bays.
55. Will Ryan House (820 Remington): 1905, M. G. Conley-builder, single, detached, one story, rectangular, clapboard, bellcast hipped with bellcast hipped dormer, plain, boxed cornice, two bays.
56. G. L. Davis House (824 Remington): c. 1924, single, detached, one story, rectangular, shake, high gable, plain, boxed cornice, three bays.
57. F. J. Earl House (825 Remington): c. 1921, single, detached, one story, rectangular, clapboard, hipped gable, projecting eaves, exposed rafters, two bays.
58. A. R. Ross House (827 Remington): c. 1925, single, detached, one story, rectangular, clapboard, medium gable, projecting eaves with exposed rafters, two bays.

UNITED STATES DEPARTMENT OF THE INTERIOR
NATIONAL PARK SERVICE

**NATIONAL REGISTER OF HISTORIC PLACES
INVENTORY -- NOMINATION FORM**

FOR NPS USE ONLY

RECEIVED JAN 29 1980

DATE ENTERED

CONTINUATION SHEET Description ITEM NUMBER 7 PAGE 7

59. L. Fitzgerald House (828 Remington): c. 1920, single, detached, rectangular, one story, clapboard, medium gable, projecting eaves with exposed rafters, four bays.
60. J. D. Power House (901 Remington): c. 1925, single, detached, two story, square, shake, high gable with shed dormers, closed eaves and verges, three bays.
61. Wynkoop-Plummer House (902-904 Remington): c. 1921, double, semi-detached, one story, rectangular, shake, medium gable, projecting eaves, exposed rafters, six bays.
62. Jobe-Bowers House (906-908 Remington): c. 1921, double, semi-detached, related, one story, rectangular, clapboard, medium hipped with hipped dormer, plain, boxed cornice, six bays.
63. Conley Carriage House (920 Remington): c. 1905, single, detached two stories, rectangular, aluminum gable, medium gable with shed dormer, verges closed, one bay.
64. W. E. Vaplon House (931 Remington): c. 1903, single, detached, one story, irregular, clapboard, cross gambreled, plain, boxed cornice, three bays.
65. Myron House (1003 Remington): c. 1895, Montezuma Fuller-architect, single, detached, one and a half stories, brick, truncated hipped with triangular dormers, plain, boxed cornice with decorated bargeboard on gables, two bays.
66. Akin House (1008 Remington): The Akin House was built in three stages, the first was c. 1895, single, detached, one and a half stories, irregular plan, sandstone/clapboard, irregular roofline.
67. J. L. Brown House (1011 Remington): c. 1900, single, detached, two and a half stories, rectangular, stucco, high gable with returns, plain, boxed cornice, three bays.
68. S. W. Johnson House (1016 Remington): 1904, J. L. Rowe-builder, single, detached, one story, rectangular, brick, high hipped with hipped and triangular dormers, plain, boxed cornice, three bays.
69. L. R. Davies House (1019 Remington): c. 1921, single, detached, one story, irregular, clapboard, medium hipped, projecting eaves with exposed rafters, four bays.
70. B. F. Kaupp House (1105 Remington): c. 1908, single, detached, one story, rectangular, clapboard, bellcast hipped, plain, boxed cornices, two bays.

UNITED STATES DEPARTMENT OF THE INTERIOR
NATIONAL PARK SERVICE

FOR NPS USE ONLY

RECEIVED

JAN 29 1980

DATE ENTERED

OCT

3

**NATIONAL REGISTER OF HISTORIC PLACES
INVENTORY -- NOMINATION FORM**

CONTINUATION SHEET Description ITEM NUMBER 7 PAGE 8

71. C. A. Smiley (1110 Remington): c. 1924, single, detached, one story, rectangular, brick, low gable, plain, boxed cornice, three bays.
72. J. L. Van Horn House (1111 Remington): 1902/1908, single, detached, two story, square, brick, medium hipped with triangular dormers, plain, boxed cornice, four bays.
73. J. Richard (1112 Remington): c. 1890, single, detached, one and a half stories, square, brown sandstone with red sandstone quoins and arched, radiating voussoirs, truncated hipped with polygonal and triangular dormers, two bays.
74. W. White House (1117 Remington): c. 1950, single, detached, one and a half stories, rectangular, wide clapboard, low gable, plain, boxed cornice, three bays.
75. F. J. Randall House (1118 Remington): 1905, W. L. Gault-builder, single, detached, one and a half stories, square, composition board siding, medium hipped with triangular dormers, plain, boxed cornice, three bays.
76. May House (1121 Remington): c. 1900, single, detached, one story, square, clapboard, high hipped with triangular dormer, plain, boxed cornice with decorated bargeboard, three bays.
77. O. S. Jones House (1202 Remington): c. 1906, single, detached, two story, irregular plan, clapboard, irregular roofline, plain, boxed cornice, two bays.
78. W. E. Hennington House (1203 Remington): c. 1897, single, detached, one story, rectangular with rear addition (1920s), stucco, medium hipped with triangular dormer, plain, boxed cornice, four bays.
79. A. R. Lovesee House (1205 Remington): single, detached, one story, rectangular, clapboard, low gable with gable dormers, projecting eaves with exposed rafters, three bays.
80. W. H. Clark House (1208 Remington): c. 1935, single, detached, one story, rectangular, composition board siding, low hipped, plain, boxed cornice, three bays.
81. G. Buress (1209 Remington): c. 1920, single, detached, one story, rectangular, clapboard, medium gable, projecting eaves with exposed rafters, three bays.
82. F. R. Akers House (1210 Remington): 1904, J. L. Rowe-builder, single, detached, one story, rectangular, clapboard, high hipped, plain, boxed cornice, three bays.

UNITED STATES DEPARTMENT OF THE INTERIOR
NATIONAL PARK SERVICE

FOR NPS USE ONLY

RECEIVED JAN 29 1980 OCT 3 1980

DATE ENTERED

NATIONAL REGISTER OF HISTORIC PLACES
INVENTORY -- NOMINATION FORM

CONTINUATION SHEET Description ITEM NUMBER 7 PAGE 9

83. Charles Phye House (1214 Remington): 1904, J. L. Rowe-builder, single, detached, one story, square, clapboard, high hipped, plain, boxed cornice, three bays.
84. T. W. Smith House (1215 Remington): c. 1921, single, detached, one story rectangular, clapboard, low hipped, projecting eaves with exposed rafters, three bays.
85. M. A. Stockton House (1218 Remington): c. 1905, detached, one story, irregular plan, composition board siding, irregular roofline, plain boxed cornice, three bays.
86. L. L. Osborn House (1221 Remington): single, detached, one and a half stories, square, asphalt siding, medium gable with shed dormer, projecting eaves with exposed rafters, three bays.
87. R. W. Fox House (1217 Remington): c. 1920, single, detached, one and a half stories, square, composition board, medium gable with triangular dormer and shed dormer, projecting eaves with exposed rafters, three bays.
88. Fort Collins High School (1400 Remington): 1924, William N. Bowman Co.-architects, single, detached, three and a half stories, irregular plan with wings on left and right sides, red brick with ten quoins, center gable with plain parapet, three story portico, cupola.
89. Coy House (401 Mathews): c. 1876, single, detached, one story, irregular plan, clapboard, medium gable, plain, boxed cornice, three bays.
90. Hollowell House (405 Mathews): c. 1895, single, detached, two story, square, brick, truncated hipped, plain, boxed cornice with returns on the raking trim, three bays.
91. Roberts House (409 Mathews): c. 1895, single, detached, one story, square plan with rear wing, brick, truncated hipped with triangular and hipped dormers, plain, boxed cornice, two bays.
92. Conner House (415 Mathews): c. 1900, single, detached, one and a half stories, rectangular with rear wing addition, brick, high hipped with triangular and shed dormers, boxed cornice with decorated frieze, two bays.
93. H. W. Schroeder House (419 Mathews): 1901, H. W. Schroeder-builder, single, detached, one and half stories, irregular plan, brick, high hipped with triangular dormer, plain, boxed cornices with returns on the raking trim, two bays.

UNITED STATES DEPARTMENT OF THE INTERIOR
NATIONAL PARK SERVICE

**NATIONAL REGISTER OF HISTORIC PLACES
INVENTORY -- NOMINATION FORM**

FOR NPS USE ONLY

RECEIVED JAN 29 1980

OCT 3 20

DATE ENTERED

CONTINUATION SHEET Description ITEM NUMBER 7 PAGE 10

94. W. V. Roberts House (421 Mathews): c. 1894, single, detached, one story, irregular plan, clapboard, truncated hipped, plain, boxed, cornices, three bays.
95. Clyde H. Brown House (425 Mathews): 1903, H. W. Schroeder-builder, single, detached, one and a half stories, bellcast hipped with triangular dormers, boxed cornices, decorated with frieze, three bays.
96. Miner House (503 Mathews): c. 1879, single, detached one and a half stories, irregular plan, brick, hipped gable with intersecting east-west gable, boxed cornice with sloping soffit, two bays.
97. Evans House (507 Mathews): c. 1911, single, detached one story, rectangularly shaped, clapboard, medium gable, projecting gable with exposed rafters, three bays.
98. Otis House (511 Mathews): 1903, Love and Bain-contractors, single, detached, two story, irregular plan, clapboard, low hipped with hipped dormer, boxes cornice supported by brackets, two bays.
99. Hice House (515 Mathews): c. 1899, single, detached, one and a half stories, irregular plan, brick, high hipped, plain, boxed cornice with return on raking trim, three bays.
100. Percy House (637½ Peterson): c. 1910, single, detached, one story, square, clapboard, medium gable, boxed cornice, sloped soffit.
101. F. Battey House (521 Mathews): c. 1900, single, detached, one story, irregular plan, clapboard, medium gable, plain, boxed cornice, four bays.
102. Steudler House (527 Mathews): 1904, H. W. Schroeder-contractor, single, detached, one story, square with rear addition, clapboard, high hipped, plain, boxed cornice, three bays.
103. E. D. Ball House (600 Mathews): c. 1895, single, detached, one and a half stories, irregular plan, clapboard, truncated hip with projecting gables, plain, boxed cornice, three bays.
104. Michele Klein House (601-603 Mathews): 1910, semi-detached, related, one and a half stories, rectangular, clapboard, truncated hip with projecting gable, plain, boxed cornice, four bays.
105. F. L. Garnick House (605 Mathews): c. 1884, single, detached, one and a half stories, irregular plan, brick, high hipped with triangular gable and shed dormers, plain, boxed cornice, five bays.

UNITED STATES DEPARTMENT OF THE INTERIOR
NATIONAL PARK SERVICE

FOR NPS USE ONLY

RECEIVED JAN 29 1980

DATE ENTERED

JCT 3

**NATIONAL REGISTER OF HISTORIC PLACES
INVENTORY -- NOMINATION FORM**

CONTINUATION SHEET Description ITEM NUMBER 7 PAGE 11

106. Morrish House (611 Mathews): c. 1904, single detached, one story, irregular plan, clapboard, truncated hipped with projecting gable and a triangular dormer, plain, boxed cornice, two bays.
107. Fisher House (615 Mathews): c. 1905, single, detached, one story, rectangular, brick, bellcast hipped with triangular dormers, plain, boxed cornice, three bays.
108. Rowland House (617 Mathews): c. 1889, single, detached, one and a half stories, rectangular, clapboard, high gable with shed dormer, boxed cornice with sloping soffit, raking trim is plain and boxed, two bays.
109. B. F. Clark House (621 Mathews): 1904, Mr. Williams-builder, single, detached, one and a half stories, rectangular, brick, gambreled with shed dormers, plain, boxed cornice, two bays.
110. S. A. Johnson House (623 Mathews): 1902, single, detached, one story, rectangular, clapboard, medium hipped with triangular dormers, plain, boxed cornice, two bays.
111. Herr House (625 Mathews): c. 1898, single, detached, one story, rectangular, clapboard, medium hipped with hipped dormer, plain, boxed cornice, three bays.
112. J. M. Barclay House (629 Mathews): c. 1908, single, detached, two stories, rectangular, clapboard, bellcast hipped with triangular dormer, plain, boxed cornice, two bays.
113. Sperr House (633 Mathews): 1904, H. W. Schroeder-builder, single, detached, one story, rectangular, brick, high hipped with triangular dormers, plain, boxed cornice, two bays.
114. E. B. Richards House (637 Mathews): c. 1908, single, detached, two story, irregular plan, brick, bellcast hipped, plain, boxed cornices, two bays.
115. Westbery House (639 and 639½ Mathews): 1904, Butler and McDaniel-builders, single, detached, two story, rectangular, composition board siding over clapboard, medium hipped, plain, boxed cornice, three bays.
116. Zauala House (641 Mathews): c. 1908, single, detached, two story, rectangular, brick, high hipped with projecting gable and a tower, plain cornice with sloping soffits, raking trim is plain and boxed, two bays.
117. L. J. Schroeder House (701 Mathews): c. 1920, single, detached one and a half stories, rectangular, brick, medium gable with shed dormers, projecting eaves with rafters exposed, two bays.

UNITED STATES DEPARTMENT OF THE INTERIOR
NATIONAL PARK SERVICE

FOR NPS USE ONLY

RECEIVED JAN 29 1980

DATE ENTERED OCT 13

**NATIONAL REGISTER OF HISTORIC PLACES
INVENTORY -- NOMINATION FORM**

CONTINUATION SHEET Description ITEM NUMBER 7 PAGE 12

118. Aylesworth House (704 Mathews): 1903, Charles A. Button-builder, single, detached, one and a half stories, rectangular, rough cut sandstone, medium gable with triangular dormers, eaves and verges are closed, six bays.
119. The R-N House (705 Mathews): c. 1930, single, detached, one and a half stories, rectangular, brick, center gable, closed eaves, three bays.
120. O. Chandler House (710 Mathews): 1909 single, detached, two stories, square, brick, hipped gables, projecting with exposed rafters, three bays.
121. N. G. Halley House (711 Mathews): c. 1924, single, detached, one story, square, brick, irregular roofline, projecting eaves with exposed rafters, three bays.
122. E. Sterdensticker House (713 Mathews): c. 1906, single, detached, one and a half stories, rectangular, brick medium gable with gable dormer, projecting eaves with exposed rafters, three bays.
123. T. J. Collopy House (714 Mathews): c. 1922, single, detached, one and a half stories, rectangular, brick, medium gable, projecting eaves with exposed rafters, three bays.
124. Elizabeth Tanner House (717 Mathews): c. 1898, single, detached, one and a half stories, rectangular, rough cut sandstone, high gabled, plain, boxed cornices with returns present on the raking trim, two bays.
125. Riddle House (718 Mathews): c. 1906, single, detached, two stories, T-shaped, composition board, high gable with projecting gable, projecting eaves with no rafters exposed, four bays.
126. R. A. Longenbaugh House (721 Mathews): c. 1935, single, detached, one story, square, aluminum siding, low hipped gable, projecting eaves with no exposed rafters, three bays.
127. Liggett House (722 Mathews): 1904 R. B. Leonard -builder, single, detached, one story, rectangular, composition board siding, medium hipped with projecting gables, plain, boxed cornice, returns present, two bays.
128. E. C. Litter House (725 Mathews): 1905, A. F. Huleatt-builder, single, detached, two stories, square with shed addition on rear, cross gable, plain, boxed cornice, returns present, two bays.
129. R. J. Theodoratus House (726 Mathews): c. 1924, single, detached, one and a half stories, square, stucco, medium gable, plain, boxed cornice, three bays.

UNITED STATES DEPARTMENT OF THE INTERIOR
NATIONAL PARK SERVICE

FOR NPS USE ONLY

RECEIVED JAN 29 1980

DATE ENTERED

3 1 1

NATIONAL REGISTER OF HISTORIC PLACES
INVENTORY -- NOMINATION FORM

CONTINUATION SHEET Description ITEM NUMBER 7 PAGE 13

130. W. H. Kerrick House (729 Mathews): 1901, W. H. Kerrick-builder, single, detached, one story, rectangular with shed addition on south facade, aluminum siding, truncate hipped, plain, boxes cornice, three bays.
131. B. J. Denna House (730 Mathews): c. 1926, single, detached, two story, square, clapboard/stucco, medium gables, projecting eaves with exposed rafters, three bays.
132. O. W. Christman House (808 Mathews): c. 1930, single, detached, one story, square, stucco, medium hipped gable, cornice fascia alone, three bays.
133. Jacob Geist House (812 Mathews): c. 1921, single, detached, one and a half stories, rectangular, composition board, high gable, projecting eaves with rafters exposed, three bays.
134. J. A. Call House (817 Mathews): c. 1930, single, detached, one story, rectangular, clapboard, low gable, closed eaves, three bays.
135. W. H. Porter House (818 Mathews): c. 1924, single, detached, one story, rectangular, clapboard, medium hipped gable with gable dormer, projecting eaves with exposed rafters, three bays.
136. R. E. Ford House (819 Mathews): c. 1924, single, detached, one story, rectangular, composition board, low gable, projecting eaves with rafters exposed, three bays.
137. L. K. Lycan House (820 Mathews): c. 1921, single, detached, two story, rectangular, clapboard, medium gable with shed dormer, projecting eaves with exposed rafters, three bays.
138. Emma Woods House (821 Mathews): c. 1924, single, detached, one story clapboard, low gable, projecting eaves with exposed rafters, three bays.
139. E. R. Hoffman House (824 and 824½ Mathews): single, detached, one and a half stories, rectangular, stucco, medium gable, projecting eaves with exposed rafters, three bays.
140. G. J. Steffen House (827 Mathews): c. 1926, single, detached, one story, rectangular, stucco, low gable, projecting eaves with exposed rafters, three bays.
141. D. Normand House (830 Mathews): c. 1924, single, detached, one story, rectangular, clapboard, medium hipped gable with hipped gable, projecting eaves with exposed rafters, three bays.

UNITED STATES DEPARTMENT OF THE INTERIOR
NATIONAL PARK SERVICE

FOR NPS USE ONLY

RECEIVED

JAN 29 1980

DATE ENTERED

101

3

**NATIONAL REGISTER OF HISTORIC PLACES
INVENTORY -- NOMINATION FORM**

CONTINUATION SHEET Description ITEM NUMBER 7 PAGE 14

142. Joan Oullette House (831 Mathews): c. 1926, single, detached, one story, rectangular, clapboard, medium gable, projecting eaves with exposed rafters, three bays.
143. C. B. Meyers House I (902 Mathews): c. 1924, single, detached, one story, square stucco, medium gable, projecting eaves with exposed rafters, three bays.
144. E. J. Robinson House (903 Mathews): c. 1911, single, detached, two story, rectangular, brick, high gable with shed dormer, plain, boxed cornice with returns, three bays.
145. C. B. Meyers House II (906 Mathews): c. 1924, single, detached, one and a half stories, rectangular, clapboard, medium gable, projecting eaves with exposed rafters, three bays.
146. H. F. Beier House (907 Mathews): c. 1920, single, detached, one and a half stories, square stucco/composition board, center gable, closed eaves, three bays.
147. W. A. Hall House (910 Mathews): c. 1926, single, detached, one story, rectangular, clapboard, medium gable, projecting eaves with exposed rafters, three bays.
148. M. Moore House (1005 Mathews): c. 1926, single, detached, two story, rectangular, clapboard/stucco, medium gable with shed dormers, projecting eaves with exposed rafters, seven bays.
149. O. E. James House (1106 Mathews): c. 1926, single, detached, one story, rectangular, stucco, low gable, projecting eaves with exposed rafters, three bays.
150. W. Bevan House (1109 Mathews): 1905, O. E. Long-builder, single, detached, one story, square, aluminum siding, medium hipped, plain, boxed cornice, three bays.
151. B. W. Fairbanks House (1110 Mathews): c. 1926, single, detached, one story, rectangular, stucco, low gable, projecting eaves with exposed rafters.
152. V. E. Cram House (1112 Mathews): c. 1924, single, detached, two story irregular plan, clapboard/shake, low gable with hipped gabled projection, projecting eaves with exposed rafters, four bays.
153. Harley Kimble House (1113 Mathews): 1905, A. Kimble-builder, single, detached, one story, rectangular, clapboard, high hipped with triangular dormer, three bays.

UNITED STATES DEPARTMENT OF THE INTERIOR
NATIONAL PARK SERVICE

FOR NPS USE ONLY

RECEIVED JAN 29 1980

DATE ENTERED

101 3

**NATIONAL REGISTER OF HISTORIC PLACES
INVENTORY -- NOMINATION FORM**

CONTINUATION SHEET Description ITEM NUMBER 7 PAGE 15

154. O. E. Long (1117 Mathews): 1904, O. E. Long-builder, single, detached, one story, rectangular, clapboard, high hipped, plain, boxed cornice, three bays.
155. Peter Spanner House I (1213 Mathews): 1904, J. L. Rowe-builder, single, detached, one story, rectangular, clapboard, medium hipped, plain, boxed cornice, three bays.
156. Peter Spanner House II (1219 Mathews): 1904, J. L. Rowe-builder, single, detached, one story, irregular plan, clapboard, irregular roofline, plain, boxed cornice, one bay.
157. C. G. Andrews House (102 Peterson): c. 1903, single, detached, one and a half stories, rectangular, clapboard, irregular roofline, plain, boxed cornice, five bays.
158. J. A. Schaver House (104 Peterson): 1905, single, detached, one and a half stories, rectangular, high gable with gable dormer, clapboard, plain, boxed cornice, three bays.
159. Roy Portner House I (105 Peterson): 1905, Hess Brothers-builders, single, detached, one and a half stories, rectangular, clapboard, bellcast hipped, plain, boxed cornice, two bays.
160. V. L. Arenschield House (107 Peterson): c. 1908, single, detached, one and a half storied, rectangular, clapboard, bellcast hipped, plain, boxed cornice, two bays.
161. C. F. Darrow House (108 Peterson): c. 1908, single, detached, one and a half stories, rectangular, stucco, medium gable with projecting gable, plain, boxed cornice, three bays.
162. E. L. Salladin House (112 Peterson): c. 1903, single, detached, one story, rectangular, brick, medium gable with projecting gable, cornice fascia alone, two bays.
163. W. M. Burton House (113 Peterson): c. 1903, single, detached, one and a half stories, rectangular, clapboard, bellcast hipped, plain, boxed cornice, two bays.
164. Emigh Moore House (120 Peterson): c. 1917, double, semi-detached, two stories, rectangular, stucco, high hipped boxed cornice with sloped soffit, six bays.
165. F. A. Chaffee House (202 Peterson): 1892, Montezuma Fuller - architect, remodeler (1905), C. A. Button-builder, single, detached, two story, rectangular, stucco, irregular roofline, plain, boxed cornice, three bays.

UNITED STATES DEPARTMENT OF THE INTERIOR
NATIONAL PARK SERVICE

FOR NPS USE ONLY

RECEIVED JAN 29 1980

DATE ENTERED

OCT 3

**NATIONAL REGISTER OF HISTORIC PLACES
INVENTORY -- NOMINATION FORM**

CONTINUATION SHEET Description ITEM NUMBER 7 PAGE 16

166. G. F. Tucker House (208 Peterson): c. 1887, single, detached, one story, rectangular, clapboard, medium gable, plain, boxed cornice, three bays.
167. E. F. Wiedman House (214 Peterson): c. 1902, single, detached, one story, rectangular clapboard, medium gable, projecting eaves with exposed rafters, three bays.
168. B. H. McCarthy House (218 Peterson): c. 1902, single, detached, two story, irregular plan, brick, hipped, cross gable, cornice boxed with brackets present, four bays.
169. E. Scheidt House (226 Peterson): c. 1904, single detached, two story, square, brick, bellcast, hipped, boxed cornice, with brackets, three bays.
170. D. Williamson House (300 Peterson): c. 1899, single, detached, two story, square, stucco, hipped, cross gable, plain, boxed cornice, two bays.
171. Casio House (304/306 Peterson): c. 1900, single, detached, two stories, square, brick, irregular roofline, plain, boxed cornice, four bays.
172. C. J. Corbett House (310 Peterson): 1904, J. L. Rowe - builder, single, detached, one and a half stories, square, clapboard, high gable with gable dormers, plain, boxed cornice with returns, two bays.
173. W. L. Gault House (314 Peterson): 1905, W. L. Gault-builder, single, detached, one and a half stories, rectangular, clapboard, hipped gable with projecting gables, plain, boxed cornice with returns, three bays.
174. J. C. Martin House (318 Peterson): 1903, J. L. Rowe-builder, single, detached, one story, rectangular, composition board, high hipped, plain, boxed cornice, three bays.
175. H. C. Branch House (319 Peterson): c. 1900, single, detached, one story, rectangular, clapboard, medium gable, plain, boxed cornice, three bays.
176. W. L. Gault House II (322 Peterson): 1905, W. L. Gault-builder, single, detached, one and a half stories, rectangular, clapboard, irregular roofline, plain, boxed cornice with returns, three bays.
177. Margret Webster House (326 Peterson): c. 1903, single, detached one and a half stories, square, clapboard, irregular roofline, plain, boxed cornice with returns, three bays.

UNITED STATES DEPARTMENT OF THE INTERIOR
NATIONAL PARK SERVICE

FOR NPS USE ONLY

RECEIVED JAN 29 1980

DATE ENTERED

OCT 3

NATIONAL REGISTER OF HISTORIC PLACES
INVENTORY -- NOMINATION FORM

CONTINUATION SHEET Description ITEM NUMBER 7 PAGE 17

178. A. J. White House (330 Peterson): 1904, O. E. Long-builder, single, detached, one and a half stories, irregular plan, clapboard, hipped roof, plain, boxed cornice.
179. W. E. Hurdle House (400 Peterson): c. 1905, single, detached, two story, square, clapboard, high hipped, projecting eaves with exposed rafters, three bays.
180. Frank Beach House (406 Peterson): c. 1905, single, detached, two story, square, clapboard, bellcast hipped, boxed cornice, decorated frieze, two bays.
181. Andrew Wilson House (410 Peterson): 1905, J. L. Rowe-builder, single, detached, two story, square, bellcast hipped, plain, boxed cornice, two bays.
182. F. E. Barnes House (412 Peterson): 1905, J. L. Rowe-builder, single, detached, one story, rectangular, clapboard, medium gable, plain, boxed cornice with returns, three bays.
183. W. D. Waite House (415 Peterson): Probably the Aurthur House Carriage House, single, detached, one and a half stories, rectangular stucco.
184. J. W. Bell House (416 Peterson): c. 1905, single, detached, one story, T-shaped, clapboard/composition board siding, medium gable, cornice boxed, sloped soffit, three bays.
185. Thomas Thompson House (422 Peterson): c. 1897, single, detached, one and a half stories, rectangular, clapboard, high gable, boxed cornice, sloped soffit, three bays.
186. A. C. Peasley House (426 Peterson): c. 1907, single, detached, two story, square, clapboard, bellcast hipped cornice boxed, decorated, frieze decorated, three bays.
187. John H. Mandeville (430 Peterson): c. 1899, single, detached, two story, square, aluminum siding over clapboard, medium gable, plain, boxed cornice, two bays.
188. W. C. Brooks House (502 Peterson): c. 1924, single, detached, one story, square, clapboard, high hipped projecting eaves with exposed rafters, five bays.
189. W. D. Inglefield House (506 Peterson): c. 1924, single, detached, one story, square, composition board, high hipped, projecting eaves with exposed rafters, four bays.

UNITED STATES DEPARTMENT OF THE INTERIOR
NATIONAL PARK SERVICE

FOR NPS USE ONLY

RECEIVED JAN 29 1980

DATE ENTERED

OCT 3

**NATIONAL REGISTER OF HISTORIC PLACES
INVENTORY -- NOMINATION FORM**

CONTINUATION SHEET Description ITEM NUMBER 7 PAGE 18

190. G. L. Bell House (508 Peterson): c. 1900, single, detached, one story, rectangular, clapboard, medium gable, cornice boxed, sloped soffit, three bays.
191. Almina Ruthuen House (512 Peterson): c. 1900, single, detached, one story, rectangular, clapboard, irregular roofline, projecting eaves with exposed rafters, three bays.
192. B. F. Ayers House (518 Peterson): 1901, J. L. Rowe-builder, single, detached, two story, square, clapboard, medium hipped, plain, boxed cornice, three bays.
193. J. T. Moon (519 Peterson): c. 1900, single, detached, one story, rectangular, clapboard, medium gable with projecting gable, plain, boxed cornice, four bays.
194. Zenas Zinn House (524 Peterson): c. 1905, single, detached, one story clapboard, square, high hipped, plain, boxed cornice, three bays.
195. C. M. Larsen House (520 Peterson): c. 1900, single, detached, one story, rectangular, composition board, medium gable with projecting gable, plain, boxed cornice, three bays.
196. F. W. Lange House (521 Peterson): c. 1920, single, detached, one story, square, clapboard, medium gable, projecting eaves with exposed rafters, three bays.
197. S. P. Aldrich House (523 Peterson): c. 1920, single, detached, one story, rectangular, composition board, medium gable, projecting eaves with exposed rafters, four bays.
198. W. L. Green House (525 Peterson): c. 1920, single, detached, one story, rectangular, clapboard, hipped gable, projecting eaves with exposed rafters, five bays.
199. A. Bryan House (530 Peterson): c. 1904, single, detached, one and a half stories, rectangular, composition board, high gable with shed dormers, projecting eaves with exposed rafters, three bays.
200. C. M. Sorenson House (602 Peterson): 1902, single, detached, one story, rectangular, stucco, high hipped with triangular dormers, plain, boxed cornice, four bays.
201. T. C. Halverson House (603 Peterson): c. 1900, single, detached, one story, rectangular, clapboard, high hipped with triangular dormers, three bays.

UNITED STATES DEPARTMENT OF THE INTERIOR
NATIONAL PARK SERVICE

FOR NPS USE ONLY

RECEIVED JAN 29 1980

DATE ENTERED

OUT 3

**NATIONAL REGISTER OF HISTORIC PLACES
INVENTORY -- NOMINATION FORM**

CONTINUATION SHEET Description ITEM NUMBER 7 PAGE 19

202. J. C. Thompson House (604 Peterson): c. 1907, single, detached, one story rectangular, brick, high hipped with triangular dormers, plain, boxed cornice, five bays.
203. Jacob Pitsch House (605 Peterson): c. 1920, single, detached, one story, rectangular, clapboard, high hipped, projecting eaves with exposed rafters, three bays.
204. J. R. Littlefield House (608 Peterson): c. 1900, single, detached, one story, rectangular, clapboard, irregular roofline with shed dormer, projecting eaves with exposed rafters, five bays.
205. W. R. Freeman House (609 Peterson): c. 1920, single, detached, one story, rectangular, clapboard, medium gable, projecting eaves with exposed rafters, four bays.
206. B. T. Whedbee House (611 Peterson): 1898, Hiram Pierce-builder, single, detached, one and a half stories, irregular plan, modern siding, high gable, closed eaves, three bays.
207. Samuel Miller House (612 Peterson): c. 1904, single, detached, one story, rectangular, stucco, high hipped, plain, boxed cornice, three bays.
208. W. H. Preston House (616 Peterson): c. 1900, single, detached, one story, rectangular, clapboard, medium gable with projecting gable, cornice boxed, sloping soffit, four bays.
209. W. F. Gilkison House (622 Peterson): c. 1907, single, detached, one and a half stories, irregular plan, brick, irregular roofline (under construction), three bays.
210. Oldfield House (625 Peterson): c. 1903, single, detached, one and a half stories, rectangular, clapboard, cross gabled, cornice boxed, sloped soffit, two bays.
211. Hardinger House (628 Peterson): 1902, single, detached, one and a half stories, square, clapboard, truncated hipped with triangular dormers, plain, boxed cornice, three bays.
212. H. H. Hartman House (630 Peterson): single, detached, one and a half stories, irregular plan, clapboard, irregular roofline, plain, boxed cornice, four bays.

UNITED STATES DEPARTMENT OF THE INTERIOR
NATIONAL PARK SERVICE

FOR NPS USE ONLY

RECEIVED JAN 29 1980

DATE ENTERED

OCT 3 1981

**NATIONAL REGISTER OF HISTORIC PLACES
INVENTORY -- NOMINATION FORM**

CONTINUATION SHEET Description ITEM NUMBER 7 PAGE 20

213. B. McCurry House (631 Peterson): 1901, J. L. Rowe-builder, single, detached, one story, rectangular, aluminum siding, irregular roofline, plain, boxed cornice, three bays.
214. G. R. McDaniel House I (632 Peterson): c. 1906, single, detached, two stories, rectangular, clapboard, irregular roofline, cornice boxed, sloped soffit, four bays.
215. William Elzinger House (635 Peterson): 1904, single, detached, one story, square, clapboard, medium hipped with a triangular dormer, plain, boxed cornice, two bays.
216. E. M. Dodd House (636 Peterson): c. 1920, single, detached, one story, rectangular, clapboard, medium gable, projecting eaves with exposed gables, three bays.
217. Perry Harrington House (637 Peterson): c. 1906, single, detached, one and a half stories, square, brick, high hipped with triangular dormers, cornice boxed, plain, frieze plain, three bays.
218. S. E. Rice House (640 Peterson): c. 1925, single, detached, one story, rectangular, clapboard, medium gable, projecting eaves with exposed rafters, four bays.
219. A. Emslie House I (644 Peterson): single, detached, one and a half stories, rectangular, brick, bellcast hipped with triangular dormers, plain, boxed cornice, three bays.
220. G. R. McDaniels House II (703 Peterson): 1904, Butler and McDaniels-builder, single, detached, one and a half stories, rectangular, composition board siding, high gable, boxed cornice with sloped soffit, four bays.
221. J. W. Kerlin House (708 Peterson): 1905, W. L. Gault-builder, single detached, one and a half stories, clapboard, high hipped, plain cornice with returns, three bays.
222. A. W. Howarter House (707 Peterson): c. 1903, single, detached, one story, rectangular, clapboard, high hipped, boxed cornice with sloped soffit, two bays.
223. W. E. Boyd House (711 Peterson): 1904, Butler and McDaniels-builder, single, detached, one and a half stories, rectangular, clapboard, high hipped, plain cornice with sloped soffit, two bays.

UNITED STATES DEPARTMENT OF THE INTERIOR
NATIONAL PARK SERVICE

FOR NPS USE ONLY

RECEIVED JAN 29 1980

DATE ENTERED

3

NATIONAL REGISTER OF HISTORIC PLACES
INVENTORY -- NOMINATION FORM

CONTINUATION SHEET Description ITEM NUMBER 7 PAGE 21

224. S. S. Portner House (712 Peterson): c. 1905, single, detached, one and a half stories, rectangular, brick, high hipped with triangular dormers, plain, boxed cornice, three bays.
225. T. M. Netherton House (715 Peterson): 1905, E. M. Cole-builder, single, detached, one and a half stories, rectangular, clapboard, irregular roofline, plain cornice with returns, three bays.
226. A. B. Beebe House (716 Peterson): c. 1906, single, detached, two story, square, clapboard, bellcast hipped, cornice boxed, sloped soffit, two bays.
227. E. L. Peterson House (717 Peterson): c. 1907, single, detached, one and a half stories, rectangular, clapboard, high hipped, boxed cornice with sloped soffit, two bays.
228. D. O. Norton (720 Peterson): c. 1905, single, detached, two story, rectangular, clapboard, gambreled, boxed cornice and sloped soffit, two bays.
229. A. E. Dubber House (721 Peterson): 1905, O. E. Long-builder, single, detached, one story, rectangular, clapboard, high hipped, cornice plain with returns, three bays.
230. E. C. Litter House (729 Peterson): c. 1906, single, detached, two and a half stories, square, clapboard, bellcast hipped with bellcast dormers, boxed cornice with brackets, three bays.
231. A. D. Milligan House (801 Peterson): 1904, S. J. Milligan-builder, single, detached, one story, rectangular, clapboard, medium hipped with projecting gable, plain, boxed cornice, three bays.
232. W. R. Todd House (802 Peterson): c. 1907, single, detached, one and a half stories, square, clapboard, crossed gables, closed eaves, two bays.
233. S. East House (805 Peterson): c. 1905, single, detached, one and a half stories, rectangular, clapboard, high hipped boxed cornice with sloping soffit, two bays.
234. H. R. Owen House (806 Peterson): c. 1910, single, detached, one and a half stories, rectangular, clapboard, medium gable, closed eaves, four bays.
235. Neil Graham House (811 Peterson): c. 1908, single, detached, one and a half stories, rectangular, clapboard, bellcast hipped with shed dormers, projecting eaves with exposed rafters, two bays.

UNITED STATES DEPARTMENT OF THE INTERIOR
NATIONAL PARK SERVICE

FOR NPS USE ONLY

RECEIVED JAN 29 1980

DATE ENTERED

**NATIONAL REGISTER OF HISTORIC PLACES
INVENTORY -- NOMINATION FORM**

CONTINUATION SHEET Description ITEM NUMBER 7 PAGE 22

236. O. S. Ace House (812 Peterson): c. 1926, single, detached, one story, rectangular, clapboard, medium gable, projecting eaves with exposed rafters, three bays.
237. T. H. Eves House (815 Peterson): c. 1905, single, detached, one story, rectangular, clapboard, medium gable, projecting eaves with exposed rafters, three bays.
238. R. A. McGinty House (816 Peterson): c. 1920, single, detached, one story, rectangular clapboard, medium gable, projecting eaves with exposed rafters, five bays.
239. L. R. Temple House (817 Peterson): c. 1920, single, detached, one and a half stories, rectangular, clapboard, gambreled, projecting eaves with exposed rafters, seven bays.
240. Lewis Miller House (818 Peterson): c. 1920, single, detached, one story, rectangular, clapboard, medium gable, projecting eaves with exposed rafters, three bays.
241. S. A. Young House (820 Peterson): c. 1900, single, detached, one and a half stories, rectangular, clapboard, high hipped, projecting eaves with exposed rafters, three bays.
242. A. F. Hullatt House (821 Peterson): c. 1905, single, detached, two story, rectangular, clapboard, bellcast hipped, boxed cornice with sloping soffit, three bays.
243. Walter Olin House (824 Peterson): c. 1905, single, detached, one and a half stories, square, clapboard, high hipped, cornice plain with returns, three bays.
244. J. G. O'Hara House (825 Peterson): 1905, R. B. Leonard-builder, single, detached, one story, rectangular, aluminum siding, medium hipped, three bays.
245. H. Hehn House (828 Peterson): c. 1930, single, detached, one story, rectangular, medium hipped gable, cornice plain with returns three bays.
246. W. H. Olin House (829 Peterson): 1905, E. P. Smith-builder, single, detached, two story, rectangular, clapboard, cross gambreled, plain, boxed cornice, four bays.
247. W. A. Blount House (1002 Peterson/409 East Elizabeth): c. 1907, single, detached, one story, irregular plan, composition board, irregular roofline, closed eaves, five bays.

UNITED STATES DEPARTMENT OF THE INTERIOR
NATIONAL PARK SERVICE

FOR NPS USE ONLY

RECEIVED JAN 29 1980

DATE ENTERED

NOT 9

**NATIONAL REGISTER OF HISTORIC PLACES
INVENTORY -- NOMINATION FORM**

CONTINUATION SHEET Description ITEM NUMBER 7 PAGE 23

248. W. E. Pyke House (1014 Peterson): c. 1926, single, detached, one story, square, clapboard, medium gable, boxed cornice, sloped soffit, four bays.
249. German Congregational Church (201 Whedbee): 1904, Montezuma Fuller-architect, single, detached, rectangular plan, painted brick, high gable, single spire-offset right.
250. Sarah Snell House (202 Whedbee): c. 1920, single, detached, one story, irregular plan, clapboard, medium hipped, plain, boxed cornice, five bays.
251. W. B. Brown House (206 Whedbee): 1918, single, detached, one story, rectangular, clapboard, medium gable, eaves projecting-rafters exposed, three bays.
252. Paul Burkhardt House (207 Whedbee): 1904, Lindenmeir Brothers-builders, single, detached, one and a half stories, rectangular, clapboard, high hipped, plain boxed cornice, three bays.
253. Mefford House (208 Whedbee): c. 1926, single, detached, one story, rectangular, clapboard, hipped gable, plain, boxed cornice, three bays.
254. G. J. Dening House (211 Whedbee): 1903, S. J. Milligan-builder, single, detached, one story, irregular plan, stucco, medium hip with projecting gables, plain, boxed cornices, three bays.
255. C. H. Durand House (212 Whedbee): c. 1888, single, detached, one story, L-shaped, clapboard, high gables, cornices boxed, sloped soffit, three bays.
256. E. J. Gregory House (215 Whedbee): 1903, S. J. Milligan-builder, single, detached, one story, rectangular, brick, medium hipped with projecting gable, plain, boxed cornice, two bays.
257. D. G. Markle House (217 Whedbee): 1905, W. L. Gault-builder, single, detached, one and a half stories, rectangular, clapboard, irregular roofline, plain, boxed cornice, three bays.
258. H. H. Voss House (218 Whedbee): c. 1903, single, detached, one and a half stories, L-shaped, clapboard, medium gable, plain, boxed cornice, three bays.
259. Fred M. Harrington House (221 Whedbee): 1901, George W. King-builder, single detached, one story, rectangular, clapboard, medium hipped with projecting gable, plain, boxed cornice, three bays.

UNITED STATES DEPARTMENT OF THE INTERIOR
NATIONAL PARK SERVICE

FOR NPS USE ONLY	
RECEIVED	JAN 29 1980
DATE ENTERED	OCT 3

**NATIONAL REGISTER OF HISTORIC PLACES
INVENTORY -- NOMINATION FORM**

CONTINUATION SHEET Description ITEM NUMBER 7 PAGE 24

260. C. M. Harris House (222 Whedbee): c. 1888, single, detached, two story, irregular plan, clapboard, halifax, plain, boxed cornice, three bays.
261. G. W. Brooks House (225 Whedbee): c. 1900, single, detached, one and a half stories, rectangular, painted brick, high hipped, plain, boxed cornice, three bays.
262. Summit House (226 Whedbee): c. 1900, single, detached, one story, irregular plan, composition board siding, high hipped with projecting gable, plain, boxed cornice, two bays.
263. E. L. Brawner House (228 Whedbee): c. 1902, single, detached, one story, rectangular, clapboard, high hipped, plain, boxed cornice, three bays.
264. M. E. Lewkowicz House (229 Whedbee): c. 1909, single, detached, two story rectangular, clapboard, high hipped, plain, boxed cornice, two bays.
265. Bethlehem Lutheran Church (300 Whedbee): 1914, Ernest Sycott-builder, single, detached, rectangular, grey sandstone, single, center, extension, spire.
266. R. A. Bradley House (301 Whedbee): c. 1908, single, detached, two story, irregular plan, brick high gabled, plain, boxed cornice, four bays.
267. E. A. King House (305 Whedbee): 1902, single, detached, two story, rectangular, aluminum siding over clapboard, medium hipped, boxed cornice with decorated frieze, two bays.
268. J. L. Rowe House I (306 Whedbee): 1902, J. L. Rowe-builder, single, detached, two stories, square, stucco, high hipped, boxed cornice with decorated frieze, two bays.
269. C. J. Corbett House (310 Whedbee): 1904, J. L. Rowe-builder, single, detached, one and a half stories, rectangular, composition board, high hipped with hipped dormer, plain, boxed cornice, three bays.
270. J. C. Beers House (311 Whedbee): c. 1900, single, detached, two story, composition board siding over clapboard, medium hipped, plain, boxed cornice, two bays.
271. C. E. Sears House (314 Whedbee): 1904, J. L. Rowe-builder, single, detached, one story, rectangular, clapboard, high hipped, plain, boxed cornice, two bays.

UNITED STATES DEPARTMENT OF THE INTERIOR
NATIONAL PARK SERVICE

FOR NPS USE ONLY

RECEIVED JAN 20 1980

DATE ENTERED

**NATIONAL REGISTER OF HISTORIC PLACES
INVENTORY -- NOMINATION FORM**

CONTINUATION SHEET Description ITEM NUMBER 7 PAGE 25

272. M. Smith House (315 Whedbee): c. 1900, single, detached, one story, rectangular, composition siding covering clapboard, medium, hipped, plain, boxed cornice, three bays.
273. Chambers House (318 Whedbee): c. 1890, single, detached, one story, square, clapboard, medium gable, plain, boxed cornice, three bays.
274. N. S. Leonard House (319 Whedbee): 1905, R. B. Leonard-builder, single, detached, one story, rectangular, composition board covering clapboard, medium hipped, plain, boxed cornice, three bays.
275. J. Hansen House (322 Whedbee): c. 1900, single, detached, one story, rectangular, clapboard, high hipped with projecting gable, plain, boxed cornice.
276. H. Schmode House (323 Whedbee): c. 1908, single, detached, one and a half story, rectangular, composition board siding over clapboard, high hipped, plain, boxed cornice, three bays.
277. John Gault House (331 Whedbee): 1904, W. L. Gault-builder, single, detached, one story, square, clapboard, high hipped, plain, boxed cornice, three bays.
278. J. F. Consigny House (327 Whedbee): 1905, W. L. Gault-builder, single, detached, one story, rectangular, composition board siding over clapboard, high hipped with projecting gable, plain, boxed cornice with returns, three bays.
279. Adventists Church (400 Whedbee): 1917, single, detached, two and a half stories, L-shaped, clapboard, high gable, plain, boxed cornice, two bays, double leaf door.
280. J. A. Michaud House (404 Whedbee): c. 1908, single, detached, one story, rectangular, clapboard, truncated high hipped, plain, boxed cornice, seven bays.
281. R. T. Smith House (408 Whedbee): c. 1904, single, detached, one story, rectangular, clapboard, high hipped with projecting gable, plain, boxed cornice, four bays.
282. W. J. Tilton House (411 Whedbee): c. 1898, single, detached, one story, square with rear addition (409 Whedbee), clapboard, high hipped, plain, boxed cornice, six bays.
283. O. B. Mosier House (414 Whedbee): 1908, single, detached, one story, square, brick, medium hipped with triangular dormer, plain, boxed cornice, three bays.

UNITED STATES DEPARTMENT OF THE INTERIOR
NATIONAL PARK SERVICE

FOR NPS USE ONLY

RECEIVED JAN 29 1980

DATE ENTERED OCT 13

**NATIONAL REGISTER OF HISTORIC PLACES
INVENTORY -- NOMINATION FORM**

CONTINUATION SHEET Description ITEM NUMBER 7 PAGE 26

284. L. Achzig House I (415 Whedbee): 1905, J. L. Rowe-builder, single, detached, one story, rectangular, composition board, medium hipped, plain, boxed cornice, three bays.
285. C. L. Gladish House (418 Whedbee): c. 1904, single, detached, one and a half stories, rectangular, aluminum siding, medium gable with shed dormers, plain, boxed cornice, enclosed porch obscures the bays.
286. L. Achzig House II (419 Whedbee): 1903, J. L. Rowe-builder, single, detached, one story, rectangular, composition board, cross gable, plain, boxed cornice, three bays.
287. Joseph Yaw House (422 Whedbee): c. 1900, single, detached, one story, rectangular, clapboard, medium hipped with triangular dormer, plain, boxed cornice, three bays.
288. J. W. Smoke House (423 Whedbee): 1899, single, detached, one story, square, clapboard, truncated hipped, plain, boxed cornice, three bays.
289. James Morger House (427 Whedbee): c. 1903, single, detached, one story, rectangular, clapboard, medium hipped with triangular dormer, plain, boxed cornice, three bays.
290. W. T. Early (430 Whedbee): 1908, single, detached, one story, square, clapboard, high hipped with projecting gable, plain, boxed cornice with returns on raking trim, two bays.
291. Rowe House (431 Whedbee): 1903, J.L. Rowe-builder, single, detached, one story, rectangular, clapboard, medium hipped with triangular dormer, plain, boxed cornice, three bays.
292. A. G. Eighme House I (503 Whedbee): 1905, J. L. Rowe-builder, single, detached, one story, rectangular, composition board siding, medium hipped with triangular dormers, plain, boxed cornice, three bays.
293. A. G. Eighme House II (507 Whedbee): 1905, J. L. Rowe-builder, single, detached, one story, rectangular, composition board, medium hipped, plain, boxed cornice, three bays.
294. Hans Bjelland House (510 Whedbee): c. 1904, single, detached, one story, L-shaped, clapboard, high gable, plain, boxed cornice, three bays.

UNITED STATES DEPARTMENT OF THE INTERIOR
NATIONAL PARK SERVICE

**NATIONAL REGISTER OF HISTORIC PLACES
INVENTORY -- NOMINATION FORM**

FOR NPS USE ONLY

RECEIVED JAN 29 1980

DATE ENTERED

- | CONTINUATION SHEET | Description | ITEM NUMBER | PAGE |
|--------------------|--|-------------|------|
| 295. | C. S. McKibben House (511 Whedbee): 1903, W. L. Gault-builder, single, detached, one story, square, brick, medium hipped with projecting gable, three bays. | 7 | 27 |
| 296. | M. H. Huffman House (514 Whedbee): c. 1903, single, detached, one story, square, composition board siding, medium hipped with triangular dormer, plain, boxed cornice, three bays. | | |
| 297. | G. A. McKibben House (515 Whedbee): c. 1900, single, detached, one story, square, stucco, medium hipped with projecting gable, plain, boxed cornice, three bays. | | |
| 298. | M. E. Darnell House (518 Whedbee): 1908, single, detached, one story, rectangular, stucco, high hipped with triangular dormers, plain, boxed cornice, three bays. | | |
| 299. | Tim Gooch House (519 Whedbee): c. 1905, single, detached, one story, rectangular, clapboard, low hipped with projecting gable, three bays. | | |
| 300. | F. D. Gidding House (521 Whedbee): 1902, single, detached, one story, rectangular, perma-stone, low hipped, plain, boxed cornice, three bays. | | |
| 301. | O. Ozias House (522 Whedbee): c. 1918, single, detached, one story, rectangular, composition board, low gable, projecting eaves with exposed rafters, three bays. | | |
| 302. | T. S. Jones House (525 Whedbee): 1909, single, detached, one and a half stories, rectangular, brick, medium gable, gable with overhang dormers, projecting eaves with exposed rafters, three bays, Palladian windows in dormers. | | |
| 303. | W. H. Schuneman House (528 Whedbee): c. 1902, single, detached, one and a half stories, rectangular, brick, medium gable, plain, boxed cornice, three bays. | | |
| 304. | Jeremy O'Connor House (600 Whedbee): c. 1922, single, detached, two story, rectangular, brick, flat, plain, boxed cornice, three bays. | | |
| 305. | R. Warfield House (601 Whedbee): 1922, single, detached, one story, rectangular, clapboard, low hipped projecting eaves with exposed rafters, three bays. | | |
| 306. | C. O. Simonds House (605 Whedbee): c. 1920, single, detached, one and a half stories, rectangular, clapboard, medium hipped with hipped dormers, projecting eaves with exposed rafters, three bays. | | |
| 307. | Cullen House (608 Whedbee): c. 1913, single, detached, one story, rectangular, clapboard, medium hipped, projecting eaves with exposed rafters, three bays. | | |

UNITED STATES DEPARTMENT OF THE INTERIOR
NATIONAL PARK SERVICE

FOR NPS USE ONLY

RECEIVED JAN 29 1980

OCT 3 1980

DATE ENTERED

**NATIONAL REGISTER OF HISTORIC PLACES
INVENTORY -- NOMINATION FORM**

CONTINUATION SHEET Description ITEM NUMBER 7 PAGE 28

308. H. M. Case House (609 Whedbee): c. 1908, single, detached, two story, rectangular, clapboard, high gable, plain, boxed cornice, three bays.
309. R. A. Ellis House (610 Whedbee): c. 1923, single, detached, one story, rectangular, stucco, low hipped projecting eaves with exposed rafters, three bays.
310. E. B. Bullard House (614 Whedbee): 1920, single, detached, one story, rectangular, composition board, low hipped, projecting eaves with exposed rafters, three bays.
311. J. B. Watson House (618 Whedbee): 1923, single, detached, one story, square, brick, high hipped with hipped dormer, projecting eaves with exposed rafters, three bays.
312. W. Fertig House (619 Whedbee): c. 1888, single, detached, two story, square, brick, medium hipped, plain, boxed cornice, three bays.
313. Lynn Dyer House (622 Whedbee): 1923, single, detached, one story, rectangular, medium gable, plain, boxed cornice, two bays.
314. F. H. Niemeyer House (625 Whedbee): c. 1920, single, detached, one story, rectangular, brick, medium gable, projecting eaves with exposed rafters, three bays.
315. Brendan Bosack House (626 Whedbee): single, detached, one story, rectangular, brick, low gable, projecting eaves with exposed rafters, three bays.
316. O. V. Adams (627 Whedbee): c. 1920, single, detached, one and a half stories, square, clapboard, medium gable, projecting eaves with exposed rafters, three bays.
317. T. F. Adams House (630 Whedbee): 1921, single, detached, one story, square, brick, low gable, projecting eaves with exposed rafters, three bays.
318. G. R. McDaniel House (631 Whedbee): 1908, single, detached, two stories, square, brick, cross gambreled, plain, boxed cornice, two bays.
319. D. B. Hollar (634 Whedbee): c. 1920, single, detached, one story, square, brick, medium gable, projecting eaves with exposed rafters, three bays.
320. S. C. Jones House (637 Whedbee): c. 1922, single, detached, one story, rectangular, brick, medium gable, projecting eaves with exposed rafters, three bays.

UNITED STATES DEPARTMENT OF THE INTERIOR
NATIONAL PARK SERVICE

FOR NPS USE ONLY

RECEIVED JAN 29 1980

DATE ENTERED

107 3

**NATIONAL REGISTER OF HISTORIC PLACES
INVENTORY -- NOMINATION FORM**

CONTINUATION SHEET Description ITEM NUMBER 7 PAGE 29

321. E. M. Dodd House (638 Whedbee): c. 1917, single, detached, one story, rectangular, clapboard, medium gable, projecting eaves with exposed rafters, three bays.
322. W. Tarr House (641 Whedbee): 1913, single, detached, one story, rectangular, clapboard, medium gable, plain, boxed cornice with supporting brackets, two bays.
323. R. L. Horney (642 Whedbee): 1923, single, detached, one story, rectangular, clapboard, medium hipped, projecting eaves with exposed rafters, three bays.
324. A. M. Liggett House (645 Whedbee): 1920, single, detached, one story rectangular, clapboard, medium gable, projecting eaves with exposed rafters, three bays.
325. J. A. Alpert (646 Whedbee): c. 1925, single, detached, one story, rectangular, stucco, low gable, projecting eaves with exposed rafters, three bays.
326. H. S. Cutting House (651 Whedbee): 1925, single, detached, one story, rectangular, stucco, low gable, projecting eaves with exposed rafters, three bays.
327. C. C. Williams House (710 Whedbee): c. 1923, detached, one story, rectangular, clapboard, medium gable, projecting eaves with exposed rafters, four bays.
328. R. Becker House (716 Whedbee): c. 1908, single, detached, two story, square, brick, high gable with gable dormer, plain, boxed cornice, three bays, Palladian window in dormer.
329. Peoples Tabernacle (717 Whedbee): c. 1927, single, detached, one story, rectangular, stucco on front facade, other facades are clapboard, medium gable, projecting eaves with exposed rafters, three bays.
330. Mathias Pfeffer House (720 Whedbee): c. 1904, single, detached, one story, square, brick, medium hipped, boxed cornice with sloped soffit, two bays.
331. E. E. Wolf House (722 Whedbee): c. 1908, single, detached, one story, rectangular, brick, medium hipped, projecting eaves with exposed rafters, enclosed porch obscures the number of bays.
332. R. E. Thompson House (801 Whedbee): c. 1924, single, detached, rectangular, clapboard, low gable, projecting eaves with exposed rafters, two bays.
333. Sherman House (802 Whedbee): c. 1918, single, detached, one story, rectangular, aluminum siding, bellcast hipped with triangular dormer, plain, boxed cornice, three bays.

UNITED STATES DEPARTMENT OF THE INTERIOR
NATIONAL PARK SERVICE

**NATIONAL REGISTER OF HISTORIC PLACES
INVENTORY -- NOMINATION FORM**

FOR NPS USE ONLY

RECEIVED JAN 29 1980

DATE ENTERED

CONTINUATION SHEET Description ITEM NUMBER 7 PAGE 30

334. O. H. Nieder House (807 Whedbee): c. 1924, single, detached, one story, rectangular, aluminum siding, low gable, projecting eaves with exposed rafters, three bays.
335. Joseph Branshaw (809 Whedbee): c. 1908, single, detached, one and a half stories, rectangular, clapboard, bellcast hipped with triangular dormers, boxed cornice with sloping soffit, three bays.
336. William Scheller House (814 Whedbee): c. 1925, single, detached, one story, rectangular, stucco, irregular roofline, projecting eaves with exposed rafters, four bays.
337. T. Ferguson House (815 Whedbee): c. 1924, single, detached, one story, square, clapboard, medium hipped, projecting eaves with exposed rafters, two bays.
338. R. C. Hoffman House (817 Whedbee): c. 1920, single, detached, one and a half stories, rectangular, clapboard, medium gable, projecting eaves with exposed rafters, four bays.
339. F. D. Zabell House (821 Whedbee): c. 1921, single, detached one story, rectangular, clapboard, medium gable, projecting eaves, rafters exposed, three bays.
340. G. Charkey House (831 Whedbee): 1925, single, detached, one story, rectangular, clapboard, medium hipped, projecting rafters, exposed eaves, two bays.
341. O. W. Neiswanger (901 Whedbee): c. 1921, single, detached, one story, rectangular, clapboard, medium gable, projecting eaves with exposed rafters, two bays.
342. W. W. Stryker House (905 Whedbee): c. 1924, single, detached, one story, T-shaped, clapboard, medium gable, projecting eaves with exposed rafters, two bays.
343. W. N. Culbertson House (909 Whedbee): c. 1921, single, detached, one story, square, clapboard, medium gable, projecting eaves with exposed rafters, three bays.
344. J. G. Moon House (111 Riverside): c. 1908, single, detached, one story, square, clapboard, medium hipped gable, plain, boxed cornice, three bays.
345. Old Catholic Church (115 Riverside): 1875, converted into a residence in 1905, single, detached, one story, rectangular, stucco, high gable, projecting eaves with exposed rafters, three bays.

UNITED STATES DEPARTMENT OF THE INTERIOR
NATIONAL PARK SERVICE

FOR NPS USE ONLY

RECEIVED JAN 29 1980 3

DATE ENTERED

**NATIONAL REGISTER OF HISTORIC PLACES
INVENTORY -- NOMINATION FORM**

CONTINUATION SHEET Description ITEM NUMBER 7 PAGE 31

346. Carl Espelin House (121 Riverside): c. 1907, single, detached, one story, square, clapboard, high hipped gable, plain, boxed cornice, three bays.
347. Anna Cook House (123 Riverside): single, detached, one story, square, clapboard, high hipped gable, plain, boxed cornice, three bays.
348. Blunk House (318 E. Oak): 1907, single detached, two and a half stories, rectangular, brick, bellcast hipped with shed dormer boxed cornice with brackets, three bays.
349. Andrews House II (322 E. Oak): 1893, Montezuma Fuller-architect, single, detached, two story, rectangular, brick, irregular roofline, boxed cornice, sloped soffit, three bays.
350. Andrews House I (324 E. Oak): This building is already on the National Register of Historic Places.
351. Perry House (330 E. Oak): single, detached, one story, square, shingle, medium gable, plain boxed cornice, two bays.
352. E. R. Baker House (334 E. Oak): single, detached, one and a half stories, irregular plan, stucco/aluminum, low gable, plain, boxed cornice.
353. E. J. Bennett House (336 E. Oak): single, detached, one and a half stories, irregular plan, stucco, medium gable, projecting eaves with exposed rafters, three bays.
354. S. Batterson House (402 E. Oak): 1904, S. J. Milligan-builder, single, detached, one and a half stories, rectangular, brick, medium truncated hipped, boxed cornice with sloping soffit, two bays.
355. Deaver House (404 E. Oak): c. 1920, single, detached, one and a half stories, rectangular, brick, medium gable, projecting eaves with exposed rafters, two bays.
356. Edward Suiter House (410 E. Oak): c. 1890, single, detached, one and a half stories, rectangular, clapboard, irregular roofline with shed dormer, plain, boxed cornice, three bays.
357. B. C. Collins House (411 E. Oak): c. 1926, single, detached, one story, rectangular, composition board siding, medium gable, projecting eaves with rafters exposed, three bays.

UNITED STATES DEPARTMENT OF THE INTERIOR
NATIONAL PARK SERVICE

FOR NPS USE ONLY

RECEIVED JAN 29 1980

DGT 3-1-1

DATE ENTERED

**NATIONAL REGISTER OF HISTORIC PLACES
INVENTORY -- NOMINATION FORM**

CONTINUATION SHEET Description ITEM NUMBER 7 PAGE 32

358. Calvin House (413 E. Oak): c. 1920, single, detached, one story, rectangular, composition board siding, medium hipped, plain, boxed cornice, three bays.
359. W. J. Childs House (414 E. Oak): c. 1899, single, detached, one story, L-shaped, clapboard, high gable, plain, boxed cornice, three bays.
360. C. A. Brannaman House (418 E. Oak): c. 1910, single, detached, one and a half stories, rectangular, brick, hipped gable, boxed cornice, sloped soffit, three bays.
361. C. Clemens House (422 E. Oak): 1902, single, detached, one and a half stories, rectangular, brick, high gable, projecting eaves with exposed rafters, four bays.
362. Hoffman House (426 E. Oak): c. 1887, single, detached, two story, rectangular, clapboard, hipped gable, gable dormers, cornice boxed, five bays.
363. Wisdom House (500 E. Oak): c. 1903, single, detached, one story, square clapboard, irregular roofline, plain, boxed cornice, three bays.
364. S. F. Webster House (301 E. Olive): c. 1917, single, detached, two and a half stories, brick, square, high hipped with shed dormer, boxed cornice, brackets present, four bays.
365. A. M. Woods House (315 E. Olive): c. 1890, single, detached, one and a half stories, rectangular, high gable, plain, boxed cornice, three bays.
366. A. M. Wilkin House (317 E. Olive): c. 1902, single, detached, one story, rectangular, clapboard, high gable with projecting gable, plain, boxed cornice, three bays.
367. C. S. Miner House (321 E. Olive): 1904, C. A. Button-builder, single, detached, one and a half stories, square, composition board siding, high hipped with triangular dormers, plain, boxed cornice, three bays.
368. W. H. Roller House (325 E. Olive): 1902, single, detached, one and a half stories, rectangular, composition board, high hipped with projecting gables, plain, boxed cornice, two bays.
369. J. B. Beals House (329 E. Olive): 1905, single, detached, one and a half stories, rectangular, clapboard, high hipped with projecting gables, two bays.

UNITED STATES DEPARTMENT OF THE INTERIOR
NATIONAL PARK SERVICE

FOR NPS USE ONLY

RECEIVED JAN 29 1980

DATE ENTERED

757 3

**NATIONAL REGISTER OF HISTORIC PLACES
INVENTORY -- NOMINATION FORM**

CONTINUATION SHEET Description ITEM NUMBER 7 PAGE 33

370. Old Hospital Building (301 E. Magnolia): 1906, Herman Schoeder-builder, single, detached, three stories, rectangular, brick, bellcast hipped with bellcast hipped dormers, plain, boxed cornice, three bays.
371. Halley House (302 E. Magnolia): 1901, Montezuma Fuller-architect, single, detached, two stories, rectangular, stucco, bellcast hipped with triangular dormer, boxed cornice with decorated frieze, two bays, two story French bay on west facade.
372. Kortz House (305 E. Magnolia): c. 1897, single, detached, two story, irregular plan, brick, irregular roofline, plain, boxed cornice with returns on the raking trim, two bays.
373. Evans House (306 E. Magnolia): c. 1902, single, detached, two story, rectangular, clapboard, bellcast hipped with bellcast hipped dormer, boxed cornice with supporting brackets.
374. B. F. Herlin House (308 E. Magnolia): c. 1905, single, detached, two stories, square with rear wing addition, bellcast hipped with bellcast hipped dormer, boxed cornice with brackets, three bays.
375. A. C. Nelson House (311 E. Magnolia): 1903, H. W. Schroeder-builder, single, detached, two stories, rectangular, brick, bellcast hipped with bellcast hipped dormer, boxed cornice with decorated frieze.
376. Rew House (312 E. Magnolia): c. 1905, single, detached, one and a half stories, rectangular with rear addition, brick, high gable, plain, boxed cornice with return on the raking trim, three bays.
377. W. G. Ralph House (315 E. Magnolia): c. 1901, single, detached, two stories, rectangular, clapboard, medium hipped, plain, boxed cornice, three bays.
378. John Sedgley House (316 E. Magnolia): c. 1900, single, detached, one story, T-shaped, perma-stone siding, medium gable, boxed cornice with sloped soffit, two bays.
379. A. C. Kluver House I (319 E. Magnolia): c. 1925, single, detached, one and a half stories, rectangular, brick, truncated hipped with projecting gables, plain, boxed cornice, three bays.
380. Ole Helgesen House (320 E. Magnolia): c. 1900, single, detached, one story, rectangular, stucco, medium gable, projecting rafters with exposed eaves, three bays.

UNITED STATES DEPARTMENT OF THE INTERIOR
NATIONAL PARK SERVICE

**NATIONAL REGISTER OF HISTORIC PLACES
INVENTORY -- NOMINATION FORM**

FOR NPS USE ONLY

RECEIVED JAN 8 8 1980

DATE ENTERED OCT 8

CONTINUATION SHEET Description ITEM NUMBER 7 PAGE 34

381. A. C. Kluver House II (323 E. Magnolia): c. 1921, single, detached, one and a half stories, rectangular, brick, medium hipped gable, projecting eaves with exposed rafters, two bays.
382. E. B. Pierce House (324 E. Magnolia): c. 1900, single, detached, one and a half stories, clapboard, rectangular, medium gable, projecting eaves with exposed rafters, two bays.
383. M. M. Huffman House (328-330 E. Magnolia): c. 1900, single, detached, one and a half stories, square, clapboard, truncated medium hip with triangular dormers, boxed cornice with sloped soffit, four bays.
384. J. B. Webster House (332 E. Magnolia): c. 1900, single, detached, one story, rectangular, clapboard, medium gable, plain, boxed cornice, three bays.
385. A. S. Carner House (335 E. Magnolia): c. 1903, single, detached, one story, rectangular, aluminum siding medium gable, plain, boxed cornice, three bays.
386. Brown Thompson House (336 E. Magnolia): c. 1900, single, detached, one story, rectangular, clapboard, medium gable, plain, boxed cornice, three bays.
387. C. J. Hayes House (417 E. Magnolia): c. 1908, single, detached, one story, rectangular, clapboard, medium gable, plain, boxed cornice, three bays.
388. Godsey House (419 E. Magnolia): c. 1910, single, detached, one and a half stories, rectangular, stucco, high hipped, closed eaves, one bay.
389. J. S. Thomas House (425 E. Magnolia): single, detached, one and a half stories, rectangular, clapboard, bellcast hipped with a shed dormer, cornice boxed with sloped soffit, two bays.
390. Carpenter's Hall (429 Magnolia): c. 1913, single detached, two story, rectangular, brick, flat, parapet, plain, five bays.
391. House (500 E. Magnolia): c. 1905, single, detached, two story, square, clapboard, bellcast hip, plain boxed cornice, two bays.
392. Miner Carriage House (215 E. Mulberry): Single, detached, two story, rectangular, brick, medium gable with triangular dormers, plain, boxed cornice, two bays.
393. Baker House (304 E. Mulberry): This house is already on the National Register.

UNITED STATES DEPARTMENT OF THE INTERIOR
NATIONAL PARK SERVICE

FOR NPS USE ONLY

RECEIVED JAN 29 1980

DATE ENTERED

3

**NATIONAL REGISTER OF HISTORIC PLACES
INVENTORY -- NOMINATION FORM**

CONTINUATION SHEET Description ITEM NUMBER 7 PAGE 35

394. E. Meyer House (309 E. Mulberry): 1905, O. E. Long-builder, single, detached, one story, rectangular, brick, bellcast hipped with bellcast hipped dormer, plain, boxed cornice, three bays.
395. A. B. Flickinger House (311 E. Mulberry): c. 1905, single, detached, one story, square, clapboard, medium hipped with projecting gable, plain, boxed cornice, three bays.
396. Fothergill House I (312 E. Mulberry): c. 1905, single, detached, two and a half stories, rectangular, brick, bellcast hipped with hipped dormer, plain boxed cornice, two bays.
397. Replogle House (314 Mulberry): c. 1905, single, detached, one and a half stories, irregular shape with recent rear addition, brick, high gabled with triangular gable, plain, boxed cornices, three bays.
398. C. E. Morrison House (317 E. Mulberry): c. 1900, single, detached, one story, T-shaped, clapboard, medium gable, boxed cornice with sloped soffit, three bays.
399. Brooks House (320 E. Mulberry): 1902, single, detached, one story, rectangular, brick, truncated hipped with projecting gable and triangular gables, boxed cornice with decorated frieze, three bays.
400. J. M. Calvert House (321 E. Mulberry): c. 1900, single, detached, one story, T-shaped, clapboard, medium gable, boxed cornice with sloping soffit, two bays.
401. Clark House (324 E. Mulberry): c. 1924, single, detached, one story, low hipped, projecting eaves with exposed rafters, three bays.
402. H. W. Patterson House (325 E. Mulberry): 1905, Albert Bryan-architect, single, detached two-story, square, brick, bellcast hipped with bellcast hipped dormer, projecting eaves with exposed rafters, three bays.
403. Walden House (330 E. Mulberry): c. 1924, single, detached, one story, rectangular, clapboard, medium gabled roof, projecting eaves with exposed rafters, three bays.
404. Arthur House (334 E. Mulberry): 1882, Richard Burke-builder, single, detached, two and a half stories, irregular plan, brick, irregular roofline, plain, boxed cornice, three bays.

UNITED STATES DEPARTMENT OF THE INTERIOR
NATIONAL PARK SERVICE

FOR NPS USE ONLY

RECEIVED JAN 29 1980

DATE ENTERED

**NATIONAL REGISTER OF HISTORIC PLACES
INVENTORY -- NOMINATION FORM**

CONTINUATION SHEET Description ITEM NUMBER 7 PAGE 36

405. Henry Schmer House (413 E. Mulberry): c. 1927, single, detached, one story, rectangular, clapboard, high gable, projecting eaves with exposed rafters, three bays.
406. P. B. Smith House (417 E. Mulberry): c. 1878, single, detached, one story rectangular, clapboard, truncated hipped, plain, boxed cornice, three bays.
407. House (503 E. Mulberry): single, detached, rectangular, one story, clapboard, high hip roof, plain boxed cornice, three bays.
408. Thorburn House (214 E. Myrtle): c. 1925, single, detached, one story rectangular, clapboard, low hipped, plain, boxed cornice, three bays.
409. W. F. Crossley House (300 E. Myrtle): c. 1900, single, detached, one and a half stories, irregular plan, stucco, irregular roofline, hipped dormers, plain, boxed cornice, four bays.
410. J. F. Farrar House (304 E. Myrtle): c. 1907, single, detached, one and a half stories, rectangular, clapboard, bellcast gable, plain, boxed cornice, three bays.
411. H. F. Elliott House (308 E. Myrtle): c. 1907, single, detached, one and a half stories, rectangular, clapboard, bellcast gable, plain, boxed cornice, three bays.
412. E. C. Cochran House (312 E. Myrtle): single, detached, two and a half stories, square, clapboard, high hipped with shed dormer, cornice boxed, brackets present, three bays.
413. H. Graham House (318 E. Myrtle): c. 1900, single, detached, one story, L-shaped, clapboard, medium gable, plain, boxed cornice, three bays.
414. House (325 E. Myrtle): c. 1920, single, detached, one story, rectangular, stucco, medium hipped roof, projecting eaves with exposed rafters, two bays.
415. W. R. Drake House (326 E. Myrtle): c. 1924, single, detached, one and a half stories, rectangular, brick, medium hipped gable, projecting eaves with exposed rafters, three bays.
416. House (327 E. Myrtle): c. 1900, single, detached, one and one half stories, T-shaped, clapboard, medium hipped, plain boxed cornice, two bays.

UNITED STATES DEPARTMENT OF THE INTERIOR
NATIONAL PARK SERVICE

**NATIONAL REGISTER OF HISTORIC PLACES
INVENTORY -- NOMINATION FORM**

FOR NPS USE ONLY

RECEIVED JAN 30 1980

DATE ENTERED OCT 3

CONTINUATION SHEET Description ITEM NUMBER 7 PAGE 37

417. J. A. Leiby House (330 E. Myrtle): c. 1924, single, detached, one story, rectangular, clapboard, low hipped gable, projecting eaves with exposed rafters, four bays.
418. Cant House (419 E. Myrtle): c. 1918, single, detached, one story, rectangular, stones/stucco, medium hipped, projecting eaves with exposed rafters, four bays.
419. C. E. Simpson House (317 E. Laurel): c. 1901, single, detached, one story, square, aluminum siding, medium hip, plain, boxed cornice, three bays.
420. E. P. Montgomery House (321-323 E. Laurel): c. 1905, double, semi-detached, one and a half stories, rectangular, brick, bellcast hipped, plain, boxed cornice, six bays.
421. Laurel Street Grocery (325 E. Laurel): c. 1905, single, detached, one story, rectangular, clapboard/stucco, hipped gable, verges closed, three bays.
422. Laurel Street School (330 E. Laurel): 1906, Montezuma Fuller - architect, single, detached, two and a half stories, rectangular, brick, low hipped, boxed cornice with decorated frieze and brackets, nine bays.
423. L. W. Tresner House (401 E. Laurel): 1909, L. W. Tresner-builder, single, detached, one and a half stories, rectangular, clapboard, medium gable, projecting eaves with exposed rafters, three bays.
424. S. Ross House (405 E. Laurel): c. 1908, single, detached, one story, rectangular, clapboard, bellcast hipped with shed dormer, plain, boxed, cornice, three bays.
425. H. A. Black House (411 E. Laurel): 1904, E. M. Cole-builder, single, detached, two stories, square, clapboard, irregular roofline, plain, boxed, cornice, two bays.
426. A. H. Ricker House (412 E. Laurel): c. 1922, single, detached, one story, rectangular, shake, medium hip, projecting eaves with exposed rafters, four bays.
427. Peter Hussey House (415 E. Laurel): c. 1907, single, detached, one story, square, high hip with projecting gables, plain, boxed, cornice, three bays.
428. W. A. Olson House (419 E. Laurel): 1908, single, detached, one story, rectangular, brick, medium hipped with triangular dormer, plain, boxed, cornice, three bays.

UNITED STATES DEPARTMENT OF THE INTERIOR
NATIONAL PARK SERVICE

FOR NPS USE ONLY

RECEIVED JAN 29 1980

DATE ENTERED

107 3

**NATIONAL REGISTER OF HISTORIC PLACES
INVENTORY -- NOMINATION FORM**

CONTINUATION SHEET Description ITEM NUMBER 7 PAGE 38

429. Jackson Norris House (421 E. Laurel): c. 1903, single, detached, one story, rectangular, brick, bellcast, hipped, plain, boxed, cornice, three bays.
430. J. M. Glick House (425 E. Laurel): c. 1903, single, detached, one story, rectangular, brick, bellcast hipped, plain, boxed, cornice, three bays.
431. A. J. Farrar House (431 E. Laurel): c. 1904, single, detached, one and a half stories, rectangular, clapboard, medium hip, plain, boxed cornice, three bays.
432. House (501 E. Laurel): c. 1908, single, detached, one-story rectangular, clapboard, medium gable, projecting eaves with exposed rafters, three bays.
433. Remington Arms Apartments (200 E. Plum): c. 1925, single, detached, three and a half stories, rectangular, brick, high hipped with projecting gables and hipped dormers, five bays.
434. C. H. Hook House (201 E. Plum): 1905, E. P. Smith-builder, single, detached, one and a half stories, rectangular, brick, high hipped with triangular dormers, plain, boxed cornice, three bays.
435. Jane Hook House (205 E. Plum): c. 1905, single, detached, one and a half stories, irregular plan, stucco, irregular roofline, plain, boxed cornice, two bays.
436. J. A. Ellis House (209 E. Plum): c. 1905, single, detached, two story, irregular plan, brick, gambreled, closed eaves, four bays.
437. L. E. Lemaster House (219 E. Plum): c. 1911, single, detached, two story, square, brick, low hipped, plain, boxed cornice, three bays.
438. T. Reinholtz House (223 E. Plum): c. 1911, single, detached, two story, square, brick/clapboard, bellcast hipped gable, cornice boxed, brackets present, two bays.
439. Blystone-Kiff House (301-303 E. Plum): c. 1905, single, detached, two and a half stories, square, clapboard/stucco, medium gable, projecting eaves with exposed rafters, four bays.
440. G. A. Rapp House I (307 E. Plum): 1905, G. A. Rapp-builder, single, detached, one and a half stories, rectangular, stucco, bellcast hipped gable with triangular dormers, plain, boxed cornice, six bays.

UNITED STATES DEPARTMENT OF THE INTERIOR
NATIONAL PARK SERVICE

FOR NPS USE ONLY

RECEIVED JAN 29 1980

DATE ENTERED OCT 3

**NATIONAL REGISTER OF HISTORIC PLACES
INVENTORY -- NOMINATION FORM**

CONTINUATION SHEET Description ITEM NUMBER 7 PAGE 39

441. G. A. Rapp House II (311 E. Plum): 1905, G. A. Rapp-builder, single, detached, one and a half stories, rectangular, brick, high gable, plain, boxed cornice with returns present, three bays.
442. J. R. Crawford House (315 E. Plum): 1905, Roys and Hampton-builder, single, detached, one and half stories, rectangular, clapboard, bellcast hipped gable, plain, boxed cornice, three bays.
443. R. G. Slocum House (316 E. Plum): 1905, Roys and Hampton-builder, single, detached, one story, rectangular, clapboard, bellcast hipped with bellcast hipped dormer, plain, boxed cornice, two bays.
444. John Schalk House (319 E. Plum): single, detached, one and a half stories, stucco, high gable with shed dormer, projecting eaves with exposed rafters, three bays.
445. A. F. Huleatt House (320 E. Plum): 1905, A. F. Huleatt-builder, single, detached, two story, square, aluminum siding/permastone, bellcast hipped with bellcast hipped dormer, plain, boxes cornice, two bays.
446. A. H. Butts House (323 E. Plum): 1906, A. H. Butts-builder, single, detached, two stories, square, clapboard, bellcast hipped with shed dormer, plain, boxed cornice, three bays.
447. G. P. Butler House (324 E. Plum): 1904, single, detached, one story, rectangular, stucco, medium hipped gable with triangular dormer, three bays.
448. T. J. Shreve House (326 E. Plum): c. 1905, single, detached, one story, rectangular, clapboard, bellcast hipped gable, plain, boxed cornice, three bays.
449. R. L. Parkerson House (327 E. Plum): c. 1921, single, detached, one and a half stories, L-shaped, clapboard, medium gable, plain, boxed cornice, three bays.
450. L. E. Kerr House (330 E. Plum): 1905, O. E. Long-builder, single, detached, one story, rectangular, clapboard, medium hipped gable with triangular dormer, plain, boxed cornice, three bays.
451. K. Miller House (402 E. Plum): c. 1903, single, detached, one and a half stories, rectangular, clapboard, high gable with projecting triangular dormers, closed eaves, four bays.

UNITED STATES DEPARTMENT OF THE INTERIOR
NATIONAL PARK SERVICE

FOR NPS USE ONLY

RECEIVED

JAN 29 1980

DATE ENTERED

**NATIONAL REGISTER OF HISTORIC PLACES
INVENTORY -- NOMINATION FORM**

CONTINUATION SHEET Description ITEM NUMBER 7 PAGE 40

452. C. R. Todd House (411 E. Plum): c. 1927, single, detached, two story, rectangular, stucco, hipped gable, projecting eaves with exposed rafters, three bays.
453. C. M. Riddle House (412 E. Plum): c. 1905, single, detached, one and a half stories, rectangular, composition board, medium hipped with triangular dormer, plain, boxed cornice, four bays.
454. A. F. Schroder House (415 E. Plum): c. 1924, single, detached, one story, rectangular, clapboard, low gable, projecting eaves with exposed rafters, three bays.
455. C. A. Jensen House (416 E. Plum): c. 1921, single, detached, one story, rectangular, aluminum siding, medium gable, projecting eaves with exposed gables, three bays.
456. F. J. Short House (417 E. Plum): c. 1908, single, detached, one story, rectangular, clapboard, medium hipped, plain, boxed cornice, three bays.
457. F. G. Askew House (420 E. Plum): c. 1921, single, detached, one and a half bays, square, high gable with shed dormer, projecting eaves with exposed rafters, three bays.
458. H. A. Thompson House (423 E. Plum): single, detached, one story, rectangular, aluminum siding, medium gable, plain, boxed cornice, two bays.
459. C. H. Weaver House (424 E. Plum): c. 1923, single, detached, one story, rectangular, aluminum siding, medium gable, plain, boxed cornice, two bays.
460. G. W. Draper House (430 E. Plum): c. 1923, single, detached, one story, rectangular, clapboard, low hipped, projecting eaves with exposed rafters, three bays.
461. House (500 E. Plum): (NO DESCRIPTION)
462. N. D. Moore House (209 E. Locust): c. 1925, single, detached, one story, rectangular, clapboard/composition board, medium gable, plain, boxed cornice, two bays.
463. M. G. Conley House (202 E. Elizabeth): c. 1905, single, detached, two story, square, high hipped projecting eaves with exposed rafters, two bays.

UNITED STATES DEPARTMENT OF THE INTERIOR
NATIONAL PARK SERVICE

FOR NPS USE ONLY

RECEIVED JAN 29 1980

DATE ENTERED

DEC 3

**NATIONAL REGISTER OF HISTORIC PLACES
INVENTORY -- NOMINATION FORM**

CONTINUATION SHEET Description ITEM NUMBER 7 PAGE 41

464. O. Benncock House (206 E. Elizabeth): c. 1906, single, detached, one story, rectangular, clapboard, medium hipped with shed dormer, plain, boxed cornice, two bays.
465. F. A. Carlson House (210 E. Elizabeth): c. 1906, single, detached, two story, square, clapboard, medium hipped, plain, boxed cornice, two bays.
466. Endicott House (214 E. Elizabeth): c. 1906, single, detached, two story, square, high gable with projecting gables, plain, boxed cornice with returns present, three bays.
467. Fred Weitzel House (215 E. Elizabeth): c. 1925, single, detached, one story, rectangular, stucco, medium gable, projecting eaves with exposed rafters, two bays.
468. L. H. Hoffman House (219 E. Elizabeth): c. 1924, single, detached, one story, rectangular, stucco, medium gable, projecting eaves, exposed rafters, three bays.
469. George Morton House (220 E. Elizabeth): c. 1905, single, detached, one and a half stories, rectangular, clapboard, bellcast hipped with shed dormer, plain, boxed cornice, three bays.
470. D. C. Colton House (224 E. Elizabeth): c. 1905, single, detached, one and a half stories, rectangular, clapboard, bellcast hipped, plain, boxed cornice, two bays.
471. S. C. Blystone House (300 E. Elizabeth): c. 1905, single, detached, one and a half stories, square, shake/clapboard, center gable, plain, boxed cornice, two bays.
472. C. W. Jensen House (310 E. Elizabeth): c. 1925, single, detached, one story, rectangular, clapboard, medium gable, projecting eaves with exposed rafters, three bays.
473. W. W. Cakebread House (325 E. Elizabeth): c. 1904, single, detached, one story, square, stucco, medium hipped, plain, boxed cornice, three bays.
474. W. F. Deatricks House (329 E. Elizabeth): 1904, single, detached, one story, square, stucco, medium hipped with projecting triangular dormers, plain, boxed cornice, three bays.

UNITED STATES DEPARTMENT OF THE INTERIOR
NATIONAL PARK SERVICE

FOR NPS USE ONLY

RECEIVED JAN 29 1980

DATE ENTERED

3

**NATIONAL REGISTER OF HISTORIC PLACES
INVENTORY -- NOMINATION FORM**

CONTINUATION SHEET Description ITEM NUMBER 7 PAGE 42

475. M. L. Scott House (339 E. Elizabeth): c. 1925, single, detached, one and a half stories, rectangular, brick, medium gable, projecting eaves with exposed rafters, three bays.
476. E. A. Wylie House (400 E. Elizabeth): c. 1925, single, detached, one story, rectangular, clapboard, medium gable, projecting eaves with exposed rafters, three bays.
477. Irwin Drafer House (408 E. Elizabeth): c. 1927, single, detached, one story, rectangular, clapboard, medium gable, projecting eaves with exposed rafters, two bays.
478. W.A. Blount House (409 E. Elizabeth): c. 1917, single, detached, one story, irregular plan, composition board, irregular roofline, verges closed, five bays.
479. Burnham-Vaughniaux House (412 E. Elizabeth): c. 1926, single, detached, one story, rectangular, stucco, medium hipped, projecting eaves with exposed rafters, three bays.
480. C. A. Rockwell House (413 E. Elizabeth): c. 1903, single, detached, one story, square, clapboard, high gable with projecting gable, plain, boxed cornice, two bays.
481. H. K. Meyer House (414 E. Elizabeth): c. 1926, single, detached, one story, rectangular, stucco, medium hipped with triangular dormer, projecting eaves with exposed rafters, three bays.
482. E. Kimple House (415 E. Elizabeth): c. 1904, single, detached, one story, rectangular, clapboard, high hipped, plain, boxed cornice, three bays.
483. Pick House (416 E. Elizabeth): c. 1926, single, detached, one story, rectangular, stucco, low hipped with shed dormer, projecting eaves with exposed rafters, three bays.
484. Match House (420 E. Elizabeth): c. 1924, single, detached, one story, rectangular, stucco, medium gable, projecting eaves with exposed rafters, three bays.
485. S. J. Beavers House (424 E. Elizabeth): 1924, single, detached, one story, rectangular, clapboard, medium gable, projecting eaves with exposed rafters, three bays.

UNITED STATES DEPARTMENT OF THE INTERIOR
NATIONAL PARK SERVICE

FOR NPS USE ONLY

RECEIVED JAN 29 1980

DATE ENTERED 107 3

**NATIONAL REGISTER OF HISTORIC PLACES
INVENTORY -- NOMINATION FORM**

CONTINUATION SHEET Description ITEM NUMBER 7 PAGE 43

486. George Spencer House (425 E. Elizabeth): c. 1890, single, detached, one and a half stories, irregular plan, aluminum siding, irregular roofline, plain, boxed cornice, five bays.
487. J. D. Hill House (428 E. Elizabeth): c. 1924, single, detached, one story, rectangular, clapboard, medium hipped with shed dormer, projecting eaves with exposed rafters, three bays.
488. Carriers House (430 E. Elizabeth): c. 1924, single, detached, one story, rectangular, clapboard, medium gable with shed dormer, plain, boxed cornice, three bays.
489. Henry Burdorf House (121 E. Garfield): c. 1924, single, detached, two and a half stories, square, stucco, hipped Halifax with hipped gable dormer, projecting eaves with exposed rafters, three bays.
490. J. O. Mosman House (206 E. Garfield): 1904, J. L. Rowe-builder, single, detached, one story, rectangular, composition board, medium hipped with projecting gable, plain, boxed cornice, five bays.
491. Alex Emslie House (214 E. Garfield): c. 1926, single, detached, one story, rectangular, stucco, medium gable, projecting eaves with exposed rafters, three bays.
492. Summers-Long House (216 East Garfield): c. 1924, single, detached, one story, rectangular, stucco, medium gable, projecting eaves with exposed rafters, three bays.
493. A. T. Crary House (304 E. Garfield): c. 1900, single, detached, one and a half stories, L-shaped, clapboard, medium gable with shed dormer, projecting eaves with exposed rafters.
494. Daniel Secrist House (308 E. Laurel): c. 1900, single, detached, one story, square, clapboard, medium gable with projecting gables, plain, boxed cornice, three bays.
495. M. H. Mitchell House (312 E. Garfield): c. 1924, single, detached, one story, square, clapboard, medium hipped, projecting eaves with exposed rafters, two bays.
496. J. S. Kirkpatrick House (315 E. Garfield): c. 1924, single, detached, one story, rectangular, brick/stucco, medium gable, projecting eaves with exposed rafters, three bays.

UNITED STATES DEPARTMENT OF THE INTERIOR
NATIONAL PARK SERVICE

FOR NPS USE ONLY

RECEIVED JAN 29 1980

DATE ENTERED

JAN 3

**NATIONAL REGISTER OF HISTORIC PLACES
INVENTORY -- NOMINATION FORM**

CONTINUATION SHEET Description ITEM NUMBER 7 PAGE 44

497. S. J. King House (316 E. Garfield): c. 1900, single, detached, one and a half stories, rectangular, clapboard, high gable with projecting gables, plain, boxes, cornice, three bays.
498. Emerson, Kirkpatrick House (321 E. Garfield): 1905, C. L. Goursday-builder, single, detached, one and a half stories, square, brick, medium hipped with triangular dormers, plain, boxed cornice, two bays.
499. J. W. Webb House (322 E. Garfield): c. 1911, single, detached, one and a half stories, rectangular, brick, medium hipped with hipped dormer, projecting eaves with exposed rafters, two bays.
500. C. F. Gardner House (325 E. Garfield): c. 1900, single, detached, one and a half stories, square, shake/clapboard, medium gable with sided dormer, plain, boxed cornice, three bays.
501. E. W. Morgan House (326 E. Edwards): c. 1905, single, detached, one and a half stories, square, brick, cross gable, boxed cornice, sloped soffit, three bays.
502. J. A. Harris House (327 E. Garfield): 1905, S. J. Milligan-builder, single, detached, one story, rectangular, composition board, medium hipped, plain, boxed cornice, three bays.
503. Goodrich House (331 E. Garfield): 1905, S. J. Milligan-builder, single, detached, one story, rectangular, composition board, medium hipped, projecting eaves with exposed rafters, two bays.
504. Kimmons House (336 E. Garfield): c. 1900, single, detached, two story, square, aluminum siding, medium hipped, plain, boxed cornice, two bays.
505. M. B. Christman House (406 E. Garfield): 1902, single, detached, one and a half stories, rectangular, clapboard, high gable with side dormer, plain, boxed cornice, three bays.
506. R. N. Strang House (409 E. Garfield): c. 1910, single, detached, one story, rectangular, brick, medium hipped with shed dormer, projecting eaves with exposed rafters, two bays.
507. I. O. Knapp House (411 E. Garfield): c. 1910, single, detached, one and a half stories, square, stucco, cross gable, plain, boxed cornice with returns present, two bays.

UNITED STATES DEPARTMENT OF THE INTERIOR
NATIONAL PARK SERVICE

FOR NPS USE ONLY

RECEIVED JAN 29 1980

DATE ENTERED

**NATIONAL REGISTER OF HISTORIC PLACES
INVENTORY -- NOMINATION FORM**

CONTINUATION SHEET Description ITEM NUMBER 7 PAGE 45

508. E. E. Polley House (412 E. Garfield): c. 1925, single, detached, one story, rectangular, stucco, medium gable, projecting eaves with exposed rafters, three bays.
509. M. Frances House (415 E. Garfield): c. 1921, single, detached, one story, rectangular, composition board, medium gable, projecting gable with exposed rafters, three bays.
510. M. C. Bassett House (417 E. Garfield): c. 1907, single, detached, one and a half stories, rectangular, clapboard, bellcast hipped with shed dormer, plain, boxed cornice, three bays.
511. W. Ganer House (418 E. Garfield): c. 1900, single, detached, one and a half stories, rectangular, clapboard, medium gable with projecting gables, plain, boxed cornice, three bays.
512. Jesse Harris House (420 E. Garfield): 1901, single, detached, one story, rectangular, composition board, medium hipped, plain, boxed cornice, three bays.
513. L. H. Thorne House (423 E. Garfield): c. 1900, single, detached, one story, rectangular, composition board, medium gable, projecting eaves with exposed rafters, three bays.
514. T. J. Lewis House (426 E. Garfield): c. 1890, single, detached, one story, square, clapboard, irregular roofline, plain, boxed cornice, four bays.
515. T. W. Brown House (429 E. Garfield): c. 1902, single, detached, one and a half stories, rectangular, clapboard, bellcast hipped, plain, boxed cornice, five bays.
516. Charles Oliver House (430 E. Garfield): c. 1897, single, detached, one and a half stories, rectangular, clapboard, irregular roofline, plain, boxed cornice, three bays.
517. R. W. Wallace House (215 E. Edwards): c. 1905, single, detached, one and a half stories, rectangular, clapboard, high gable, plain, boxed cornice, three bays.
518. A. F. Landers House (220 E. Edwards): 1904, J. L. Rowe-builder, single, detached, one and a half stories, rectangular, stucco, hipped gable with rear intersecting gable, projecting eaves with exposed rafters, four bays.
519. M. Landers House (221 E. Edwards): c. 1911, single, detached, one story, rectangular, clapboard, irregular roofline, plain, boxed cornice, three bays.

UNITED STATES DEPARTMENT OF THE INTERIOR
NATIONAL PARK SERVICE

FOR NPS USE ONLY

RECEIVED JAN 29 1980

DATE ENTERED OCT 3

**NATIONAL REGISTER OF HISTORIC PLACES
INVENTORY -- NOMINATION FORM**

CONTINUATION SHEET Description ITEM NUMBER 7 PAGE 46

520. B. M. Sullivan House (225 E. Edwards): c. 1911, single, detached, two story, rectangular, clapboard, low hipped, plain, boxed cornice, three bays.
521. E. C. Watts House (300 E. Edwards): c. 1905, single, detached, one and a half stories, square, stucco, high gable with projecting gable, plain, boxed cornice, four bays.
522. T. J. Fleming House (301 E. Edwards): c. 1900, single, detached, one story, square, composition board, medium gable, plain, boxed cornice, two bays.
523. J. A. Gray House (305 E. Edwards): c. 1900, single, detached, one story, rectangular, aluminum siding, medium gable, projecting eaves with exposed rafters, three bays.
524. S. A. Van Sickle House (310 E. Edwards): c. 1905, single, detached, one story, square, stucco, medium hipped, projecting eaves with exposed rafters, three bays.
525. J. B. Miller House (311 E. Edwards): c. 1900, single, detached, one story, rectangular, shake, medium gable, projecting eaves with exposed rafters, three bays.
526. Maxon House (313 E. Edwards): c. 1905, single, detached, two story, rectangular, clapboard, medium gable, plain, boxed cornice, three bays.
527. H. M. Woods House (314 E. Edwards): c. 1903, single, detached, one story, rectangular, shake, low gable, projecting eaves with exposed rafters, three bays.
528. J. E. Knight House (317 E. Edwards): c. 1900, single, detached, one and a half stories, rectangular, brick, bellcast hipped with projecting gables, plain, boxed cornice, two bays.
529. A. M. Conover House (318 E. Edwards): c. 1905, single, detached, one story, square with rear shed addition, clapboard, high hipped, plain, boxed cornice, three bays.
530. A. T. Gilkison House (321 E. Edwards): c. 1905, single, detached, one and a half stories, rectangular, brick, bellcast hipped with projecting triangular dormers, plain, boxed cornice, three bays.
531. A. W. Harrington House (322 E. Edwards): c. 1905, single, detached, one story, square, brick, medium gable, plain, boxed cornice, three bays.

UNITED STATES DEPARTMENT OF THE INTERIOR
NATIONAL PARK SERVICE

FOR NPS USE ONLY

RECEIVED JAN 29 1980

DATE ENTERED

OCT 3

**NATIONAL REGISTER OF HISTORIC PLACES
INVENTORY -- NOMINATION FORM**

CONTINUATION SHEET Description ITEM NUMBER 7 PAGE 47

532. James Hutton House (326 E. Edwards): c. 1903, single, detached, one story, square, clapboard, truncated hip with triangular dormer, plain, boxed cornice, three bays.
533. D. Chamberlin House (332 E. Edwards): c. 1921, single, detached, one and a half stories, rectangular, clapboard, medium gable, projecting eaves with exposed rafters, three bays.
534. L. M. Haines House (335 E. Edwards): c. 1925, single, detached, one and a half stories, rectangular, clapboard, hipped gable, plain, boxed cornice, three bays.
535. Pickelner House (336 E. Edwards): c. 1900, single, detached, one and a half stories, rectangular, clapboard, medium gable with returns, plain, boxed cornice, three bays.
536. John McNabb House (337 E. Edwards): c. 1900, single, detached, one story, rectangular, stucco, medium gable, projecting eaves with exposed rafters, three bays.
537. J. R. Phelps House (208 E. Pitkin): c. 1925, single, detached, one story, rectangular, medium gable, projecting eaves with exposed rafters, three bays.
538. L. Hale House (300 E. Pitkin): 1904, J. L. Rowe-builder, single, detached, one story, rectangular, composition board, high hipped, projecting eaves, three bays.
539. Thomas Bryant House (304 E. Pitkin): c. 1900, single, detached, one story, rectangular, clapboard, medium hipped, with triangular dormers, plain, boxed cornice, three bays.
540. Vannorsdel House (308 E. Pitkin): c. 1903, single, detached, one and a half stories, L-shaped, aluminum siding, medium gable, projecting eaves, three bays.
541. Foss-Grayson House (312 E. Pitkin): c. 1920, single, detached, one and a half stories, L-shaped, medium gable, plain, boxed cornice, five bays.
542. H. W. Kuemmerlin House (312½ E. Pitkin): c. 1920, single, detached, one story, rectangular, clapboard, medium gable, projecting eaves with exposed rafters, three bays.
543. E. R. Price House (318 E. Pitkin): c. 1925, single, detached, two story, rectangular, stucco, truncated hipped with shed dormer, projecting eaves with exposed rafters, three bays.

UNITED STATES DEPARTMENT OF THE INTERIOR
NATIONAL PARK SERVICE

FOR NPS USE ONLY

RECEIVED JAN 29 1980

DATE ENTERED OCT 3 1979

**NATIONAL REGISTER OF HISTORIC PLACES
INVENTORY -- NOMINATION FORM**

CONTINUATION SHEET Description ITEM NUMBER 7 PAGE 48

544. C. M. Rehnblum House (322 E. Pitkin): c. 1911, single, detached, one and a half stories, rectangular, clapboard, bellcast hipped with triangular dormers, plain, boxed cornice, three bays.
545. L. Berg House (338 E. Pitkin): c. 1905, single, detached, one story, irregular plan, clapboard, irregular roofline, projecting eaves with exposed rafters, four bays.
546. Carnegie Library (Pioneer Museum) (200 Mathews): 1903, Albert Bryan-architect, single, detached, one and a half stories, rectangular, sandstone.
547. Janis Cabin (200 Mathews): c. 1859, single, detached, one story, log cabin, moved into park some time ago to prevent destruction.
548. Auntie Stone Cabin (200 Mathews): c. 1859, single, detached, one story log cabin, moved into park some time ago to prevent destruction.
549. Ranch School House (200 Mathews): c. 1884, single, detached, one story structure moved into park some time ago to prevent destruction.

Modern Compatible Structures:

- | | |
|--------------------|----------------------|
| 550. 1107 Mathews | 561. 820 Whedbee |
| 551. 1202 Mathews | 562. 824 Whedbee |
| 552. 1209 Mathews | 563. 825 Whedbee |
| 553. 119 Peterson | 564. 411 E. Olive |
| 554. 401 Peterson | 565. 412 E. Olive |
| 555. 405 Peterson | 566. 419 E. Olive |
| 556. 725 Peterson | 567. 416 E. Magnolia |
| 557. 1102 Peterson | 568. 420 E. Magnolia |
| 558. 524 Whedbee | 569. 220 E. Myrtle |
| 559. 613 Whedbee | 570. 322 E. Myrtle |
| 560. 812 Whedbee | 571. 416 E. Myrtle |

UNITED STATES DEPARTMENT OF THE INTERIOR
NATIONAL PARK SERVICE

FOR NPS USE ONLY

RECEIVED JAN 29 1980

DATE ENTERED OCT 3 1990

**NATIONAL REGISTER OF HISTORIC PLACES
INVENTORY -- NOMINATION FORM**

CONTINUATION SHEET	Description	ITEM NUMBER	7	PAGE	49
572.	310 E. Plum	594.	320 E. Elizabeth		
573.	215 E. Locust	595.	326 E. Elizabeth		
574.	309 E. Locust	596.	330 E. Elizabeth		
575.	312 E. Locust	597.	331 E. Elizabeth		
576.	313 E. Locust	598.	334 E. Elizabeth		
577.	316 E. Locust	599.	335 E. Elizabeth		
578.	317 E. Locust	600.	336 E. Elizabeth		
579.	320 E. Locust	601.	411 E. Elizabeth		
580.	321 E. Locust	602.	419 E. Elizabeth		
581.	325 E. Locust	603.	427-429 E. Elizabeth		
582.	329 E. Locust	604.	502 E. Elizabeth		
583.	331 E. Locust	605.	120 E. Garfield		
584.	335 E. Locust	606.	204 E. Garfield		
585.	416 E. Locust	607.	215 E. Garfield		
586.	417 E. Locust	608.	301 E. Garfield		
587.	501 E. Locust	609.	302 E. Garfield		
588.	502 E. Locust	610.	309 E. Garfield		
589.	201 E. Elizabeth	611.	319 E. Garfield		
590.	223 E. Elizabeth	612.	223 E. Garfield		
591.	306 E. Elizabeth	613.	402 E. Garfield		
592.	312 E. Elizabeth	614.	425 E. Garfield		
593.	316 E. Elizabeth	615.	329 E. Edwards		

UNITED STATES DEPARTMENT OF THE INTERIOR
NATIONAL PARK SERVICE

FOR NPS USE ONLY

RECEIVED JAN 29 1980

DATE ENTERED OCT 3 1980

**NATIONAL REGISTER OF HISTORIC PLACES
INVENTORY -- NOMINATION FORM**

CONTINUATION SHEET	Description	ITEM NUMBER	7	PAGE	50
616.	200 E. Pitkin	637.	650 Mathews		
617.	214 E. Pitkin	638.	220 Peterson		
618.	220 E. Pitkin	639.	301 Peterson		
619.	326 E. Pitkin	640.	617-621 Peterson		
620.	330 E. Pitkin	641.	624 Peterson		
621.	332 E. Pitkin	642.	900 Peterson		
	<u>Intrusions</u>	643.	1123-1125 Peterson		
622.	914 S. College	644.	621-23 Peterson		
623.	426-430 Remington	645.	806 Whedbee		
624.	500 Remington	646.	1001 Whedbee		
625.	518 Remington	647.	400 E. Olive		
626.	600 Remington	648.	327-331 E. Magnolia		
627.	611 Remington	649.	211 E. Mulberry		
628.	705 Remington	650.	220 E. Mulberry		
629.	715 Remington	651.	406 E. Mulberry		
630.	1104 Remington	652.	412 E. Mulberry		
631.	414-416 Mathews	653.	125 E. Myrtle		
632.	500 Mathews	654.	200 E. Myrtle		
633.	516 Mathews	655.	305-307 E. Myrtle		
634.	614 Mathews	656.	309-311 E. Myrtle		
635.	620 Mathews	657.	200 E. Laurel		
636.	634 Mathews	658.	220 E. Laurel		

UNITED STATES DEPARTMENT OF THE INTERIOR
NATIONAL PARK SERVICE

FOR NPS USE ONLY

RECEIVED JAN 29 1980

OCT 3 1980

DATE ENTERED

**NATIONAL REGISTER OF HISTORIC PLACES
INVENTORY -- NOMINATION FORM**

CONTINUATION SHEET Description ITEM NUMBER 7 PAGE 51

- 659. 111-117 Plum
- 660. 305 E. Elizabeth
- 661. 202 E. Edwards
- 662. 320 E. Edwards
- 663. 323-325 Edwards
- 664. 505 Mathews
- 665. 320 Mathews

8 SIGNIFICANCE

PERIOD	AREAS OF SIGNIFICANCE -- CHECK AND JUSTIFY BELOW			
<input type="checkbox"/> PREHISTORIC	<input type="checkbox"/> ARCHEOLOGY-PREHISTORIC	<input checked="" type="checkbox"/> COMMUNITY PLANNING	<input type="checkbox"/> LANDSCAPE ARCHITECTURE	<input type="checkbox"/> RELIGION
<input type="checkbox"/> 1400-1499	<input type="checkbox"/> ARCHEOLOGY-HISTORIC	<input type="checkbox"/> CONSERVATION	<input type="checkbox"/> LAW	<input type="checkbox"/> SCIENCE
<input type="checkbox"/> 1500-1599	<input type="checkbox"/> AGRICULTURE	<input type="checkbox"/> ECONOMICS	<input type="checkbox"/> LITERATURE	<input type="checkbox"/> SCULPTURE
<input type="checkbox"/> 1600-1699	<input checked="" type="checkbox"/> ARCHITECTURE	<input type="checkbox"/> EDUCATION	<input type="checkbox"/> MILITARY	<input type="checkbox"/> SOCIAL/HUMANITARIAN
<input type="checkbox"/> 1700-1799	<input type="checkbox"/> ART	<input type="checkbox"/> ENGINEERING	<input type="checkbox"/> MUSIC	<input type="checkbox"/> THEATER
<input checked="" type="checkbox"/> 1800-1899	<input type="checkbox"/> COMMERCE	<input type="checkbox"/> EXPLORATION/SETTLEMENT	<input type="checkbox"/> PHILOSOPHY	<input type="checkbox"/> TRANSPORTATION
<input checked="" type="checkbox"/> 1900-	<input type="checkbox"/> COMMUNICATIONS	<input type="checkbox"/> INDUSTRY	<input type="checkbox"/> POLITICS/GOVERNMENT	<input type="checkbox"/> OTHER (SPECIFY)
		<input type="checkbox"/> INVENTION		

SPECIFIC DATES

BUILDER/ARCHITECT

STATEMENT OF SIGNIFICANCE

The Midtown Historic District is significant as an example of early community planning and development and for its role in the social evolution of Fort Collins. The District is also significant for its architectural features which show many small Victorian cottages as well as some very fine period homes built primarily along Remington Street for prominent citizens. All these, together with the old trees and foliage, reflect the ambiance of a late nineteenth/early twentieth century agricultural community.

Although there had been a military post, Camp Collins, established in the 1860s, the City of Fort Collins owed its existence to the movement to develop agricultural colonies on the high plains. In the early 1870s Horace Greeley, editor of the New York Tribune, had been instrumental in forming the Union Colony, which founded what is today the City of Greeley, Colorado. This experiment had hardly begun, however, when the leaders decided to establish a second agricultural colony which would be located some distance to the west on four square miles of land previously reserved for military use. This decision led to the organization of the Agricultural Colony at Fort Collins. The original streets laid out near the Camp in 1867 ran parallel to the Cache la Poudre River, but Franklin C. Avery, who platted the streets for the new colony drew his on a north/south and east/west axis. This eventually accounted for the so-called triangle area that formed the commercial center of the community (an area now listed in the Register), while much of the residential neighborhoods followed the north/south and east/west grid pattern.

The homes in the Midtown Historic District were built as the residential development moved south from the downtown area. The oldest known structure, the Coy House at 401 Mathews (c. 1876) is located in the northern section. Maps of the 1880s show that construction had progressed in this area although there was no systematic pattern of habitation. The houses were spread throughout the area though most were clustered on the northern edge. Some blocks had four to five dwellings on each side, but other blocks were used for farming. The 1880s, however, saw Remington Street emerge as a showcase for local architects who built homes there for the town's elite. The 1890s saw considerable building, but it remained in the northern two-thirds of the District. By the end of the decade some blocks were fully developed, and some of the larger lots in others were being subdivided.

The twentieth century witnessed a continuation of this pattern. The first decade saw expansion along the southern edge and a renewed interest in subdividing the larger lots of the more settled area. After 1910 this activity slowed because of a local depression and probably the effects of World War I. Fewer than thirty structures

9 MAJOR BIBLIOGRAPHICAL REFERENCES

See Continuation Sheet.

UTM NOT VERIFIED

10 GEOGRAPHICAL DATA

ACREAGE NOT VERIFIED

ACREAGE OF NOMINATED PROPERTY 217 acres

QUADRANGLE NAME Fort Collins, Colorado

QUADRANGLE SCALE 1:24000

UTM REFERENCES

A 1 3 4 9 4 1 7 0 4 4 9 2 6 7 5

B 1 3 4 9 4 1 6 0 4 4 9 0 6 7 0

ZONE EASTING NORTHING

ZONE EASTING NORTHING

C 1 3 4 9 3 6 1 0 4 4 9 0 6 8 0

D 1 3 4 9 3 6 1 0 4 4 9 2 6 8 0

E

F

G

H

VERBAL BOUNDARY DESCRIPTION

See the discussion in Item #7, paragraph 2, and the maps that accompany this nomination.

LIST ALL STATES AND COUNTIES FOR PROPERTIES OVERLAPPING STATE OR COUNTY BOUNDARIES

STATE	CODE	COUNTY	CODE
-------	------	--------	------

STATE	CODE	COUNTY	CODE
-------	------	--------	------

11 FORM PREPARED BY

NAME / TITLE

James S. Kane

ORGANIZATION

DATE

June 28, 1979

STREET & NUMBER

TELEPHONE

109 N. Washington

CITY OR TOWN

STATE

Fort Collins

Colorado

12 STATE HISTORIC PRESERVATION OFFICER CERTIFICATION

THE EVALUATED SIGNIFICANCE OF THIS PROPERTY WITHIN THE STATE IS:

NATIONAL

STATE

LOCAL ✓

As the designated State Historic Preservation Officer for the National Historic Preservation Act of 1966 (Public Law 89-665), I hereby nominate this property for inclusion in the National Register and certify that it has been evaluated according to the criteria and procedures set forth by the National Park Service.

STATE HISTORIC PRESERVATION OFFICER SIGNATURE

William C. Townsend

Jan. 16, 1980

TITLE

State Historic Preservation Officer

DATE

FOR NPS USE ONLY

I HEREBY CERTIFY THAT THIS PROPERTY IS INCLUDED IN THE NATIONAL REGISTER

ATTEST:

Bryan Lynn Dwyer
KEEPER OF THE NATIONAL REGISTER

DATE

10/3/80

Linda Stork
CHIEF OF REGISTRATION

DATE

9/23/80

UNITED STATES DEPARTMENT OF THE INTERIOR
NATIONAL PARK SERVICE

FOR NPS USE ONLY

RECEIVED JAN 29 1980

DATE ENTERED OCT 3 1980

**NATIONAL REGISTER OF HISTORIC PLACES
INVENTORY -- NOMINATION FORM**

CONTINUATION SHEET Significance ITEM NUMBER 8 PAGE 2

rose in the District during this time, but the 1920s and 1930s witnessed an expanded development along the southern edge and the construction of a number of bungalow style homes. By the 1930s the area comprising the District was fully developed as a residential area and has remained such till the present day.

From an architectural perspective the District reflects the styles of the times. The most prevalent building type is the small Victorian cottage with few if any decorative elements. Yet on several blocks along Remington Street are a number of far more substantial homes that manifest the stylistic characteristics of the era: Italianate, Romanesque, Queen Anne, Eastlake, and others. Some of these were designed by Montezuma Fuller, the most important of the early architects in Fort Collins, a number of whose buildings are now listed in the Register. And finally, there are a number of bungalow style structures which fit in well and depict the change in architectural styles over this long period of construction.

UNITED STATES DEPARTMENT OF THE INTERIOR
NATIONAL PARK SERVICE

FOR NPS USE ONLY

RECEIVED

JAN 29 1980

OCT

3 1980

DATE ENTERED

**NATIONAL REGISTER OF HISTORIC PLACES
INVENTORY -- NOMINATION FORM**

CONTINUATION SHEET Major Bibliographical
References ITEM NUMBER 9 PAGE 1

Clark, Jessie L.: "Pioneer Hotels of Larimer County." Colorado Magazine, 31
(April 1954): 128-136.

Fort Collins City Directory. Various Publishers and dates: 1901-1957.

Fort Collins Coloradoan

Fort Collins Courier

(Fort Collins) Daily Express

Fort Collins Express

Fort Collins Standard

(Fort Collins) Weekly Courier

(Fort Collins) Weekly Express

Sundberg, Wayne. Historic Fort Collins. Fort Collins, Colorado: Old Army Press,
1957.

Swanson, Evadene Burris: Fort Collins Yesterdays. Fort Collins, Colorado:
Evadene Burris Swanson, 1975.

Triangle Review

Watrous, Ansel, History of Larimer County. Fort Collins, Colorado: Courier
Printing and Publishing Co., 1911.

Property Laurel School Historic District

State Co. Larimer

Working Number 1-29-80356

TECHNICAL

Photos 12
Maps 1

CONTROL

HISTORIAN

Sketch map? - case

- Return

ARCHITECTURAL HISTORIAN

*Graham
3/13/80*

*MO VBD, properties & photos
should be tried to sketch map. 4.22.80*

ARCHEOLOGIST

*There is still no VBD. The form refers to HZ #7 which can suffice
for the east and west boundaries, but the irregular North and South
boundaries are still unclear in the text.*

OTHER

*Otherwise the district seems eligible as a rather consistent grouping of
late 19th and early 20th century frame and brick houses, vernacular in character.
Important as a planned agricultural community encouraged by Horace
Greely.*

HAER

P. Reed 9/22/80

Inventory

Review

VBD - Drawn to scale on site map.

REVIEW UNIT CHIEF

Acpt P. Reed 9/23/80

BRANCH CHIEF

KEEPER

National Register Write-up 2.3.81
Federal Register Entry 2.3.81

Send-back
Re-submit

Entered OCT 3 1980

The attached National Register Inventory-Nomination form is being returned to your office for clarification of the information indicated below. PLEASE RETURN THIS FORM WHEN THE NOMINATION IS RESUBMITTED.

7

Description: _____

3

Statement of Significance: _____

9

Bibliography: _____

10

Geographical Data -- Acreage: _____

UTM Reference(s): _____

Verbal Boundary Description: _____

12

Certification: _____

Photographic Coverage: _____

Map Coverage: - Sketch map as discussed with B. Handy is needed. - WAB

Other: Too many owner notification letters were returned by Postal Service on the basis of the list provided. Copies of letters returned are enclosed. A corrected list needs to be provided. We will hold nomination.

Questions concerning this nomination may be directed to D. Byers

on the National Register staff, telephone 202-343-7461

Thank you for your attention to the above items.

W. Ray Luce
Chief, Branch of Registration

Date: 5/30/80



Bethlehem Lutheran Church (structure #265)

300 Whedbee

Laurel School Historic District, Fort

Collins, Colorado

Photographer: James Kane

Date of Photograph: 1979

Negatives in possession of Colorado State

Historic Preservation Office

Farmer Co

1/12

OCT 3 1980

JAN 29 1980



Coy House (structure #401

401 Mathews

Laurel School Historic District: Fort Collins
Colorado

Photographer: James Kane

Trimmer Co.

Date of Photograph: 1979

Negatives in possession of Colorado State

Historic Preservation Office

View: East (main) facade

2/12

Photographer looking southwest

OCT 3 1980

JAN 29 1980



North Boundary

Laurel School Historic District

Fort Collins, Colorado

Photographer: James Kane

Harmer Co

Date of Photograph: 1979

Negatives in possession of Colorado State

Historic Preservation Office

Photographer looking northerly

This view, looking north past the district
boundary shows the typical mixture of old
and new that serves as the boundary and

transition area from the area of historic
integrity to the area of almost exclusively
new structures.

OCT 3 1980

3/12

JAN 29 1980



Old Hospital Building (structure #370)

301 E. Magnolia

Kortz House (structure #372) 305 E. Magnolia

Laurel School Historic District

Fort Collins, Colorado

Photographer: James Kane

Turner Co.

Date of Photograph: 1979

Negatives in possession of Colorado State

Historic Preservation Office

View: North (main) facades

Photographer looking southwest

This small streetscape is typical of the

east/west streets in the district.

OCT 3 1980

4/12

JAN 29 1980



Fothergill House (structure #396)

312 E. Mulberry (right)

Baker House (structure #393) 304 E.

Mulberry (left)

Laurel School Historic District

Fort Collins, Colorado

Photographer: James Kane

Lumen Co

Date of Photograph: 1979

Negatives in possession of Colorado State

Historic Preservation Office

View: South (main) facades

Photographer looking northwesterly

This small streetscape is typical of the
northern sections of the district.

OCT 3 1980

5/12

JAN 29 1980



Steudler House (structure #102)

527 Mathews

Laurel School Historic District

Fort Collins, Colorado

Photographer: James Kane

Date of Photograph: 1979

Negatives in possession of Colorado State

Historic Preservation Office

View: East (main) facade

Photographer looking west

Farmer co

9/2

OCT 3 1980

JAN 29 1980



E. D. Ball House (structure #103)

Laurel School Historic District

Fort Collins, Colorado

Photographer: James Kane

Harmer Co.

Date of Photograph: 1979

Negatives in possession of Preservation
Office

View: North and West facades

2/2

Photographer looking easterly

OCT

3 1980

JAN 29 1980



Laurel School *Historic District*
Corner Laurel and Peterson Streets
Fort Collins, Colorado

Photographer: James Kane

Laurel Co.

Date of Photograph: 1979

Negatives in possession of Colorado State
Historic Preservation Office

View: South (main facade)

Photographer looking westerly

8/12

OCT 3 1980

JAN 29 1980



Streetscape (Whedbee Street)

(Laurel School Historic District) JAN 29 1980

Fort Collins, Colorado

Photographer: James Kane *Farmer Co.*

Date of Photograph: 1979

Negatives in possession of Colorado State

Historic Preservation Office

View: East side of street

OCT 3 1980

Photographer looking northerly

The east boundary of the district is the
alleyway that lies to the east of these
houses.

9/12



Laurel School Hist. Dist.
Remington Streetscape (west side)

Laurel School Historic District

Fort Collins, Colorado

Photographer: James Kane

Date of Photograph: 1979

JAN 29 1980

Laurel CO.

Negatives in possession of Colorado State

Historic Preservation Office

View: East facades

OCT 3 1980

Photographer looking southwesterly

The west boundary of the district is the $1\frac{1}{2}$
alleyway behind (west) of these structures.



Laurel School Hist. Dist.

Streetscape: East Laurel and Mathews

Laurel School Historic District

Fort Collins, Colorado

Tanner Co.

OCT

3 1980

Photographer: James Kane

Date of Photograph: 1979

Negatives in possession of Colorado State

Historic Preservation Office

View: Houses on west side of Mathews

Photographer looking southerly

JAN 29 1980

1/12



Laurel School Hist Dist -
Streetscape (Peterson Street showing Laurel
School in background)

Laurel School Historic District
Fort Collins, Colorado

Harmer Co.

OCT 3 1980

Photographer: James Kane

Date of Photograph: 1979

Negatives in possession of Colorado State
Historic Preservation Office

View: West side of street

Photographer looking southwesterly JAN 29 1980

12/2

UNITED STATES
DEPARTMENT OF THE INTERIOR
GEOLOGICAL SURVEY

FORT COLLINS QUADRANGLE
COLORADO-LARIMER CO.
7.5 MINUTE SERIES (TOPOGRAPHIC)
SE/4 FORT COLLINS 15 QUADRANGLE

Midtown Historic District
Fort Collins, Colorado

A-13/494170/4492675
B-13/494160/4490670
C-13/493610/4490680
D-13/493610/4492680

Mapped, edited, and published by the Geological Survey
Control by USGS and USC&GS
Topography by photogrammetric methods from aerial
photographs taken 1958. Field checked 1960
Polyconic projection. 1927 North American datum
10,000 foot grid based on Colorado coordinate system,
north zone
1000 meter Universal Transverse Mercator grid ticks,
zone 13, shown in blue
Red tint indicates areas in which only landmark buildings are shown
Fine red dashed lines indicate selected fence and field lines where
generally visible on aerial photographs. This information is unchecked
Revisions shown in purple compiled from aerial photographs
taken 1969. This information not field checked
Purple tint indicates extension of urban areas

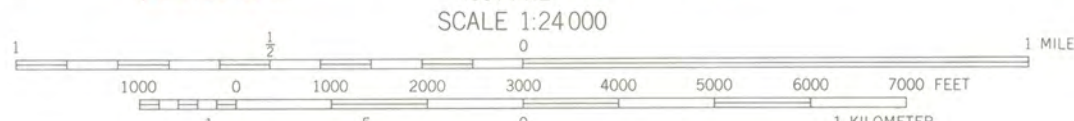

CONTOUR INTERVAL 10 FEET
DOTTED LINES REPRESENT 5 FOOT CONTOURS
DATUM IS MEAN SEA LEVEL

THIS MAP COMPLIES WITH NATIONAL MAP ACCURACY STANDARDS
FOR SALE BY U.S. GEOLOGICAL SURVEY, DENVER, COLORADO 80225, OR WASHINGTON, D.C. 20242
A FOLDER DESCRIBING TOPOGRAPHIC MAPS AND SYMBOLS IS AVAILABLE ON REQUEST

ROAD CLASSIFICATION
Heavy-duty ——— Light-duty ———
Medium-duty ——— Unimproved dirt ———
Interstate Route U.S. Route State Route

FORT COLLINS, COLO.
SE/4 FORT COLLINS 15 QUADRANGLE
N4030-W10500/7.5

1960
PHOTOREVISED 1969
AMS 4965 II SE-SERIES V877



MULBERRY ST

8
10
12
14
16
17

~~624~~ ~~549~~ 392 96
9 97
11 99
625 101
13 102
15 408 ~~549~~

~~622~~ 391 393 398 400 402
razed
193
196
197
409 410 411 412 413 ~~414~~ 415 417 198

188 405 406 292
189 293
190 295
191 297
192 299
194 300
195 302
199 ~~401~~

407
294
296
298
301
~~302~~
303

MYRTLE ST

~~653~~
19
~~651~~
22
24
26
29
31
33
34
36

~~652~~ ~~654~~ 104
18 105
20 106
21 107
23 109
25 109
27 110
28 111
30 112
32 113
35 114
115
116
~~657~~ ~~658~~

103 ~~655~~ ~~656~~ 414 416 201
razed 203
205
206
651
635 635
630
210
212
215
217
636
637
100
422

200 418 305
202 306
204 308
207 ~~309~~
208 312
209 ~~313~~
~~314~~
211 316
212 318
214 320
216 322
218 324
219 426 326

304
307
309
310
311
313
315
317
319
321
323
325

LAUREL ST

38
~~39~~
42
~~43~~
44
45
47

37 117
39 119
40 121
41 122
43 124
46 126
433 129
130

118 419 420 421 220
120 222
123 223
125 225
127 227
129 229
131 ~~422~~ 443 445 447 448 450 230

423 424 425 427 428 429 430 431
221
224
226
228
451 453 455 457 459 460
329

432
327
349
330
331
461

PLUM

~~659~~
48
50
51
53
57
58

431 433 436 437 438
49
52
54 134
55 136
56 138
59 140
142

439 440 441 442 444 446 449 231
233
235
237
239
242
244
246
132
133
135
137
139
141
54
55
56
57

232 452 454 456 458 332
234 334
236 335
238 337
240 338
241 339
243 341
245 343
340

333
~~334~~
335
336
~~337~~
338
339
340

LOCUST

REMINGTON ST

MATTHEWS ST

PETERSON ST

WHEEDER ST

CITY OF
FORT COLLINS
COLORADO

SHEET NO
2 OF 3

SCALE 1"=100'
200 100 0 100 200



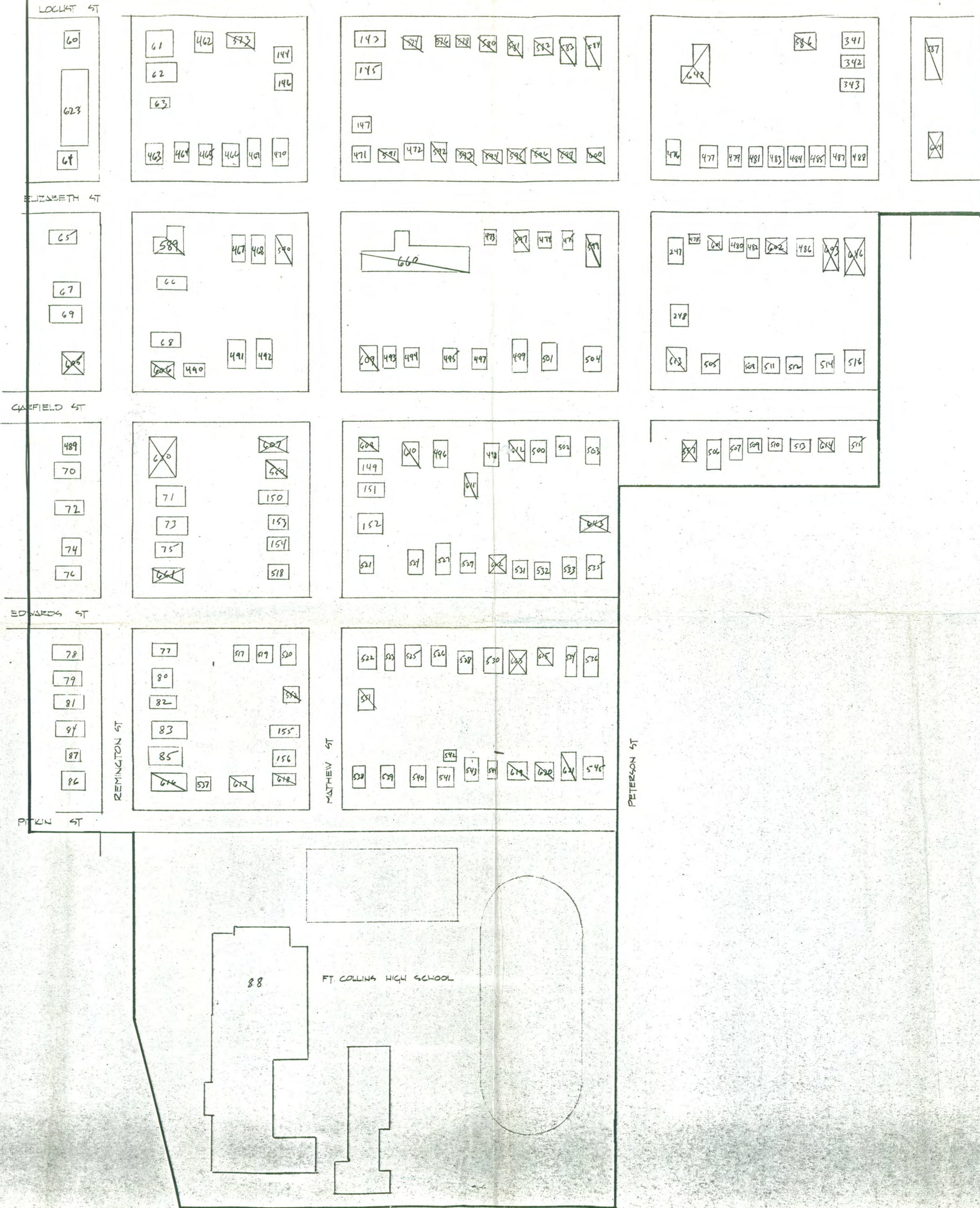

CITY OF
FORT COLLINS
COLORADO

SHEET NO
3 OF 3

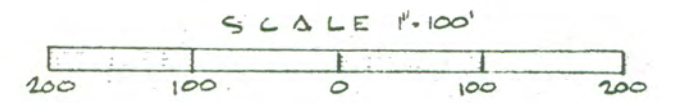

CITY OF
FORT COLLINS
COLORADO

SHEET NO. 1 OF 3

SCALE 1" = 100'

