

COLORADO CULTURAL RESOURCES INVENTORY

Historical and Architectural Reconnaissance

IDENTIFICATION

1. Property Name: UNKNOWN ☐ Historic ☐ Current ☐ Other
2. Resource Classification: ☒ Building ☐ Structure ☐ Object ☐ Sites/Landscape
3. Ownership: ☐ Federal ☐ State ☐ local ☐ non-profit ☒ private
☐ unknown

Official eligibility determination
(OAHP use only)

Date _____ Initials _____

- _____ Determined Eligible- NR
 _____ Determined Eligible- SR
 _____ Needs Data
 _____ Eligible District - Contributing

LOCATION

4. Street Address: 121 N WHITCOMB ST
5. Municipality: FORT COLLINS ☐ Vicinity
6. County: LARIMER
9. Parcel #: 9711305016 Lot: LOT 16 Block: 271 Addition: LOOMIS
12. Location Coordinates:
 Lat/Long: Latitude 40.587973296800001 Longitude -105.08661625800001 ☒ WGS84

DESCRIPTION

13. Construction features (forms, materials):

Stories	Style/Type	Foundation	Walls
1	Late Victorian	Concrete	Synthetic; horizontal siding
Windows	Roof	Chimney	Porch
1-over-1 double hung	Gabled; Composition Roof	North slope; metal	Partial-width projecting porch with shed roof; turned wood posts; knee walls with wood paneling

Optional: additional description (plan/footprint, dimensions, character-defining and decorative elements of exterior and interior; alterations, additions, etc.): Paneled wood door with three lights.

14. Landscape (important features of the immediate environment):

☐ Garden ☒ Mature Plantings ☐ Designed Landscape ☐ Walls ☐ Parking Lot ☒ Driveway ☒ Sidewalk ☐ Fence
☐ Seating ☐ Other:

14a. # of Ancillary buildings _1_ (Form 1417b attached for each ancillary building)

HISTORICAL ASSOCIATIONS *(based on visual observations and/or review of secondary sources):*

15. Historic Function/Use: SINGLE DWELLING Current function/Use (if different):
16. Date of Construction: 1892 ☒ Estimated ☐ Actual Source: Larimer County Assessor Records
17. Other Significant Dates, if any:
18. Associated Areas of Significance:
☐ Agriculture ☒ Architecture ☐ Archaeology ☐ Art ☐ Commerce ☐ Communications ☒ Community Planning & Development
☐ Conservation ☐ Economics ☐ Education ☐ Engineering ☐ Entertainment/Recreation ☐ Ethnic Heritage
☐ Exploration/Settlement ☐ Health/Medicine ☐ Industry ☐ Invention ☐ Landscape Architecture ☐ Law ☐ Literature
☐ Maritime History ☐ Military ☐ Performing Arts ☐ Philosophy ☐ Politics/Gov't ☐ Religion ☐ Science ☐ Social History
☐ Transportation ☐ Other
19. Associated Historic Context(s), if known: LOOMIS ADDITION HISTORIC CONTEXT (2015)
20. Retains Integrity of: ☒ Location ☒ Setting ☐ Materials ☐ Design ☐ Workmanship ☒ Association ☐ Feeling
21. Notes on integrity: Original horizontal wood siding was replaced sometime between 1948 and 1968. Siding has been replaced again since then to a synthetic horizontal siding. 1948 tax assessor's photo shows porch was enclosed. Porch roof had a pediment above entry that has been removed. Brick chimney once stood at ridge of roof. For these reasons, the property does not retain integrity of materials, design, workmanship or feeling.
22. Sources: Loomis Addition Historic Context (2015); Fort Collins History Connection Website, <http://history.poudrelibraries.org/>; Larimer County Assessor Records

FIELD ELIGIBILITY RECOMMENDATION:

Note: eligibility recommendation based solely on architectural reconnaissance except as noted above. Full evaluations of historical significance require additional property-specific research beyond the scope of this form and typically require completion of the OAHP Historical / Architectural Properties: Intensive Level / Evaluation form (OAHP form # 1403).

- ☐ Potentially Eligible – National Register
- ☐ Potentially Eligible – State Register
- ☐ Potentially Contributing – National Register District
- ☐ Potentially Individually Eligible – Fort Collins Landmark
- ☒ Potentially Contributing – Fort Collins Landmark District
- ☐ Fort Collins Landmark
- ____ Needs Data

RECORDING INFORMATION

Survey Date: June 14, 2016

Surveyed By: Luke Anderson

Project Sponsor: City of Fort Collins/Historic Preservation Division

Photograph Log: nwhit121.01.la, nwhit121.02.la

SKETCH PLAN based on 2014 GIS data, field checked from public ROW

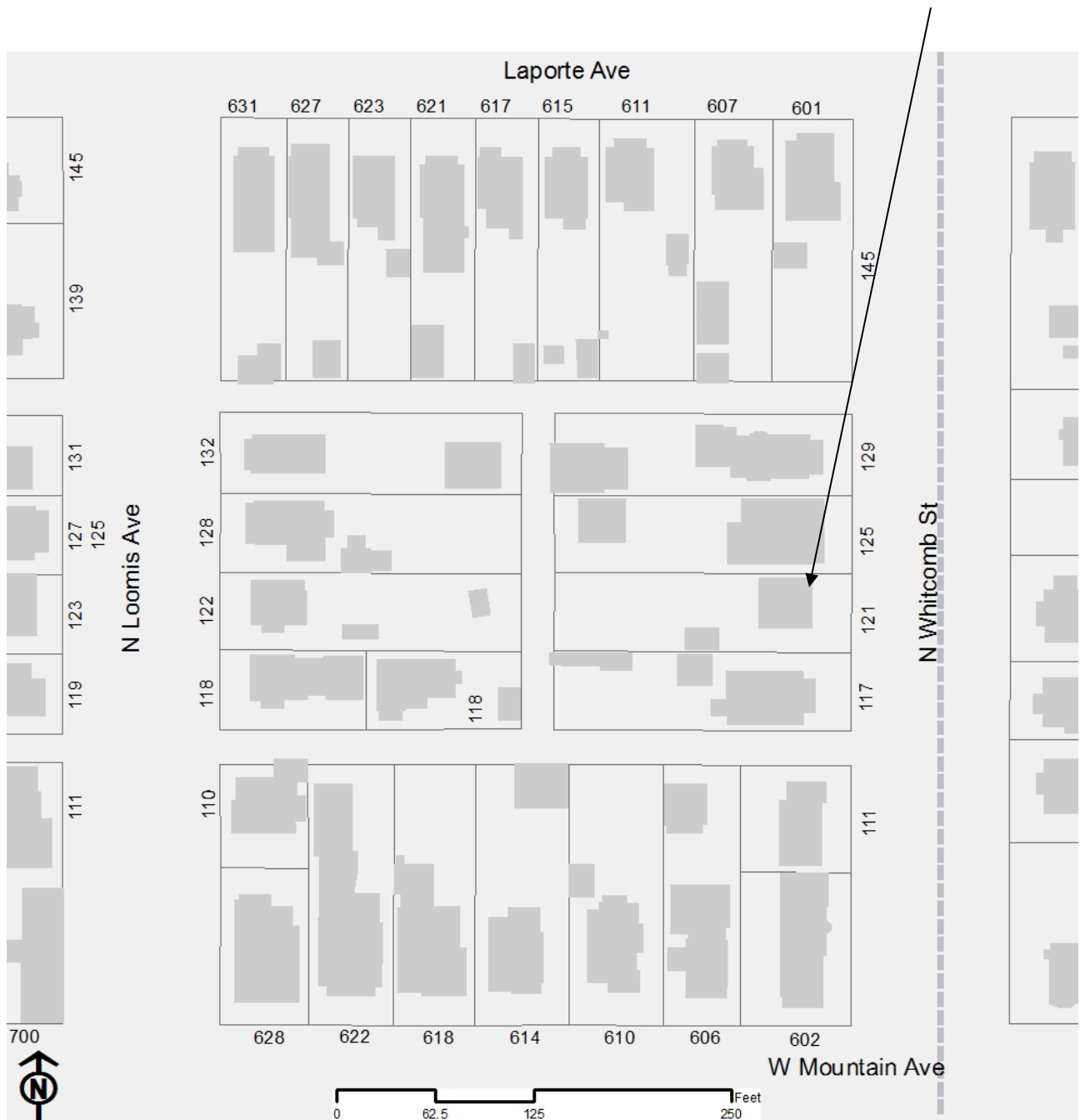

PHOTOGRAPHS



121 N Whitcomb St., south side and east façade (Luke Anderson, June 2016)



121 N Whitcomb St., east façade and north side (Luke Anderson, June 2016)

USGS Fort Collins Quadrangle (NAD83; WGS84)

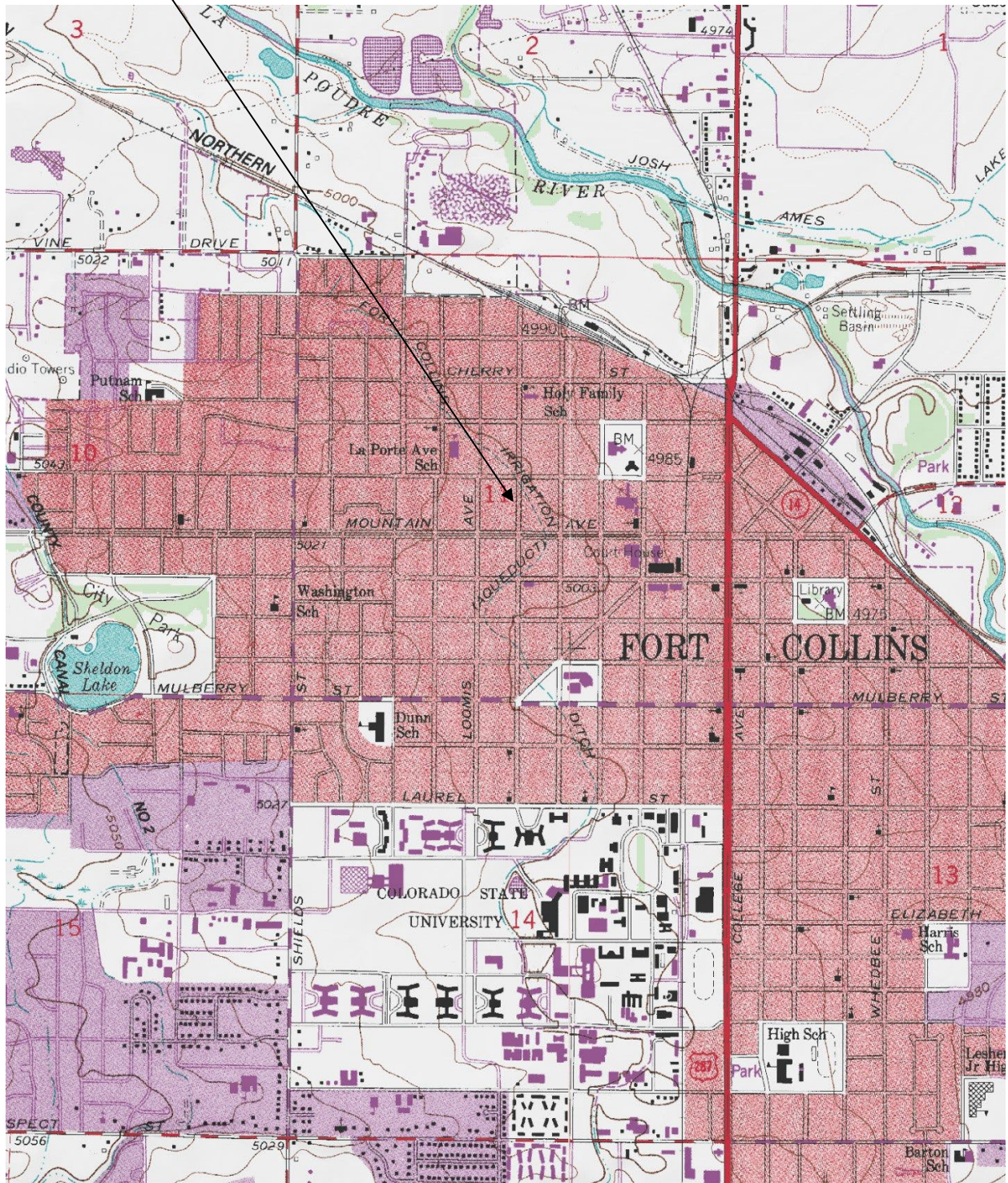

COLORADO CULTURAL RESOURCES INVENTORY

Historical and Architectural Reconnaissance: Ancillary

IDENTIFICATION

1. Property Name: 121 N Whitcomb St. ☐ Historic ☐ Current ☐ Other
2. Resource Classification: X Building ☐ Structure ☐ Object ☐ Sites/Landscape
3. Ancillary Identification: Garage

DESCRIPTION

4. Construction Features (forms, materials):

Stories	Style/Type	Foundation	Walls
1	Garage	Concrete	Wood; plywood siding
Windows	Roof	Chimney	Porch
Not visible	Gabled roof; composition roof	None	None

Optional: additional description (plan/footprint, dimensions, character-defining and decorative elements of exterior and interior; alterations, additions, etc.): Single bay garage; hinged garage doors.

HISTORICAL ASSOCIATIONS *(based on visual observations and/or review of secondary sources):*

5. Historic Function/Use: Garage Current Function/Use (if different):
6. Date of Construction: 1930 X Estimated ☐ Actual (include source):
7. Other Significant Dates, if any:
8. Associated NR Areas of Significance:
☐ Agriculture ☒ Architecture ☐ Archaeology ☐ Art ☐ Commerce ☐ Communications ☐ Community Planning & Dev't
☐ Conservation ☐ Economics ☐ Education ☐ Engineering ☐ Entertainment/Recreation ☐ Ethnic Heritage
☐ Exploration/Settlement ☐ Health/Medicine ☐ Industry ☐ Invention ☐ Landscape Architecture ☐ Law ☐ Literature
☐ Maritime History ☐ Military ☐ Performing Arts ☐ Philosophy ☐ Politics/Gov't ☐ Religion ☐ Science ☐ Social History
☐ Transportation ☐ Other
9. Associated Historic Context(s), if known: LOOMIS ADDITION HISTORIC CONTEXT
10. Retains integrity of: X Location X Setting ☐ Materials ☐ Design ☐ Workmanship X Association ☐ Feeling
11. Notes on integrity: Siding is likely not original.
12. Sources: Loomis Addition Historic Context (2015); Fort Collins History Connection Website, <http://history.poudrelibraries.org/>

Official eligibility determination
(OAHP use only)

Date _____ Initials _____

- _____ Determined Eligible- NR
 _____ Determined Eligible- SR
 _____ Needs Data
 _____ Eligible District - Contributing

FIELD ELIGIBILITY RECOMMENDATION:

Note: eligibility recommendation based solely on architectural reconnaissance except as noted above. Ancillary buildings are not eligible on their own, unless specifically noted.

- ☐ Potentially Eligible – NR
- ☐ Potentially Eligible –SR
- ☐ Potentially Contributing - NR district
- ☐ Potentially Individually Eligible – Fort Collins Landmark
- ☐ Potentially Contributing – Fort Collins Landmark District
- ☐ Fort Collins Landmark
- ☐ Needs Data

RECORDING INFORMATION

Survey Date: June 14, 2016

Surveyed By: Luke Anderson

Project Sponsor: City of Fort Collins/Historic Preservation Division

Photograph Log: nwhit121A.01.la

PHOTOGRAPHS



121 N Whitcomb St, Garage, east side (Luke Anderson, June 2016)