

Fort Collins Building & Zoning Dept.

281 N College Ave , P O Box 580, Fort Collins, CO 80522-0580,
Voice 970 221 6760 FAX 970 224 6134

RESIDENTIAL SUNSHADE HANDOUT - 2003 IRC

REVISED 2/18/05

PERMITS ARE REQUIRED FOR SUNSHADE'S

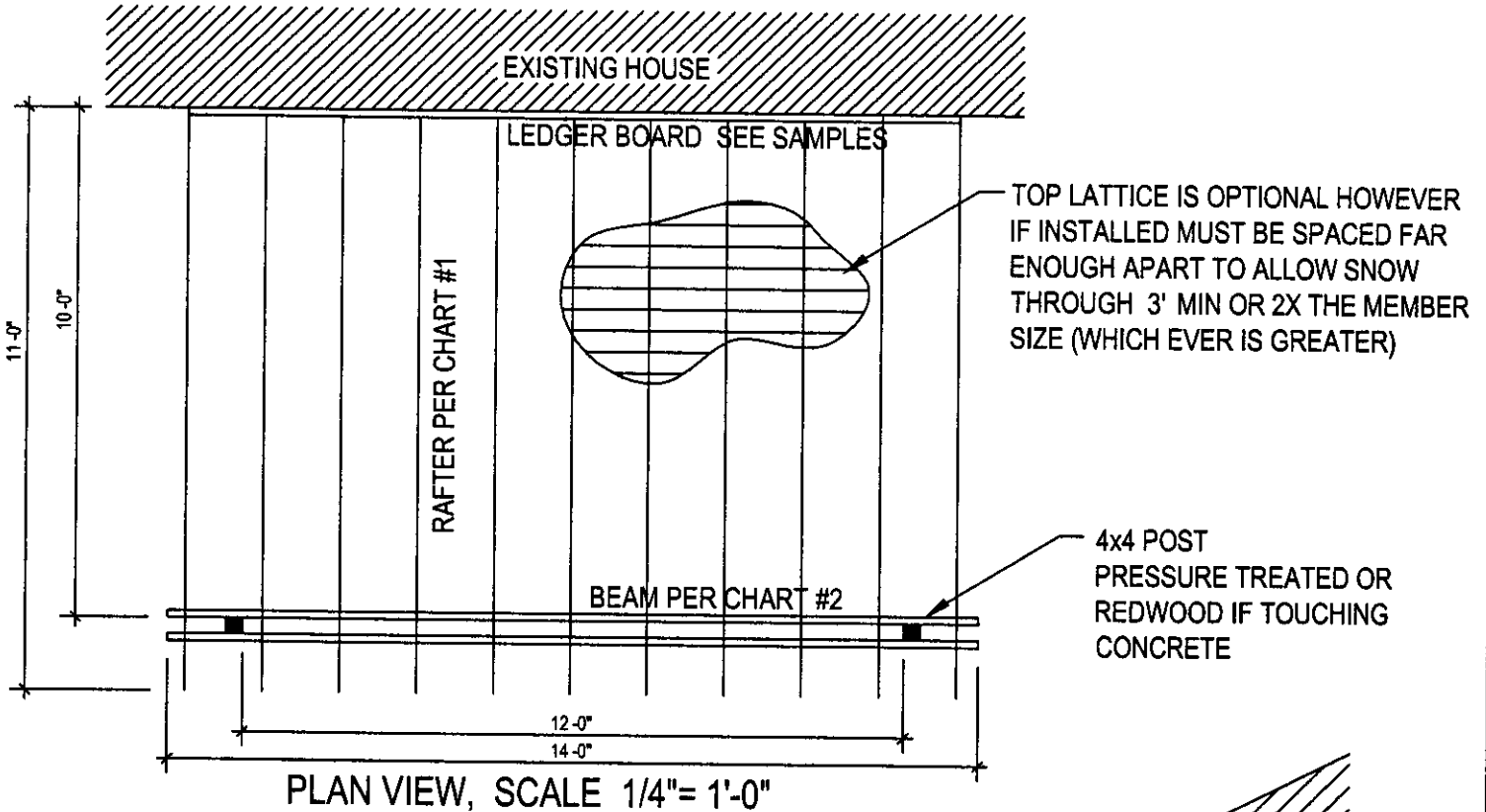

GAP BETWEEN LATTICE= 2X THE MEMBER SIZE OR 3 (WHICH EVER IS GREATER)

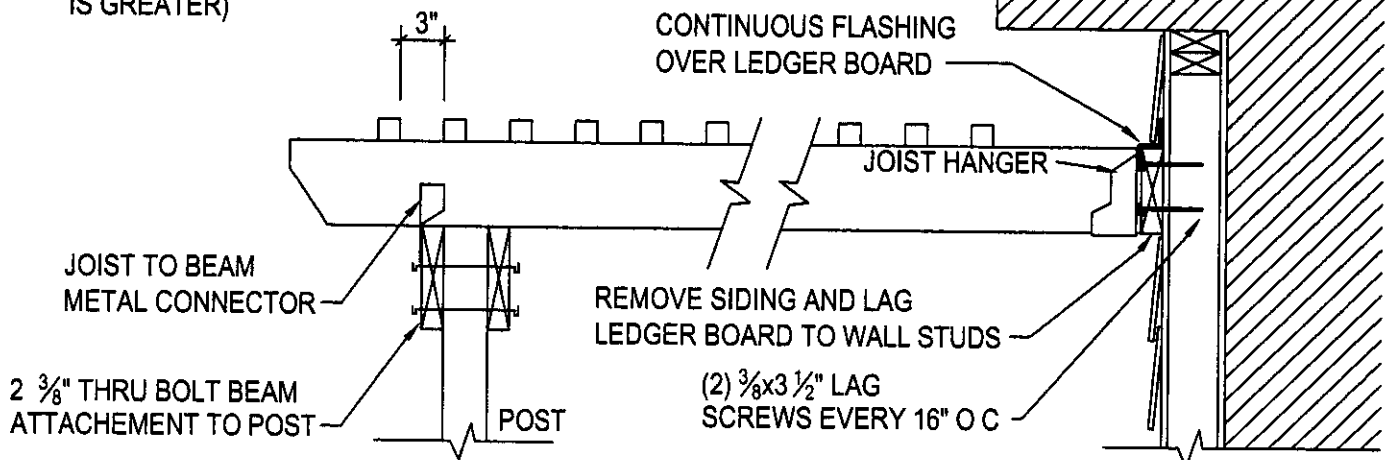

RAFTER TO BEAM & LEDGER BOARD DETAIL

SUNSHADE SPAN CHARTS

Sunshade rafters				
Rafter span in feet		2x4	2x6	2x8
	6'	24"	24"	24"
	7'	24"	24"	24"
	8'	24"	24"	24"
	9'	24"	24"	24"
	10'	16"	24"	24"
	11'	12"	24"	24"
	12'	na	24"	24"
	13'	na	24"	24"
	14'	na	24"	24"
	15'	na	16"	24"
	16'	na	16"	24"
	17'	na	12"	24"
18'	na	12"	24"	

Beam span in feet					
Rafter Span in Feet		6 ft.	8 ft.	10 ft	12 ft
	8'	(2) 2x4's	(2) 2x4's	(2) 2x6's	(2) 2x6's
	9'	(2) 2x4's	(2) 2x4's	(2) 2x6's	(2) 2x6's
	10'	(2) 2x4's	(2) 2x4's	(2) 2x6's	(2) 2x6's
	11'	(2) 2x4's	(2) 2x4's	(2) 2x6's	(2) 2x6's
	12'	(2) 2x4's	(2) 2x4's	(2) 2x6's	(2) 2x8's
	13'	(2) 2x4's	(2) 2x4's	(2) 2x6's	(2) 2x8's
	14'	(2) 2x4's	(2) 2x6's	(2) 2x6's	(2) 2x8's
	15'	(2) 2x4's	(2) 2x6's	(2) 2x6's	(2) 2x8's
	16'	(2) 2x4's	(2) 2x6's	(2) 2x6's	(2) 2x8's
	17'	(2) 2x4's	(2) 2x6's	(2) 2x6's	(2) 2x8's
	18'	(2) 2x4's	(2) 2x6's	(2) 2x8's	(2) 2x8's

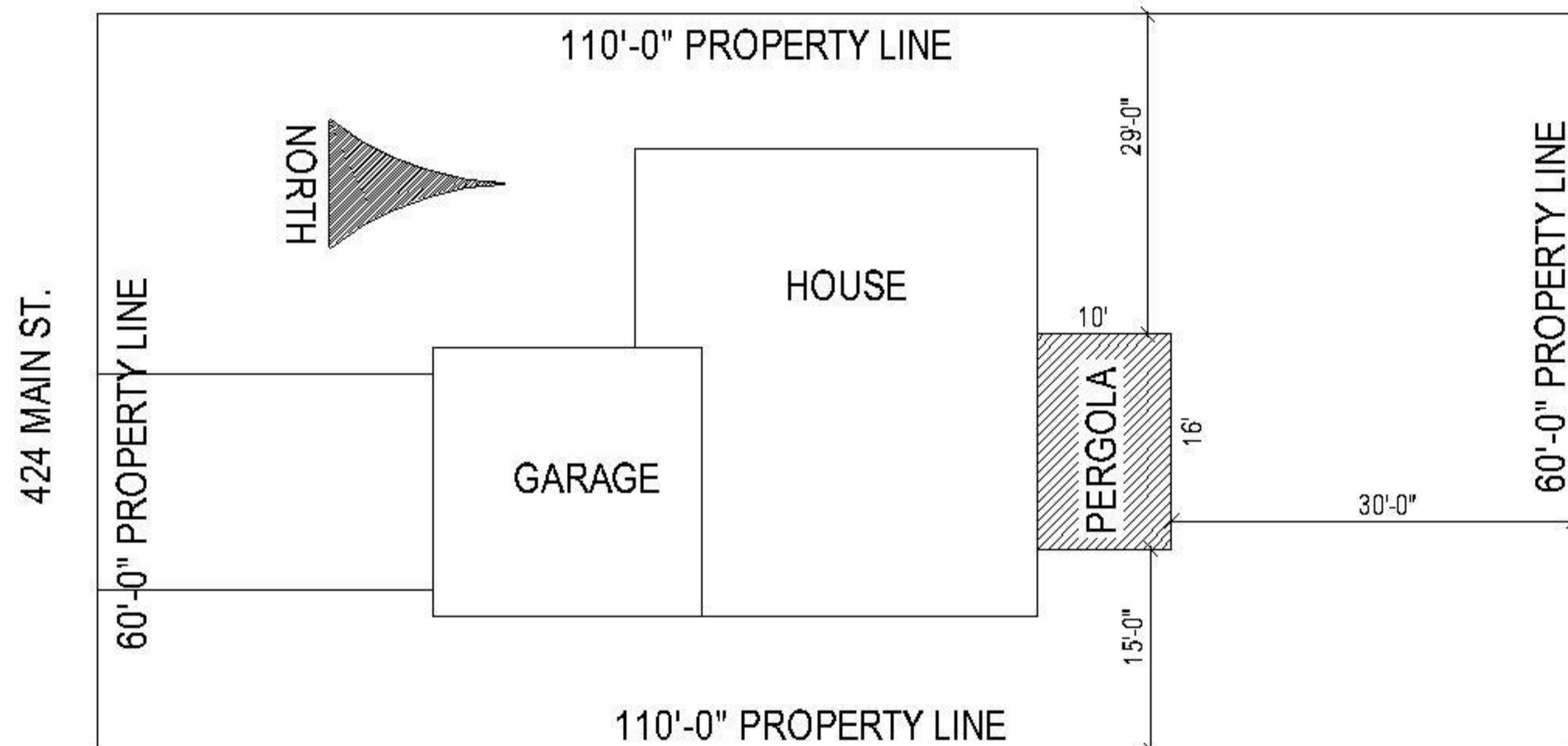

SAMPLE SITE PLAN SCALE 1"=20'

Submittal Requirements for Sunshade

- Two** sets of plans of the proposed sunshade. See the front page as an example of the plans you will need to submit. Engineering is required for buildings projects with structural spans beyond the charts shown, the remainder of the plans do not have to be professionally drawn, nor computer generated, but must be neat, clean and legible.
- Two** sets of site plans, drawn to scale, on paper no bigger than 8 1/2" x 14", see example above.
- Completed two-part application form, available with other Building and Zoning handouts at 281 N. College Ave or on the website www.fcgov.com The legal information requested on the application must be completed in full.
- Completed Homeowner's Affidavit, if applicable (for homeowners doing the construction). The form is available at Building and Zoning, 281 N. College Ave.

Required inspections:

- Final inspection