

ATTEST \_\_\_\_\_  
 SCORER \_\_\_\_\_  
 DATE \_\_\_\_\_  
 TEE TIME \_\_\_\_\_

HOLE	1	2	3	4	5	6	7	8	9	OUT
WHITE TEES	353	150	268	538	334	355	480	401	150	<b>3029</b>
BLUE TEES									210	<b>3089</b>
WHITE AND BLUE PAR	4	3	4	5	4	4	5	4	3	<b>36</b>
HANDICAP	12	18	14	4	16	8	2	6	10	
Minutes on each hole	:13	:09	:12	:17	:11	:15	:17	:16	:10	
Cumulative Time	:13	:22	:34	:51	1:02	1:17	1:34	1:50	2:00	
RED TEES	281	150	243	484	292	300	457	320	105	<b>2632</b>
RED PAR	4	3	4	5	4	4	5	4	3	<b>36</b>
HANDICAP	13	15	11	1	9	3	7	5	17	

INITIAL	10	11	12	13	14	15	16	17	18	IN	TOTAL	HCP	NET	NET
BLUE TEES	380	181	305	573	352	363	535	418	228	3335	6364		RATED	69.9
											6424			
	4	3	4	5	4	4	5	4	3	36	72		SLOPE	123
	11	17	13	3	15	7	1	5	9					
Minutes on each hole	:13	:09	:12	:17	:11	:15	:17	:16	:10					
Cumulative Time	:13	:22	:34	:51	1:02	1:17	1:34	1:50	2:00					
RED TEES	281	150	243	484	292	300	457	320	105	2632	5264		RATED	68.4
RED PAR	4	3	4	5	4	4	5	4	3	36	72		SLOPE	120
HANDICAP	14	16	12	2	10	4	8	6	18	17				

COME. SEE. CONQUER.



EVERY THURSDAY & FRIDAY  
LIVE AND PRIMETIME



GOLF CHANNEL



fcgov.com/golf



Book your next tee time online.  
Coming Soon



fcgov.com/golf

## U.S.G.A. RULES GOVERN ALL PLAY

### LOCAL RULES

- » Free drop from trees marked by white stakes.
- » Each player must have a set of clubs and bag.
- » Do not drive golf carts on hills and mounds around greens and tees.
- » Replace divots, rake sand traps, repair your ball marks on greens and 2 others.
- » Anyone possessing or playing range balls will lose playing privileges.
- » Playing time for nine holes is 2 hours. Slow play will not be tolerated.
- » The course marshall has full authority.
- » Golfers are legally responsible for damage they cause to private property.
- » Only alcoholic beverages purchased at City Park Nine Golf Course are allowed on City Park Nine Golf Course.

### Out of Bounds

- » All boundary fences.
- » Hole No. 3/12-tee shot left of white stakes.
- » Hole No. 7/16 - ball right of white stakes.
- » Hole No. 9/18-ball right of white stakes.
- » Hole No. 9/18-ball right of ditch.
- » Ditch played as lateral water hazard on following holes: 6/15, 7/16, 8/17 and 9/18.

We are committed to using "Best Management Practices" to maintain the best possible playing conditions while protecting our customers and natural resources. For more information, call the course superintendent at 970.221.6653.

**Doug Perry**      PGA Professional  
**Jim Higgins**     GCSAA Superintendent



City Park Nine Golf Course  
411 South Bryan Avenue  
Fort Collins, Colorado 80521  
970.221.6650  
[fcgov.com/golf](http://fcgov.com/golf)

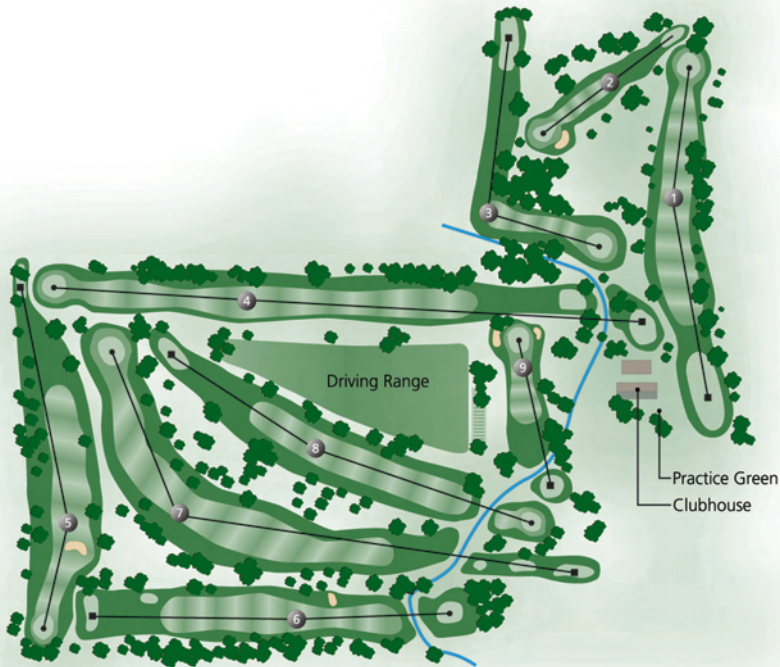

# CITY PARK NINE GOLF COURSE

FORT COLLINS • COLORADO

