

**EXISTING**

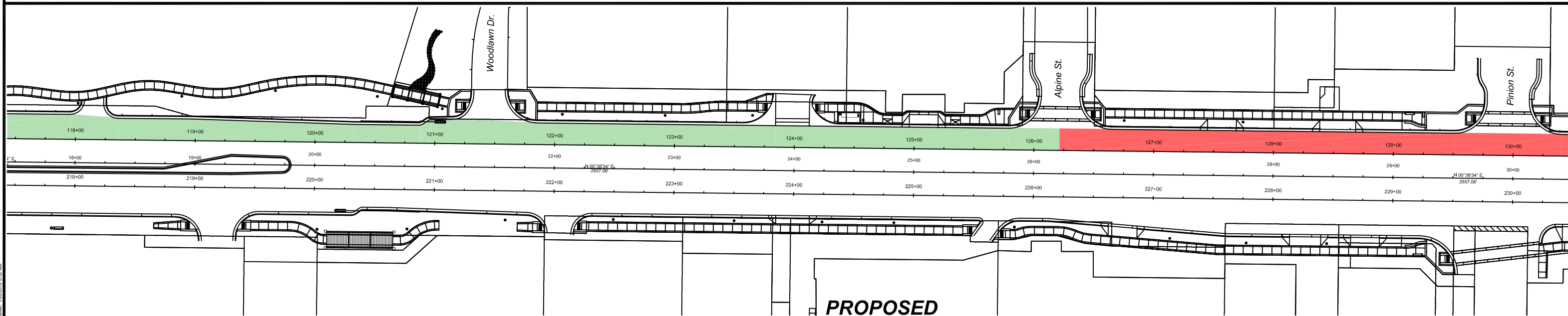
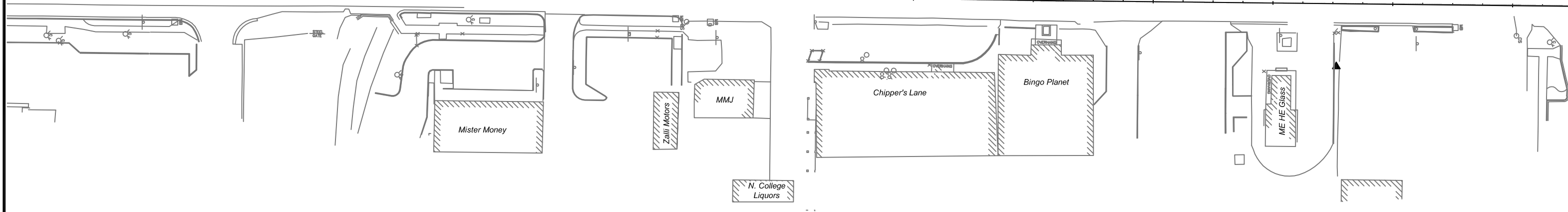
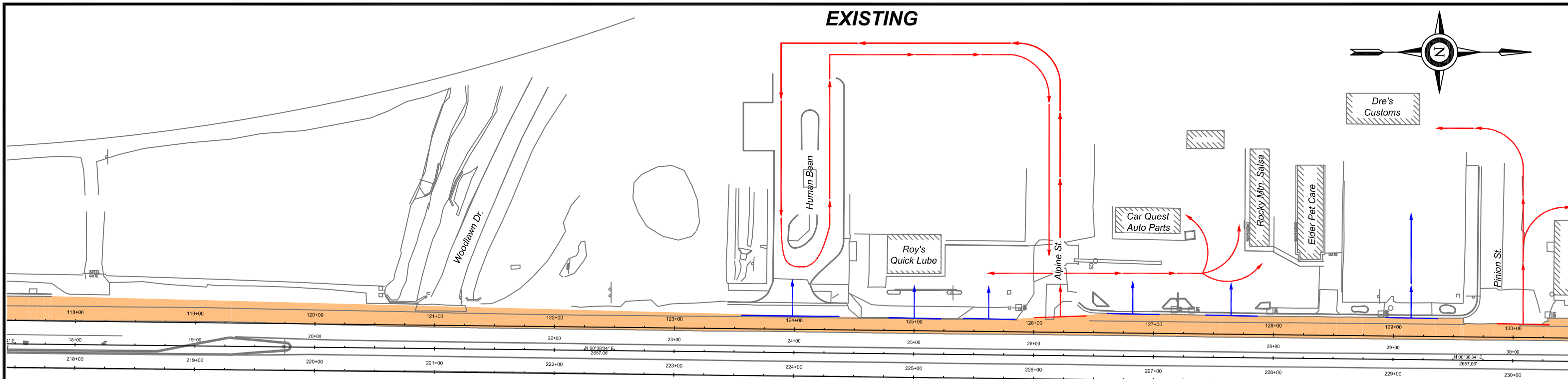
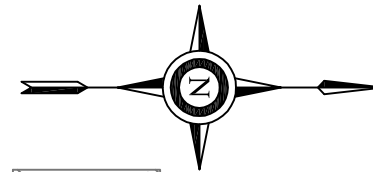

**PROPOSED**

**LEGEND**

- Construction Zone/Lane Closed
- Phase II A
- Phase II B
- Primary Access
- Construction Access

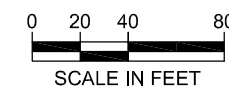

**CONNELL RESOURCES, INC.**  
 7785 Highland Meadows Parkway, Suite 100  
 Fort Collins, Co 80528  
 PHONE: 970-223-3151 FAX: 970-223-3191

Project:	<b>North College Avenue</b>	
Date:	<b>January 16, 2012</b>	
Sheet Number:	<b>1</b>	Number of Sheets:
		<b>2</b>

File: \\con03\067\autocad\cad\_curren\m\john\north\_college\view\_to\_construction\collage\detours\exh2a\_dwg Plotted By: Lisa Kelly, 1/20/2012 8:34 AM  
 File Created: 1/18/2012 10:36 AM, File Last Saved: 1/20/2012 8:07 AM

