

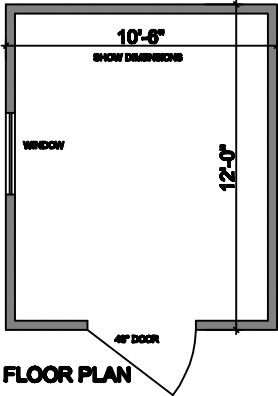

RESIDENTIAL DETACHED SHED HANDOUT REVISED 7/8/07

A PERMIT IS REQUIRED FOR SHEDS THAT ARE HIGHER THAN 8FT AT THE ROOF PEAK AND/OR HAVE A FLOOR AREA LARGER THAN 120 SQUARE FEET AND/OR LOCATED LESS THAN 3 FEET FROM PROPERTY LINE.



FLOOR PLAN

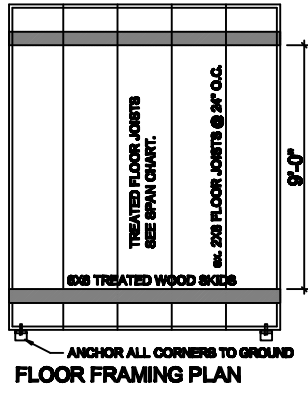

FLOOR FRAMING PLAN

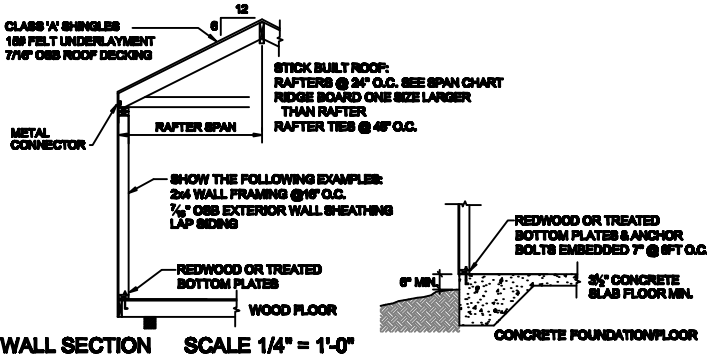

WALL SECTION SCALE 1/4" = 1'-0"

MAXIMUM RAFTER SPAN CHART

	12" O.C.	16" O.C.	24" O.C.
2x4	8'-0"	7'-3"	6'-4"
2x6	12'-7"	11'-5"	9'-7"
2x8	16'-7"	14'-11"	12'-2"
2x10	21'-0"	18'-2"	14'-10"
2x12	24'-4"	21'-1"	17'-3"

2003 IRC table R802.5.1(5), hem fir #2

MAXIMUM JOIST SPAN CHART

	12" O.C.	16" O.C.	24" O.C.
2x6	10'-0"	9'-1"	7'-11"
2x8	13'-2"	12'-0"	10'-2"
2x10	16'-10"	15'-2"	12'-5"
2x12	20'-4"	17'-7"	14'-4"

2003 IRC table R502.3.1(2), hem fir #2

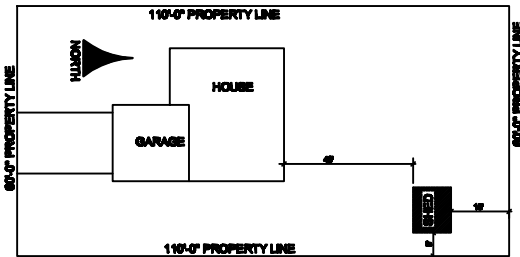

SAMPLE SITE PLAN SCALE 1"=20'

Submittal Requirements for sheds

- Two sets of plans of the proposed shed. See the front page as an example of the plans you will need to submit. The plans do not have to be professionally drawn, nor computer generated, but must be neat, clean and legible.
- Two sets of site plans, drawn to scale, on paper no bigger than 8 1/2" x 14", see example above.
- Completed two-part application form, available with other Building Services handouts at 281 N. College Ave or on the website www.fcgov.com. The legal information requested on the application must be completed in full.
- Completed Homeowner's Affidavit, if applicable (for homeowners doing the construction). The form is available at Building Services, 281 N. College Ave.

Required Inspections:

Final inspection