

Fort Collins Neighborhood & Building Services

281 N. College Ave., P.O. Box 580; Fort Collins, CO 80522-0580; Voice: 970 221 6760

FAX: 970 224 6134

RESIDENTIAL PATIO COVER HANDOUT - 2003 IRC

REVISED 6/12/06



PLAN VIEW / FRAMING PLAN

PATIO COVER SPAN CHARTS BASED ON IRC TABLE R802.5.1(5), 30PSF LIVE, 10PSF DEAD, HEM-FIR #2

		RAFTER SIZE-CHART #1			
		2x6	2x8	2x10	2x12
RAFTER SPAN IN FEET	6'	24" ON CENTER SPACING			
	7'	24"	24"	24"	24"
	8'	24"	24"	24"	24"
	9'	24"	24"	24"	24"
	10'	16"	24"	24"	24"
	11'	16"	24"	24"	24"
	12'	12"	24"	24"	24"
	13'		16"	24"	24"
	14'		16"	24"	24"
	15'		12"	16"	24"
	16'		12"	16"	24"
	17'			16"	24"
	18'			16"	16"
19'			12"	16"	
20'			12"	16"	

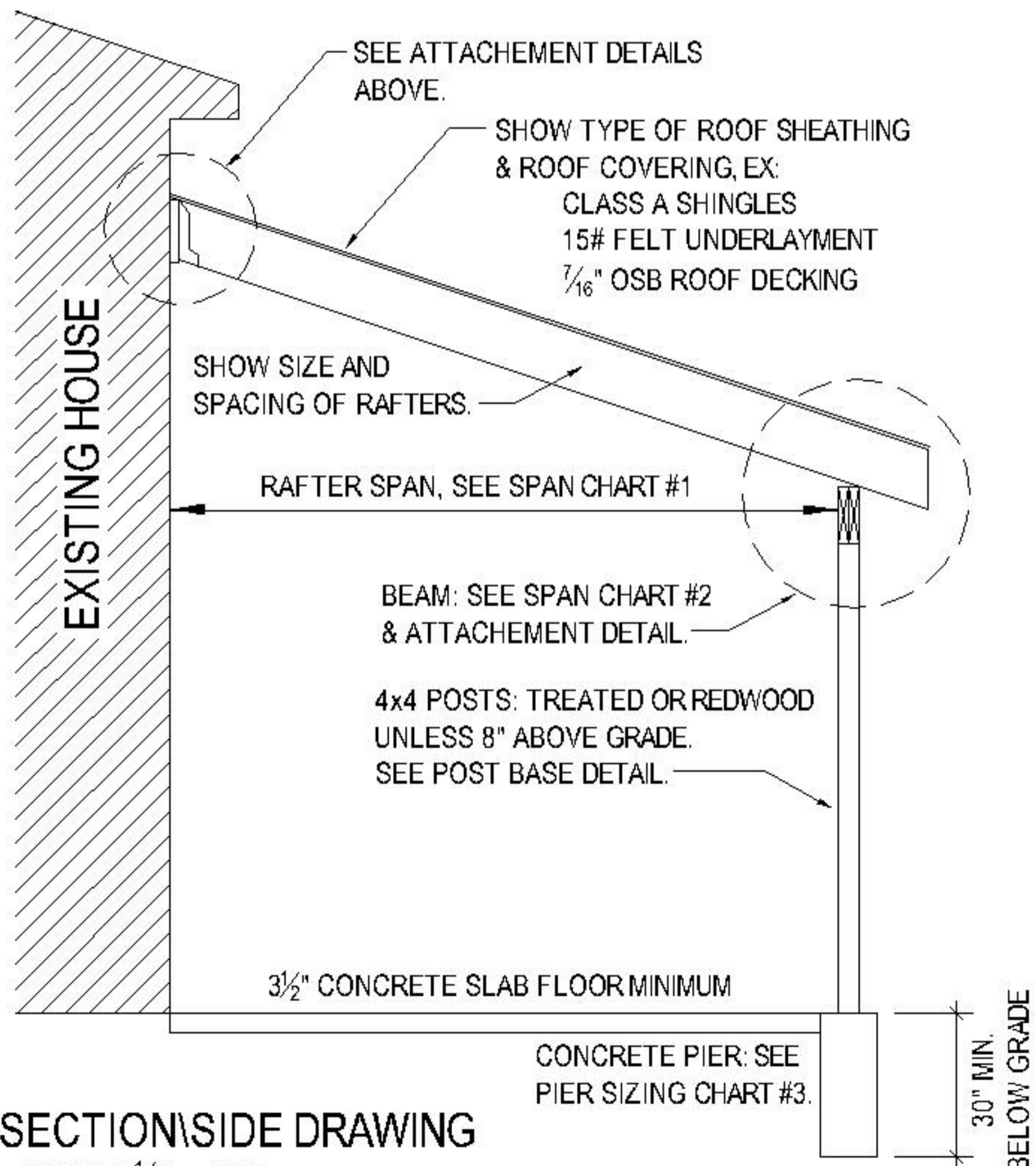

SECTION/SIDE DRAWING

SCALE: 1/4" = 1'-0"

		BEAM SPAN IN FEET-CHART #2			
		6'	8'	10'	12'
RAFTER SPAN IN FEET	8'	2-2x6	2-2x8	2-2X10	2-2X12
	9'	2-2x6	2-2x8	2-2X10	2-2X12
	10'	2-2x6	2-2x8	2-2X10	2-2X12
	11'	2-2x6	2-2x8	2-2X10	2-2X12
	12'	2-2x8	2-2X10	2-2X12	2-2X12
	13'	2-2x8	2-2X10	2-2X12	3-2X12
	14'	2-2x8	2-2X10	2-2X12	3-2X12
	15'	2-2x8	2-2X10	2-2X12	3-2X12
	16'	2-2x8	2-2X10	2-2X12	3-2X12
	17'	2-2x8	2-2X10	2-2X12	3-2X12
18'	2-2x8	2-2X10	2-2X12	3-2X12	

		30" DEEP CONCRETE PIER SIZING-CHART #3			
		BEAM SPAN			
		6'	8'	10'	12'
RAFTER SPAN IN FEET	8'	8"	10"	10"	10"
	9'	8"	10"	10"	10"
	10'	10" DIAMETER PIER			
	11'	10" DIAMETER PIER			
	12'	10"	10"	10"	12"
	13'	10"	10"	10"	12"
	14'	10"	10"	12"	12"
	15'	10"	10"	12"	12"
	16'	10"	10"	12"	12"
	17'	10"	12"	12"	12"
18'	10"	12"	12"	12"	

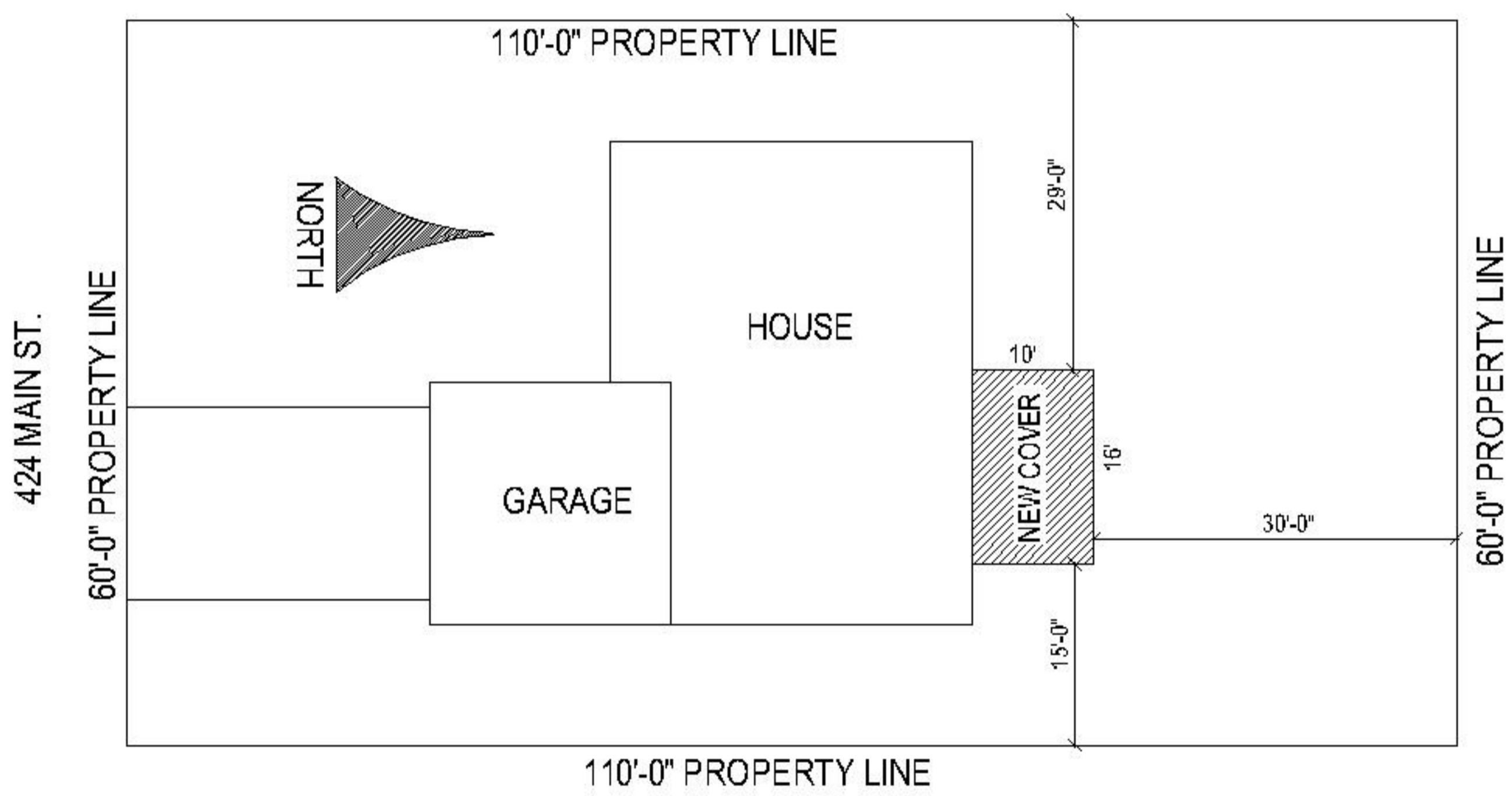
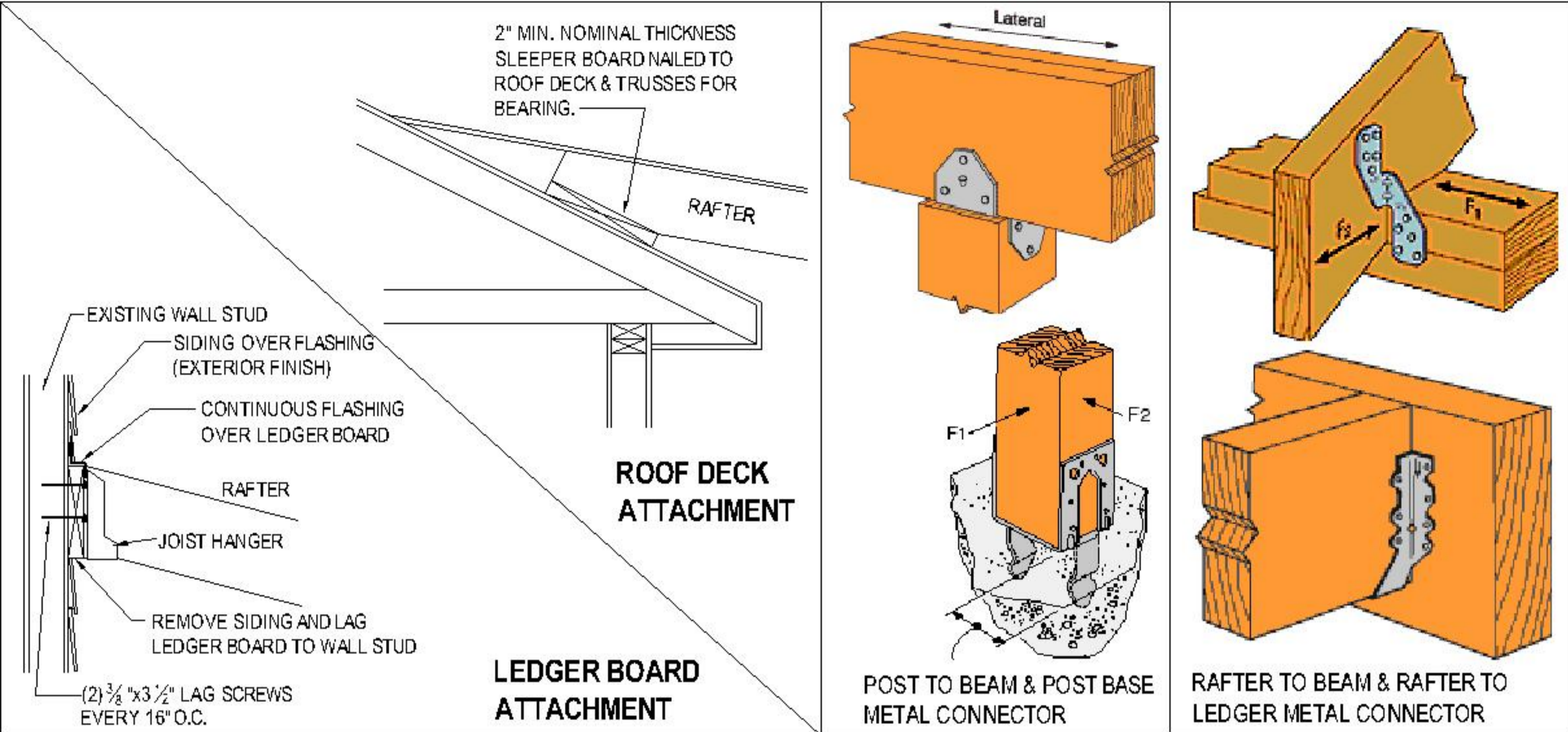

SAMPLE SITE PLAN SCALE 1"=20'

Submittal Requirements for Patio Covers:

1. Two sets of plans of the proposed patio cover. See the front page as an example of the plans you will need to submit. Engineering is required for buildings projects with structural spans beyond the charts shown, the remainder of the plans *do not* have to be professionally drawn, nor computer generated, but must be neat, clean and legible.
2. Two sets of site plans, drawn to scale, on paper no bigger than 8 1/2" x 14", see example above.
3. Completed application form, available with other Building and Zoning handouts at 281 N. College Ave or on the website www.fcgov.com *The legal information requested on the application must be completed in full.*
4. Completed Homeowner's Affidavit, if applicable (for homeowners doing the construction). The form is available at Building and Zoning, 281 N. College Ave.

Required inspections: Pier hole inspection, rough frame inspection, final inspection.