

RESIDENTIAL DECK CONSTRUCTION HANDOUT-2003 IRC

REVISED 8/12/08

PERMITS ARE REQUIRED FOR DECKS WHENEVER THEY ARE MORE THEN 30" ABOVE THE GROUND AT ANY POINT. UNLESS THE DECK IS SELF-SUPPORTING OR BEARING DIRECTLY ON A WALL OR FOUNDATION, THE FOLLOWING METHOD OF ATTACHMENT IS AN APPROVED ALTERNATIVE.

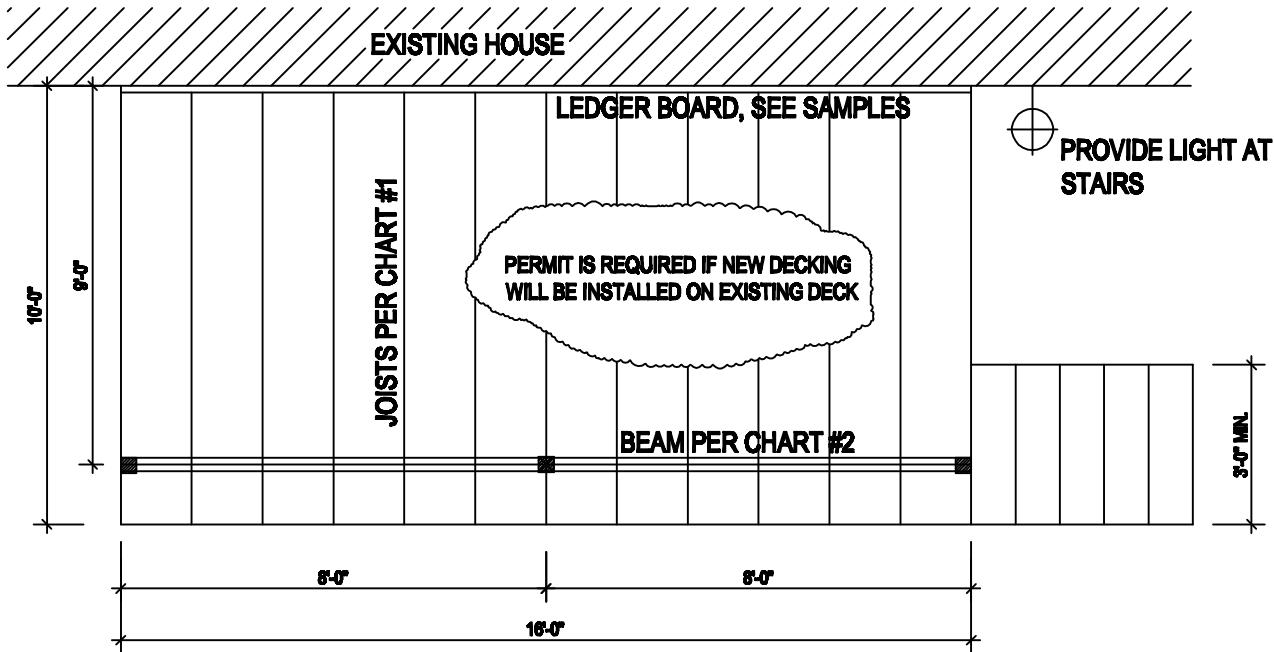

PLAN VIEW / FRAMING PLAN

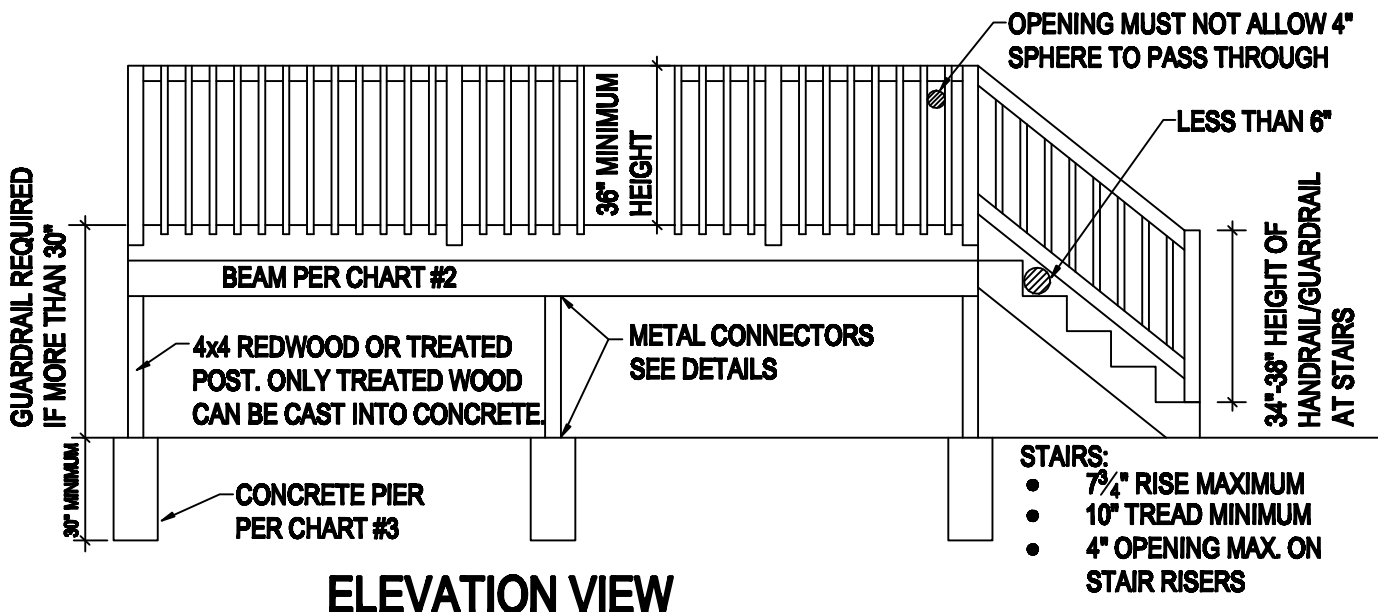

ELEVATION VIEW

ACQ TYPE TREATED LUMBER
REQUIRES ZMAX, STAINLESS,
OR HOT DIPPED FASTENERS
AND CONNECTORS.

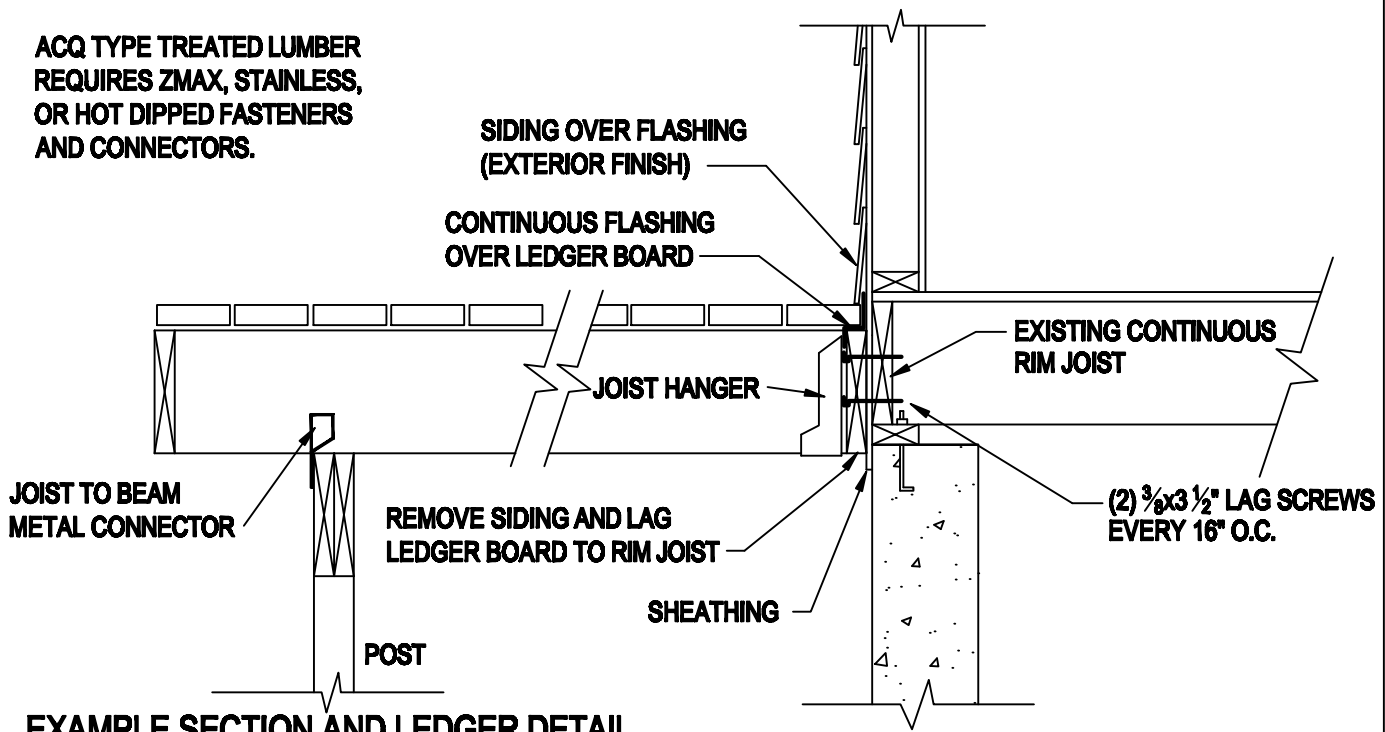

EXAMPLE SECTION AND LEDGER DETAIL

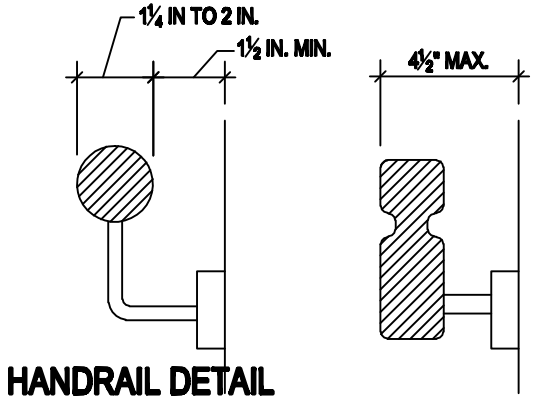

HANDRAIL DETAIL

30" DEEP CONC PIER-CHART #3					
BEAM SPAN					
	6'	8'	10'	12'	
JOIST SPAN IN FEET	8'	10" DIAMETER PIER			
	9'	10"	10"	10"	12"
	10'	10"	10"	12"	12"
	11'	10"	10"	12"	16"
	12'	10"	10"	12"	16"
	13'	10"	12"	16"	16"
	14'	10"	12"	16"	18"
	15'	10"	12"	16"	18"
	16'	10"	16"	16"	20"

JOIST SPAN CHARTS (hem fir #2)				
	12" O.C.	16" O.C.	19.2" O.C.	24" O.C.
2x6	10'-0"	9'-1"	8'-7"	7'-11"
2x8	13'-2"	12'-0"	11'-3"	10'-2"
2x10	16'-10"	15'-2"	13'-10"	12'-5"
2x12	20'-4"	17'-7"	16'-1"	14'-4"

BEAM SPAN IN FEET-CHART #2					
	6'	8'	10'	12'	
JOIST SPAN IN FEET	8'	2-2x6	2-2x8	2-2X10	2-2X12
	9'	2-2x6	2-2x8	2-2X10	2-2X12
	10'	2-2x6	2-2x8	2-2X10	2-2X12
	11'	2-2x6	2-2x8	2-2X10	2-2X12
	12'	2-2x8	2-2X10	2-2X12	2-2X12
	13'	2-2x8	2-2X10	2-2X12	3-2X12
	14'	2-2x8	2-2X10	2-2X12	3-2X12
	15'	2-2x8	2-2X10	2-2X12	3-2X12
	16'	2-2x8	2-2X10	2-2X12	3-2X12
	17'	2-2x8	2-2X10	2-2X12	3-2X12
	18'	2-2x8	2-2X10	2-2X12	3-2X12

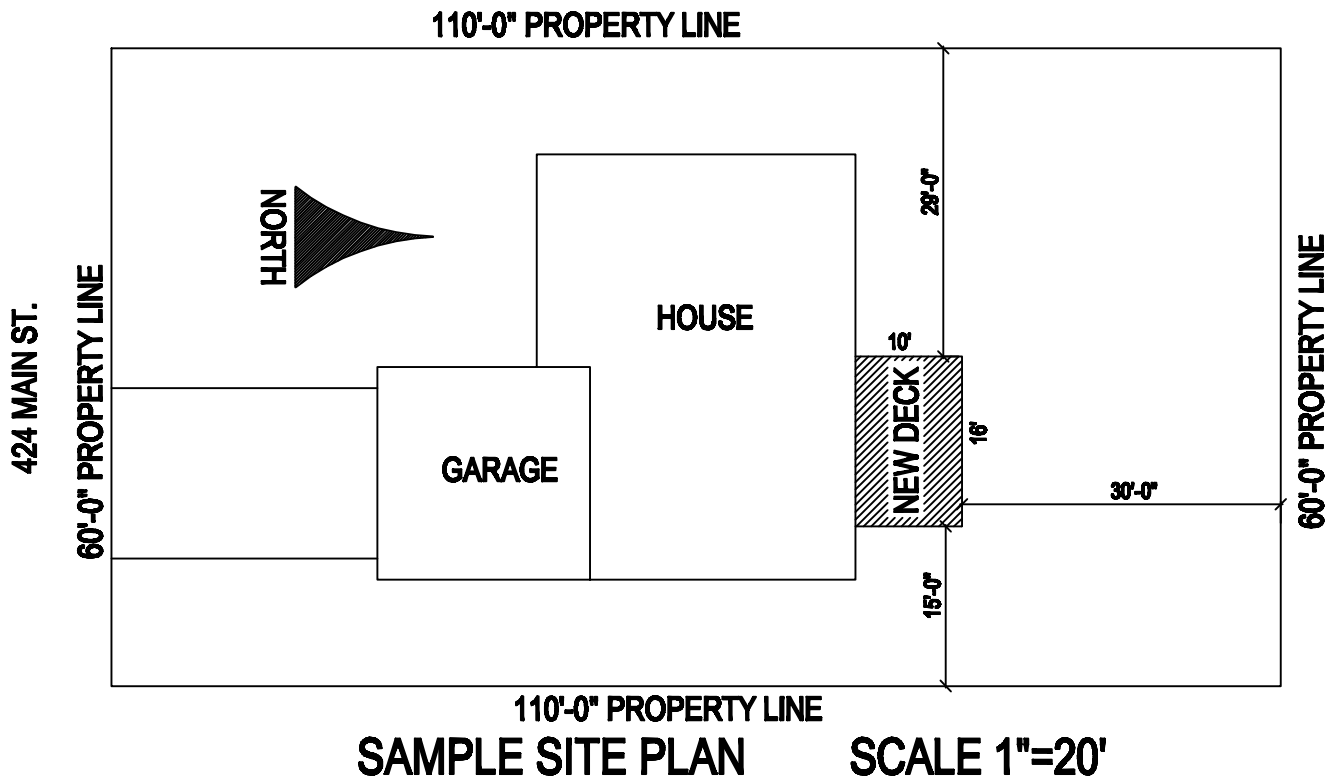

Submittal Requirements for decks

1. Two sets of plans of the proposed deck. See the front page as an example of the plans you will need to submit. The plans *do not* have to be professionally drawn, nor computer generated, but must be neat, clean and legible.

2. Two sets of site plans, drawn to scale, on paper no bigger than 8 ½" x 14", see example above.

3. Completed two-part application form, available with other Building Services handouts at 281 N. College Ave or on the website www.fcgov.com *The legal information requested on the application must be completed in full.*

4. Completed Homeowner's Affidavit, if applicable (for homeowners doing the construction). The form is available at Building Services, 281 N. College Ave.

Required inspections:

1. Pier hole inspection
2. Final inspection