

PEDESTRIAN PAVER PROJECT MAP

CITY OF FORT COLLINS ART IN PUBLIC PLACES PROGRAM

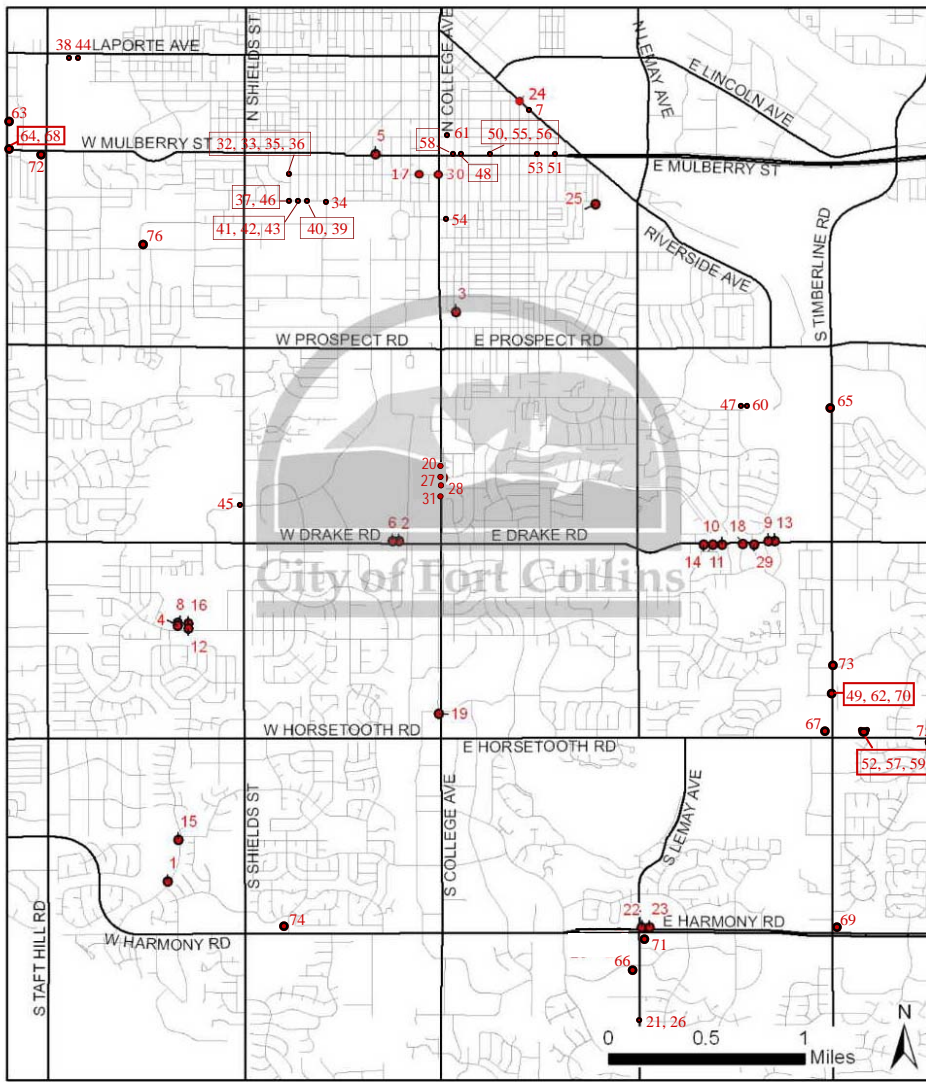

PROGRAM OVERVIEW

The City of Fort Collins Art in Public Places Program was created in April, 1995. APP is intended to encourage and enhance artistic expression and art appreciation, while adding value to the Fort Collins community through acquiring, exhibiting, and maintaining public art.

To find out more about public art in Fort Collins visit

www.fcgov.com/artspublic.

Since its inception, APP has commissioned over 50 public art projects in Fort Collins, with many more on the way!

In addition to these projects, APP has collaborated with the City's Engineering Department and selected many works of art by local youth for the Pedestrian Paver Project. The City's Engineering Department works to provide safe pedestrian access by creating new pedestrian routes as well as improving existing areas.

Selected designs by local youth are sandblasted into granite pavers and placed in sidewalks around the city. The theme for the artwork is transportation or life in Fort Collins. Many public art sites are located along pedestrian trails and parks. Explore our beautiful environment while using this map to discover the wonderful work of public art in Fort Collins.



1 Alan Herberger, 2003
4201 Seneca St.



2 Rohan Goel, 2003
300 W. Drake Rd.

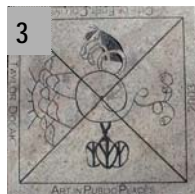

3 Taylor Dolak, 2003
1400 S. Remington



4 Molly Martell, 2003
1300 W. Swallow Rd.



5 Karly Franz, 2003
400 W. Mulberry St.



6 Sukhmani Ghuman, 2003
300 W. Drake



7 Joelle Goodwin, 2004
Riverside & Oak



8 Lucy Burghardt, 2004
1300 W. Swallow Rd.



9 Antoinette Syracuse, 2004
Drake between Parklake Dr. & Parklake Ct.



10 Jessica Gardner, 2004
Drake between Brookwood & Silver Creek



11 Sara Bashford, 2004
Drake between Brookwood & Silver Creek



12 Cynthia Hansen, 2004
1300 W. Swallow Rd.

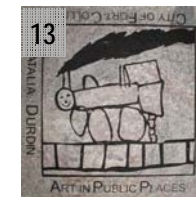

13 Natalia Durdin, 2004
Drake between Parklake Dr. & Parklake Ct.



14 Clifton Manahan, 2004
Drake between Brookwood & Silver Creek



15 Sarah Critchfield, 2004
4104 Seneca St.



16 Kimberly Walter, 2004
1300 W. Swallow Rd.



17 Kyle Anderson, 2005
Southeast Corner of Laurel & Mason



18 Candace Braden, 2005
Southside of Silvercreek & Parklake Drive



19 Justin Geist, 2005
Southwest Corner of College & Monroe



20 Dana Hood, 2005
Northeast Corner of College & Columbia



21 Mia Huang, 2005
Northside of Boardwalk & Lemay



22
Skylar Jordan, 2005
Northeast Corner of
Harmony & Lemay



23
Megan Lindsay, 2005
Northeast Corner of
Harmony & Lemay



24
Kyle Napelbaum, 2005
Riverside & Oak

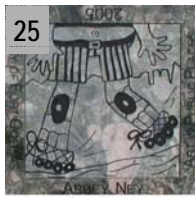

25
Abbey Ney, 2005
Laurel & eastside
Neighborhood Park



26
Steven Stutzman, 2005
Northside of Lemay &
Boardwalk

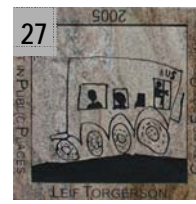

27
Leif Torgerson, 2005
Northeast Corner of
College & Columbia



28
Amelia Morgan, 2005
Southeast Corner of
College & Columbia



29
Sarah Bashford, 2005
Southside of Silvercreek
& Parklake Drive



30
Rohan Goel, 2005
Southwest Corner of
College & Laurel



31
Rachel Christen, 2005
Southeast Corner of
College & Columbia



32
Kate Marx, 2006
600 S. Washington



33
Audrey Wojtowick, 2006
Northwest Corner of
Washington & Myrtle



34
Sara Canetto, 2006
Laurel & Sherwood at South
Side of Rockwell Hall



35
Cate Rush, 2006
Northeast Corner of
Washington & Myrtle



36
Sarah McFadden, 2006
618 S. Washington



37
Jason Fetters, 2006
Northeast Corner of Laurel
& Washington



38
Amy Weintraub, 2006
West LaPorte at Cemetery

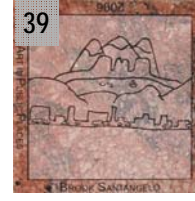

39
Brook Santangelo, 2006
600 Block of West Laurel
on South Side



40
Amanda Kriss, 2006
Southeast Corner of Laurel
& Loomis



41
Paul Mill, 2006
South Side at Laurel & Grant

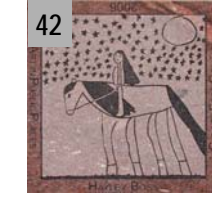

42
Haley Boss, 2006
728 West Laurel



43
Tiana Martinez, 2006
700 Block of West Laurel
on South Side

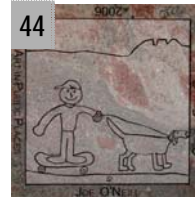

44
Joe O'Neill, 2006
West LaPorte at Cemetery



45
Meleena O'Neill, 2006
Southwest Corner of Shields
& Raintree

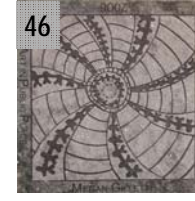

46
Megan Gillette, 2006
South Side at Laurel
& Washington



47
Shelby Rios, 2007
Southeast Corner of
Stuart & Creekwood



48
Aubrey Leonard, 2007
Southwest Corner of
Mathews & Mulberry



49
Grant Bergslien, 2007
Near East Driveway to
Fort Collins High School



50
Olivia Brett, 2007
Southwest Corner of
Mulberry & Whedbee



51
Olivia Zoch, 2007
Southeast Corner of
Mulberry & Stover

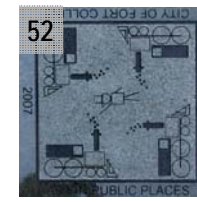

52
Aaron Zoch, 2007
Southwest Corner of
Horsetooth & Arctic Fox



53
Austin Sullivan, 2007
Northwest Corner of
Mulberry & Smith



54
Lauren Smailes, 2007
Southeast Corner of
Remington & Plum



55
Sean Midland, 2007
Southeast Corner of
Mulberry & Whedbee



56
Cynthia Musante, 2007
Northwest Corner of
Mulberry & Whedbee



57
Kylee Clark, 2007
Southeast Corner of
Horsetooth & Arctic Fox



58
Kali Reynolds, 2007
Southeast Corner of
Remington & Mulberry



59
Brady Fitzgerald, 2007
Northwest Corner of
Horsetooth and Arctic
Fox Dr.



60
Cayley Allesandria
Chiodo, 2007
Southwest Corner of Stuart
& Creekwood



61
Sarah Braley, 2007
Southeast Corner of
Remington & Olive



62
Taylor Caminada, 2008
Southeast corner of South
Timberline and Lambkin
Way



63
Mutiara Carney, 2008
Southeast corner of
Impala Dr. and Impala
Circle near Poudre H.S.



Kylie Chandler, 2008
Southeast corner of West
Mulberry Street and
Ponderosa Drive



Robert Christensen, 2008
2001 South Timberline Road



McKayla Earley, 2008
50 ft. South of Southwest
corner of South Lemay

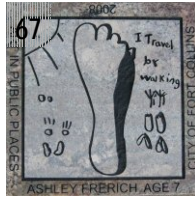

Ashley Frerich, 2008
Northwest corner of
Timberline and Horsetooth



Christopher Heitzman,
2008
2300 West Mulberry



Pairoh Kokyai, 2008
Northeast corner of
Timberline and Harmony



Jaimie Linnane, 2008
Southwest corner of
South Timberline Rd.
and Danfield Ct.



Ryan Long, 2008
200 ft. South of the
Southeast corner of
Harmony and Lemay



Julia Lyons, 2008
Southwest corner of
Mulberry St. and Taft Hill
Road



Margaret Mouat, 2008
400 ft. North of Vermont
Dr. in sidewalk on East
side of South Timberline



Alia Norris, 2008
Northwest corner of
Starflower Dr. and West
Harmony Rd.



Melody Sutherland, 2008
Southwest corner of
Horsetooth and Ashmount Dr.



Tarah Vijayasathary,
2008. Northeast corner
of Constitution Ave. and
West Elizabeth St.



www.fcgov.com/artspublic